

## 广东万连科技有限公司

Guangdong Wanlian Technology Co., Ltd

☎ 400-888-3128

🌐 www.dzgu.com

✉ service@dzgu.com

📍 东莞市长安镇沙头西兴街6号  
No. 6 Shatou Xixing Street, Chang'an  
Town, Dongguan City, Guangdong Province



扫码进入官网

CONNECTOR PRODUCT  
SELECTION MANUAL

**连接器产品选型**

# 公司简介 >>

## COMPANY PROFILE

DZGU(广东万连科技有限公司)作为业界领先的连接方案提供商,致力于为中国制造业发展提供广泛适用性的连接器产品与技术导向型的定制化服务。

DZGU(Guangdong Wanlian Technology Co., Ltd.,) as a leading provider of connection solutions in the industry, is committed to providing services for the development of China's manufacturing industry provides widely applicable connector products and technology oriented customized services to create value .

经过16年的技术沉淀,万连科技已获得多项技术认证、国家高新技术企业认证及超150项专利认证,拥有专业的行业实验室以及完整高效的连接器产线,提供从研发、测试到生产的一站式配套服务。

After 16 years of technological precipitation, Wanlian Technology has obtained multiple technical certifications, national high-tech enterprise certifications, and over 150 patent certifications, and has professional industry laboratories And a complete and efficient connector production line. Provide one-stop supporting services from research and development, testing to production.

坚持不断追求技术创新,依托超100+工程师团队,实现覆盖消费电子、工业工控、汽车、新能源等多领域,可根据客户的各种个性化需求,快速提供解决方案,满足客户多元化场景连接需求。

Adhering to the continuous pursuit of technological innovation, relying on a team of over 100 engineers, we have achieved coverage in various fields such as consumer electronics, industrial control, automobiles, new energy, etc. We can meet the needs of various customers Personalized requirements, quickly providing solutions to meet customers' diverse scene connection needs.

未来,我们期待成为最具客户信赖的连接解决方案服务平台,让连接创造价值!

In the future, we look forward to becoming the most trusted connection solution service platform for customers, allowing connections to create value!



**企业愿景**  
成为最具客户信赖的连接方案服务平台



**企业使命**  
在研发阶段,提供丰富的多场景连接解决方案和小批量快交期样品服务;  
在量产阶段,确保产品高性价比、品质一致性和持续供应;  
从而大幅提升连接方案设计到交付效率,并综合性降低连接成本。



**企业理念**  
以人为根本,追求员工的成长发展和相互信赖  
书面沟通,协同一致,说到做到,做不到及时汇报



# 企业认证 >>

## ENTERPRISE CERTIFICATION



# 生产车间 >>

WORKSHOP STORAGE



# 生产车间 >>

WORKSHOP STORAGE



## 检测设备 >>

TEST EQUIPMENT



## 仓储实力 >>

WAREHOUSE STRENGTH



2020年万连科技新建智能物料仓储中心,实现自动化仓储、自动化分拣快速配送,仓储面积5000多平方米。

In 2020, Wanlian Technology built an intelligent material storage center, achieving automated warehousing, automated sorting, and fast delivery, with a storage area of over 5000 square meters.



万连料号与原厂料号对照索引			
万连系列	间距	原厂	原厂系列
A1002	1.00mm	JST	SH
A1006	1.00mm	JST	SHL
A1009	1.00mm	JST	NHB
A1010	1.00mm	JST	NSH 1.0
A1201	1.20mm	MX	78171
A1251	1.25mm	MX	53398
A1254	1.25mm	MX	53780
A1255	1.25mm	yeonho	12507
A1257	1.25mm	JST	GH
A1259	1.25mm	JST	GHD
A1501	1.50mm	JST	ZH
A1502	1.50mm	MX	87437
A1504	1.50mm	JST	ZE
A1505	1.50mm	MX	504050
A1515	1.50mm	MX	213225
A1521	1.50mm	JST	ZPD
A2001	2.00mm	JST	PH
A2002	2.00mm	JST	PA
A2006	2.00mm	JST	PHD
A2008	2.00mm	JST	HY
A2009	2.00mm	JST	PHB
A2010	2.00mm	AMP	292161
A2019	2.00mm	JST	PND
A2020	2.00mm	JST	PUD
A2023	2.00mm	MX	560020
A2036	2.00mm	MX	501645
A2039	2.00mm	MX	55917
A2040	2.00mm	MX	205338

万连料号与原厂料号对照索引			
万连系列	间距	原厂	原厂系列
A2501	2.50mm	JST	XH
A2502	2.50mm	JST	EH
A2504	2.50mm	JST	NH
A2508	2.50mm	JST	XA
A2509	2.50mm	JST	XHB
A2514	2.50mm	MX	105310、105308、105314
A2547	2.50mm	MX	CD-ROM
A2548	2.50mm	MX	90130
A2549	2.50mm	TE	TE-280370-2
A3503	3.50mm	MX	33012、172256、172258、172299
A3962	3.96mm	JST	VH
A3963	3.96mm	JST	CH
A5704	5.70mm	MX	200456、200241、171692、170001
A7925	7.92mm	HRS	DF22
B1501	1.50mm	JST	SZN
B2001	2.00mm	JST	SAN
B2512&B2513	2.50mm	JST	SCN
C2003	2.00mm	MX	51005
C2004	2.00mm	JST	JWPF
C2521	2.50mm	JST	SM
C3030	3.00mm	MX	43025
C4140	4.14mm	TE	1-770166-0~90-0、1-770743-0、1-770858-0~76-0、1-770971-0、1-794066-0~79-0、1-794180-1、1-794105-0~08-0、5-770170-0
C4201	4.20mm	MX	5557
C6351	6.35mm	MX	42021、42022、42024、42024
D0801	0.80mm	JST	SUR
F1006	1.00mm	HRS	FH12

## 连接器选型系列

Series	Descripton	page
A1002 Series	1.00mm Pitch Wire to Board Connectors	001-005
A1006 Series	1.00mm Pitch Wire to Board Connectors	006-008
A1009 Series	1.00mm Pitch Wire to Board Connectors	009-013
A1010 Series	1.00mm Pitch Wire to Board Connectors	014-016
A1201 Series	1.20mm Pitch Wire to Board Connectors	017-019
A1251 Series	1.25mm Pitch Wire to Board Connectors	020-026
A1254 Series	1.25mm Pitch Wire to Board Connectors	027-029
A1255 Series	1.25mm Pitch Wire to Board Connectors	030-032
A1257 Series	1.25mm Pitch Wire to Board Connectors	033-035
A1259 Series	1.25mm Pitch Wire to Board Connectors	036-038
A1501Series	1.50mm Pitch Wire to Board Connectors	039-046
A1502 Series	1.50mm Pitch Wire to Board Connectors	047-051
A1504 Series	1.50mm Pitch Wire to Board Connectors	052-054
A1505 Series	1.50mm Pitch Wire to Board Connectors	055-057
A1515 Series	1.50mm Pitch Wire to Board Connectors	058-061
A1521 Series	1.50mm Pitch Wire to Board Connectors	062-064
A2001 Series	2.00mm Pitch Wire to Board Connectors	065-071
A2002 Series	2.00mm Pitch Wire to Board Connectors	072-076
A2006 Series	2.00mm Pitch Wire to Board Connectors	077-083
A2008 Series	2.00mm Pitch Wire to Board Connectors	084-090
A2009 Series	2.00mm Pitch Wire to Board Connectors	091-098
A2010 Series	2.00mm Pitch Wire to Board Connectors	099-101
A2019 Series	2.00mm Pitch Wire to Board Connectors	102-104
A2020 Series	2.00mm Pitch Wire to Board Connectors	105-108

## 连接器选型系列

Series	Descripton	page
A2023 Series	2.00mm Pitch Wire to Board Connectors	109-111
A2036 Series	2.00mm Pitch Wire to Board Connectors	112-115
A2039 Series	2.00mm Pitch Wire to Board Connectors	116-119
A2040 Series	2.00mm Pitch Wire to Board Connectors	120-122
A2501 Series	2.50mm Pitch Wire to Board Connectors	123-128
A2502 Series	2.50mm Pitch Wire to Board Connectors	129-131
A2504 Series	2.50mm Pitch Wire to Board Connectors	132-134
A2508 Series	2.50mm Pitch Wire to Board Connectors	135-139
A2509 Series	2.50mm Pitch Wire to Board Connectors	140-144
A2514 Series	2.50mm Pitch Wire to Board Connectors	145-149
A2547 Series	2.54mm Pitch Wire to Board Connectors	150-156
A2548 Series	2.54mm Pitch Wire to Board Connectors	157-160
A2549 Series	2.54mm Pitch Wire to Board Connectors	161-166
A3503 Series	3.50mm Pitch Wire to Board Connectors	167-171
A3962 Series	3.96mm Pitch Wire to Board Connectors	172-177
A3963 Series	3.96mm Pitch Wire to Board Connectors	178-181
A5704 Series	5.70mm Pitch Wire to Board Connectors	182-187
A7925 Series	7.92mm Pitch Wire to Board Connectors	188-190
B1501 Series	1.50mm Pitch Board to Board Connectors	191-193
B2001 Series	2.00mm Pitch Board to Board Connectors	194-196
B2512&B2513 Series	2.50mm Pitch Board to Board Connectors	197-199
C2003 Series	2.00mm Pitch Wire to Wire Connectors	200-202
C2004 Series	2.00mm Pitch Wire to Wire Connectors	203-206
C2521 Series	2.50mm Pitch Wire to Wire Connectors	207-209

## 连接器选型系列

Series	Descripton	page
C3030 Series	3.00mm Pitch Wire to Wire Connectors	210-230
C4140 Series	4.14mm Pitch Wire to Wire Connectors	231-239
C4201 Series	4.20mm Pitch Wire to Wire Connectors	240-254
C6351 Series	6.35mm Pitch Wire to Wire Connectors	255-259
D0801 Series	0.80mm Pitch Pierced Type Connectors	260-264
F0301 Series	0.30mm Pitch FPC/FFC Connectors	265-266
F0303 Series	0.30mm Pitch FPC/FFC Connectors	267-268
F0501Series	0.50mm Pitch FPC/FFC Connectors	269-276
F0502 Series	0.50mm Pitch FPC/FFC Connectors	277-278
F0503 Series	0.50mm Pitch FPC/FFC Connectors	279-280
F0505 Series	0.50mm Pitch FPC/FFC Connectors	281-284
F0506 Series	0.50mm Pitch FPC/FFC Connectors	285-286
F0507 Series	0.50mm Pitch FPC/FFC Connectors	287-288
F0801 Series	0.80mm Pitch FPC/FFC Connectors	289-290
F1001 Series	1.00mm Pitch FPC/FFC Connectors	291-292
F1003 Series	1.00mm Pitch FPC/FFC Connectors	293-296
F1004 Series	1.00mm Pitch FPC/FFC Connectors	297-298
F1005 Series	1.00mm Pitch FPC/FFC Connectors	299-306
F1006 Series	1.00mm Pitch FPC/FFC Connectors	307-308
F1007 Series	1.00mm Pitch FPC/FFC Connectors	309-310
F1008 Series	1.00mm Pitch FPC/FFC Connectors	311-312
F1009 Series	1.00mm Pitch FPC/FFC Connectors	313-314
F1010 Series	1.00mm Pitch FPC/FFC Connectors	315-316
F1011 Series	1.00mm Pitch FPC/FFC Connectors	317-318

## 连接器选型系列

Series	Descripton	page
F1251 Series	1.25mm Pitch FPC/FFC Connectors	319-322
PH1007 Series	1.00mm Pitch Pin Header Connectors	323-324
FH1007 Series	1.00mm Pitch Female Header Connectors	325-326
PH1276 Series	1.27mm Pitch Pin Header Connectors	327-329
FH1276 Series	1.27mm Pitch Female Header Connectors	330-334
PH2005Series	2.00mm Pitch Pin Header Connectors	335-343
FH2005Series	2.00mm Pitch Female Header Connectors	344-348
PH2541 Series	2.54mm Pitch Pin Header Connectors	349-356
FH2541 Series	2.54mm Pitch Female Header Connectors	357-360
PH3961 Series	3.96mm Pitch Pin Header Connectors	361-362
PH4201 Series	4.20mm Pitch Pin Header Connectors	363-363
PH5081 Series	5.08mm Pitch Pin Header Connectors	364-364
FH5081 Serie	5.08mm Pitch Female Header Connectors	365-365
BH2075 Series	2.00mm Pitch Box Header Connectors	366-367
EJ2075 Series	2.00mm Pitch Ejector Header Connectors	368-369
D2075 Series	2.00mm Pitch IDC Connectors	370-370
BH2553 Series	2.50mm Pitch Box Header Connectors	371-372
EJ2553 Series	2.50mm Pitch Ejector Header Connectors	373-374
D2553 Series	2.50mm Pitch IDC Connectors	375-375

# 产品系列 >>

PRODUCT LINE

A1002 Series 001-005

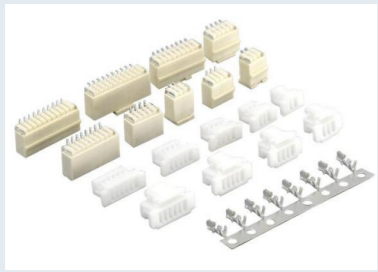

A1006 Series 006-008



A1009 Series 009-013

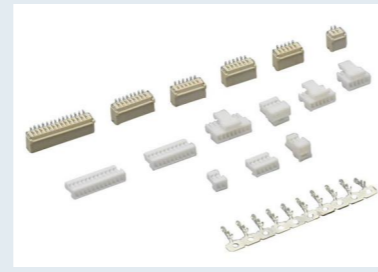

A1010 Series 014-016

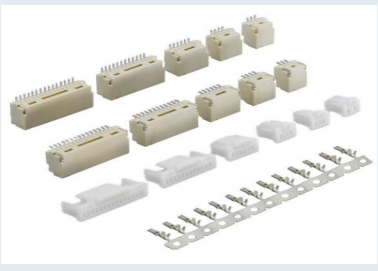

A1201 Series 017-019



A1251 Series 020-026

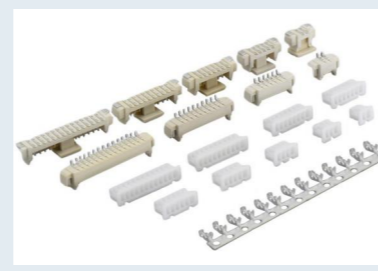

A1254 Series 027-029

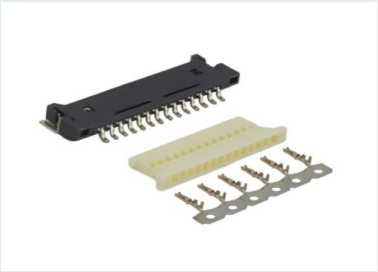

A1255 Series 030-032

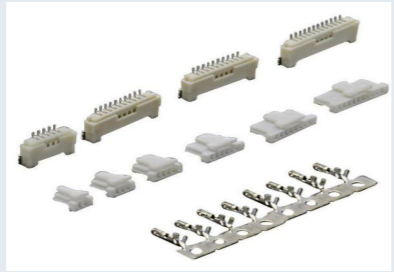

A1257 Series 033-035

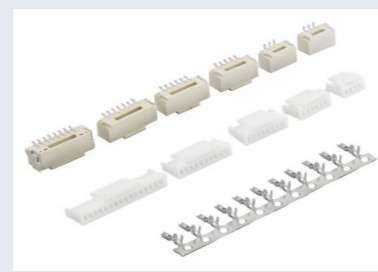

A1259 Series 036-038



A1501 Series 039-046

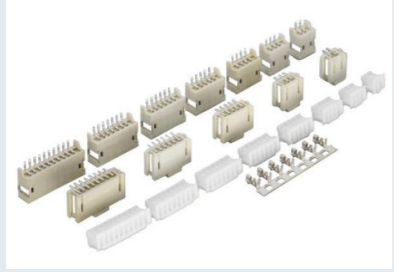

A1502 Series 047-051

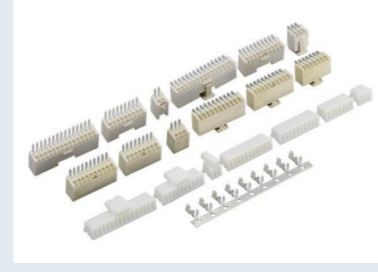

A1504 Series 052-054

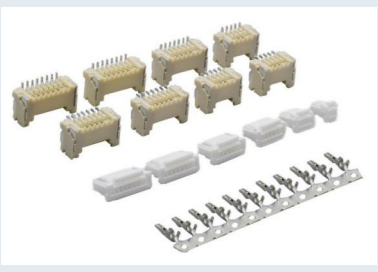

A1505 Series 055-057



A1515 Series 058-061



# 产品系列 >>

PRODUCT LINE

A1521 Series 062-064

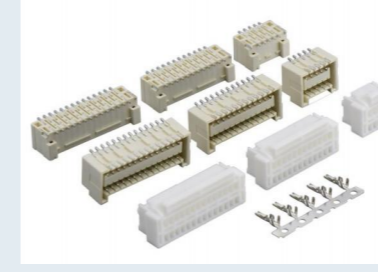

A2001 Series 065-071

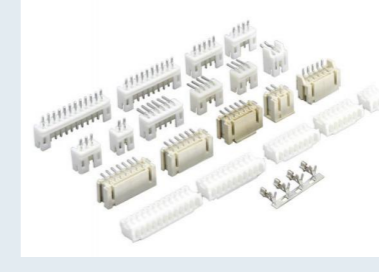

A2002 Series 072-076

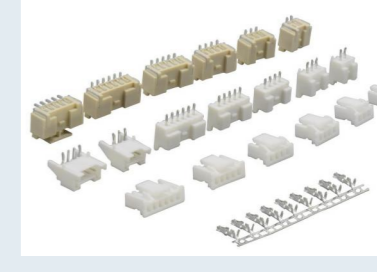

A2006 Series 077-083

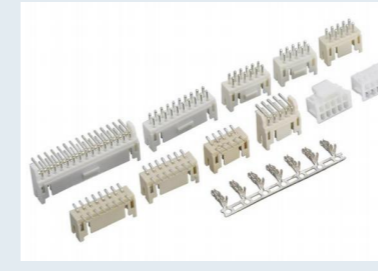

A2008 Series 084-090

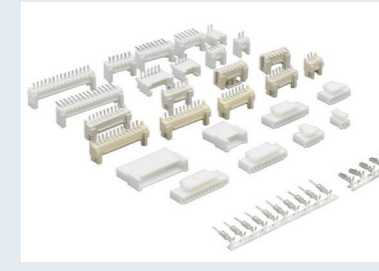

A2009 Series 091-098

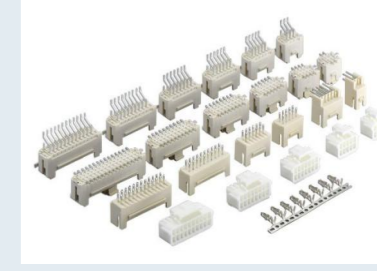

A2010 Series 099-101



A2019 Series 102-104

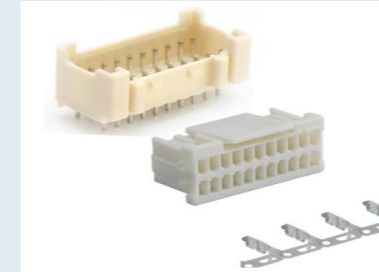

A2020 Series 105-108



A2023 Series 109-111

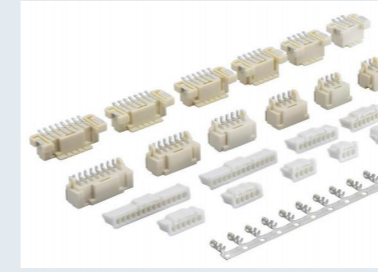

A2036 Series 112-115

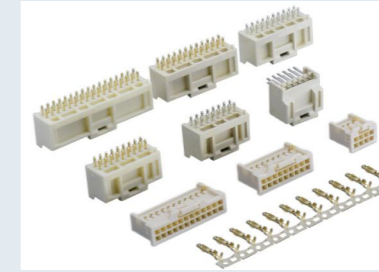

A2039 Series 116-119

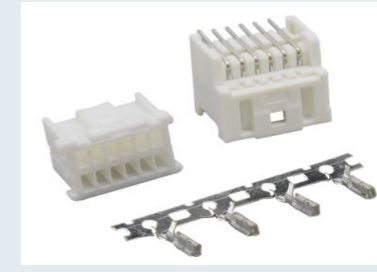

A2040 Series 120-122

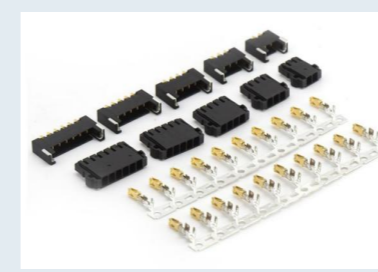

A2501 Series 123-128

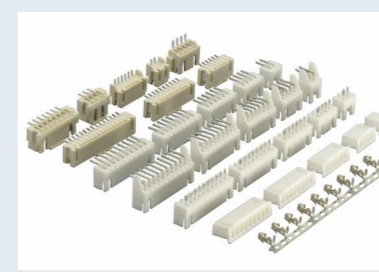

A2502 Series 129-131

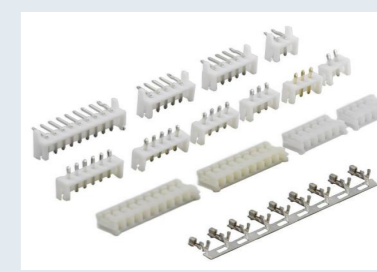



# 产品系列 >>

PRODUCT LINE

A2504 Series 132-134	A2508 Series 135-139	A2509 Series 140-144
A2514 Series 145-149	A2547 Series 150-156	A2548 Series 157-160
A2549 Series 161-166	A3503 Series 167-171	A3962 Series 172-177
A3963 Series 178-181	A5704 Series 182-187	A7925 Series 188-190
B1501 Series 191-193	B2001 Series 194-196	B2512&B2513 Series 197-199

# 产品系列 >>

PRODUCT LINE

C2003 Series 200-202	C2004 Series 203-206	C2521 Series 207-209
C3030 Series 210-230	C4140 Series 231-239	C4201 Series 240-254
C6351 Series 255-259	D0801 Series 260-264	F0301 Series 265-266
F0303 Series 267-268	F0501 Series 269-276	F0502 Series 277-278
F0503 Series 279-280	F0505 Series 281-284	F0506 Series 285-286

# 产品系列 >>

PRODUCT LINE

F0507 Series 287-288	F0801 Series 289-290	F1001 Series 291-292
F1003 Series 293-296	F1004 Series 297-298	F1005 Series 299-306
F1006 Series 307-308	F1007 Series 309-310	F1008 Series 311-312
F1009 Series 313-314	F1010 Series 315-316	F1011 Series 317-318
F1251 Series 319-322	PH1007 Series 323-324	FH1007Series 325-326

# 产品系列 >>

PRODUCT LINE

PH1276 Series 327-329	FH1276 Series 330-334	PH2005 Series 335-343
FH2005 Series 344-348	PH2541 Series 349-356	FH2541 Series 357-360
PH3961 Series 361-362	PH4201 Series 363-363	PH5081&FH5081Series 364-365
BH2075 Series 366-367	EJ2075Series 368-369	D2075 Series 370-370
BH2553Series 371-372	EJ2553 Series 373-374	D2553 Series 375-375

**A1002TFX-X**

Pitch 1.00mm Terminal

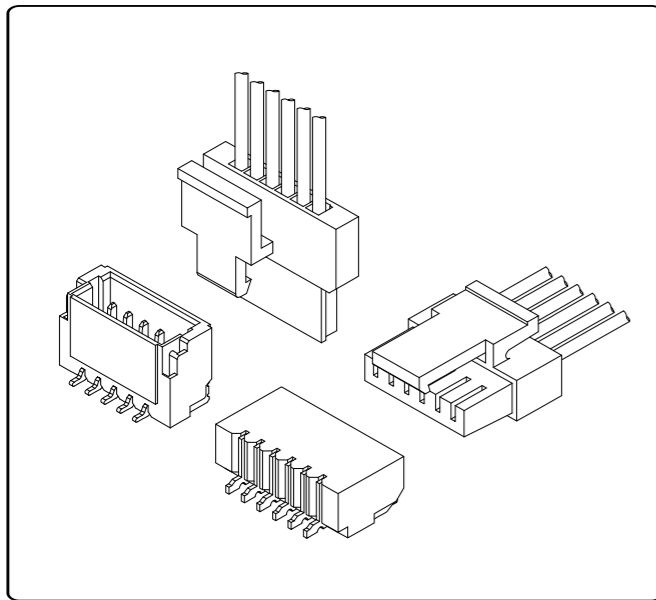

**Specifications**

Temperature range: -25°C~+85°C  
 Voltage rating: 50V  
 Current rating: 1A  
 Contact resistance: 20mΩ Max  
 Insulation resistance: 100MΩ Min  
 Withstand voltage: 500V AC

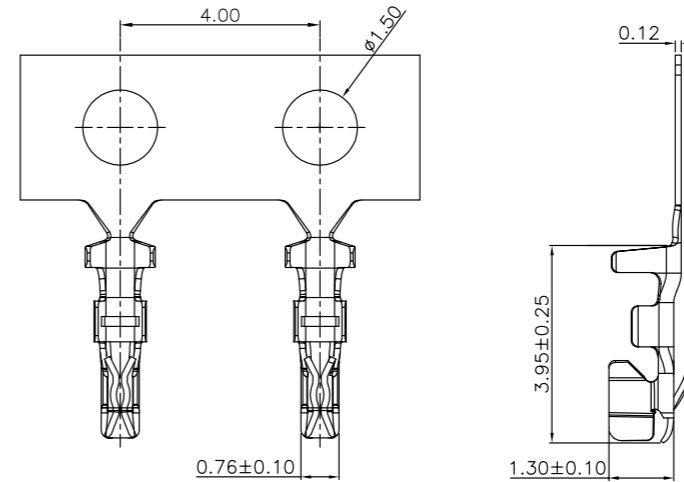

**Specifications**

MATERIAL SPECIFICATION:  
 Terminal: Phosphor Bronze  
 PLATING SPECIFICATION:  
 Bright tin  
 APPLICABLE WIRES: AWG #28 -#32  
 SUITABLE A1002 series housing

SERIES NO: A1002 T F X-X  
 CONNECTOR: 1-G/F  
 T-TERMINAL  
 MALE FEMALE: P-PHOSPHOR BRONZE  
 F-FEMALE  
 M-MALE

PLATING:  
 1-G/F  
 A-ALL AU G/F  
 C-BRIGHT TIN  
 H-ALL-AU 15U"  
 METAL:  
 P-PHOSPHOR BRONZE  
 B-BRASS

**Assembly layout**

wire to board

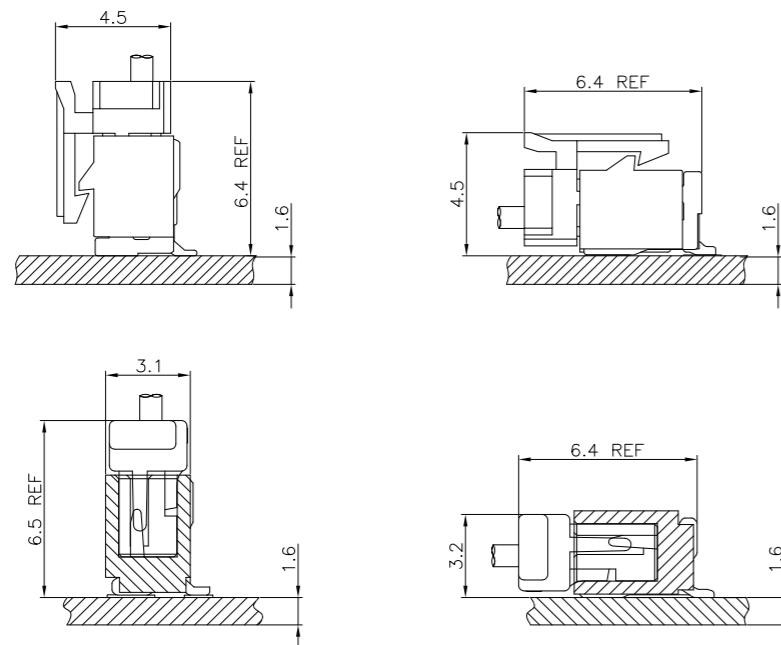

SMT Type

**A1002HM-1XXX0**

Pitch 1.00mm Single row Housing

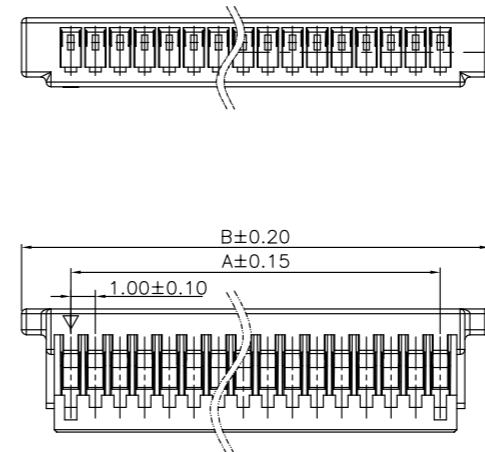

**Specifications**

MATERIAL SPECIFICATION:  
 Housing: PA66,94V-0  
 Suitable A1002 series Terminal  
 Mates With A1002 series Wafer

SERIES NO: A1002 H M-1 XX X 0  
 CONNECTOR: H-HOUSING  
 MALE FEMALE: M-MALE  
 COLOR: A-BLACK  
 K-WHITE  
 PIN Q' PY: 02~20  
 ROW NO: 1-SINGLE ROW

Circuit	Dimensions(mm)		Circuit	Dimensions(mm)	
	A	B		A	B
02	---	5.00	12	11.00	15.00
03	2.00	6.00	13	12.00	16.00
04	3.00	7.00	14	13.00	17.00
05	4.00	8.00	15	14.00	18.00
06	5.00	9.00	16	15.00	19.00
07	6.00	10.00	17	16.00	20.00
08	7.00	11.00	18	17.00	21.00
09	8.00	12.00	19	18.00	22.00
10	9.00	13.00	20	19.00	23.00
11	10.00	14.00			

**A1002H1M-1XXX0**

Pitch 1.00mm Single row Housing

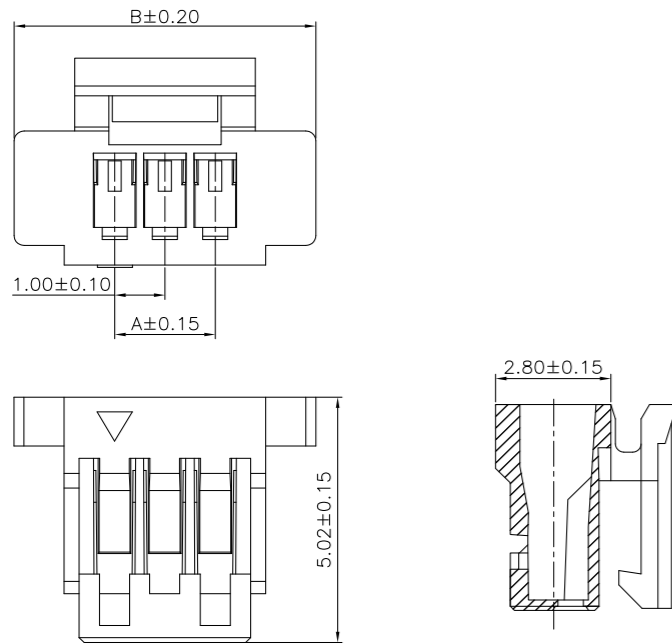

**Specifications**

MATERIAL SPECIFICATION:  
Housing: PA66,94V-0

Suitable A1002 series Terminal  
Mates With A1002 series Wafer

SERIES NO: A1002 H 1 M-1 XX X 0  
 CONNECTOR: H-HOUSING  
 TYPE CODE: M-1 XX X 0  
 COLOR: A-BLACK, K-WHITE  
 PIN Q'PY: 02~12  
 ROW NO: 1-SINGLE ROW  
 MALE FEMALE: M-MALE, F-FEMALE

Circuit	Dimensions(mm)		Circuit	Dimensions(mm)	
	A	B		A	B
02	---	5.00	08	7.00	11.00
03	2.00	6.00	09	8.00	12.00
04	3.00	7.00	10	9.00	13.00
05	4.00	8.00	11	10.00	14.00
06	5.00	9.00	12	11.00	15.00
07	6.00	10.00			

**A1002W9-1XX2XX0**

Pitch 1.00mm 90° Single row SMT Wafer

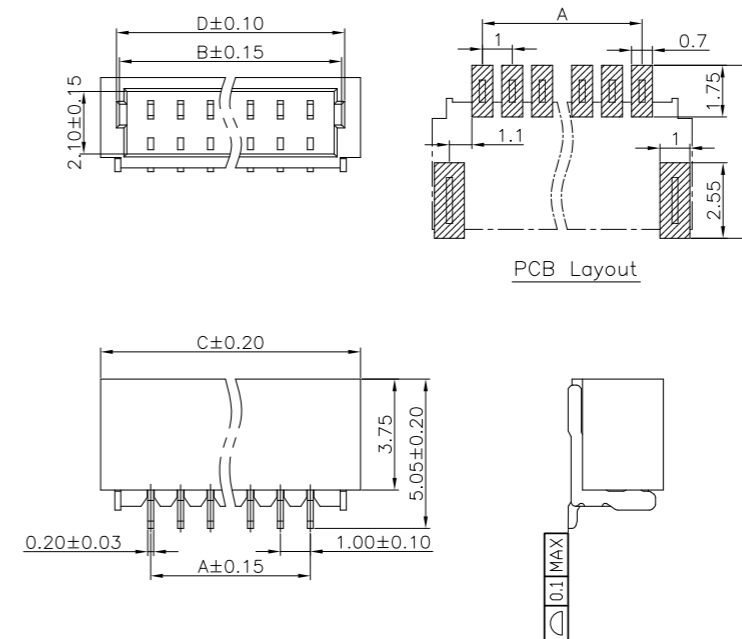

**Specifications**

MATERIAL SPECIFICATION:  
Housing: LCP,94V-0  
Contacts: Phosphor Bronze

PLATING SPECIFICATION:  
Contacts:Bright tin

Mates with A1002 series housing

SERIES NO: A1002 W 9-1 XX 2 X X 0  
 CONNECTOR: W-WAFER  
 ANGLE: 9-90°  
 ROW NO: 1-SINGLE ROW  
 PIN Q'PY: 02~20  
 COLOR: A-BLACK, S-NATURE  
 PLATING: A-ALL AU G/F, C-BRIGHT TIN, D-MATTE TIN  
 TERMIPOINT: 2-SMT

Circuit	Dimensions(mm)				Circuit	Dimensions(mm)			
	A	B	C	D		A	B	C	D
02	---	2.5	4.3	3.2	12	11.0	12.6	14.3	13.2
03	2.0	3.6	5.3	4.2	13	12.0	13.6	15.3	14.2
04	3.0	4.5	6.3	5.2	14	13.0	14.6	16.3	15.2
05	4.0	5.5	7.3	6.2	15	14.0	15.6	17.3	16.2
06	5.0	6.5	8.3	7.2	16	15.0	16.6	18.3	17.2
07	6.0	7.6	9.3	8.2	17	16.0	17.6	19.3	18.2
08	7.0	8.5	10.3	9.2	18	17.0	18.6	20.3	19.2
09	8.0	9.6	11.3	10.2	19	18.0	19.6	21.3	20.2
10	9.0	10.6	12.3	11.2	20	19.0	20.6	22.3	21.2
11	10.0	11.6	13.3	12.2					

**A1002W0-1XX2XX0**

Pitch 1.00mm 180° Single row SMT Wafer

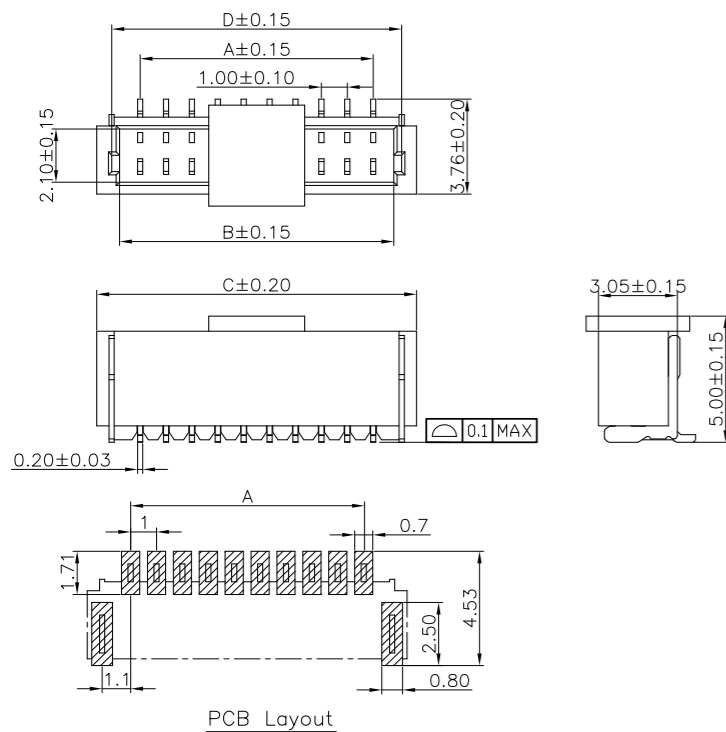

**Specifications**

MATERIAL SPECIFICATION:  
Housing: LCP,94V-0  
Contacts: Phosphor Bronze

PLATING SPECIFICATION:  
Contacts:Bright tin

Mates with A1002 series housing

SERIES NO: A1002 W 0-1 XX 2 X X 0  
 CONNECTOR: W-WAFER  
 ANGLE: 0-180°  
 ROW NO: 1-SINGLE ROW  
 PIN Q'PY: 02~20  
 COLOR: A-BLACK, S-NATURE  
 PLATING: A-ALL AU G/F, C-BRIGHT TIN, D-MATTE TIN  
 TERMIPOINT: 2-SMT

Circuit	Dimensions(mm)				Circuit	Dimensions(mm)			
	A	B	C	D		A	B	C	D
02	---	2.5	4.3	3.2	12	11.0	12.6	14.3	13.2
03	2.0	3.6	5.3	4.2	13	12.0	13.6	15.3	14.2
04	3.0	4.5	6.3	5.2	14	13.0	14.6	16.3	15.2
05	4.0	5.5	7.3	6.2	15	14.0	15.6	17.3	16.2
06	5.0	6.5	8.3	7.2	16	15.0	16.6	18.3	17.2
07	6.0	7.6	9.3	8.2	17	16.0	17.6	19.3	18.2
08	7.0	8.5	10.3	9.2	18	17.0	18.6	20.3	19.2
09	8.0	9.6	11.3	10.2	19	18.0	19.6	21.3	20.2
10	9.0	10.6	12.3	11.2	20	19.0	20.6	22.3	21.2
11	10.0	11.6	13.3	12.2					

**A1002W01-1XX2XX0**

Pitch 1.00mm 180° Single row SMT Wafer

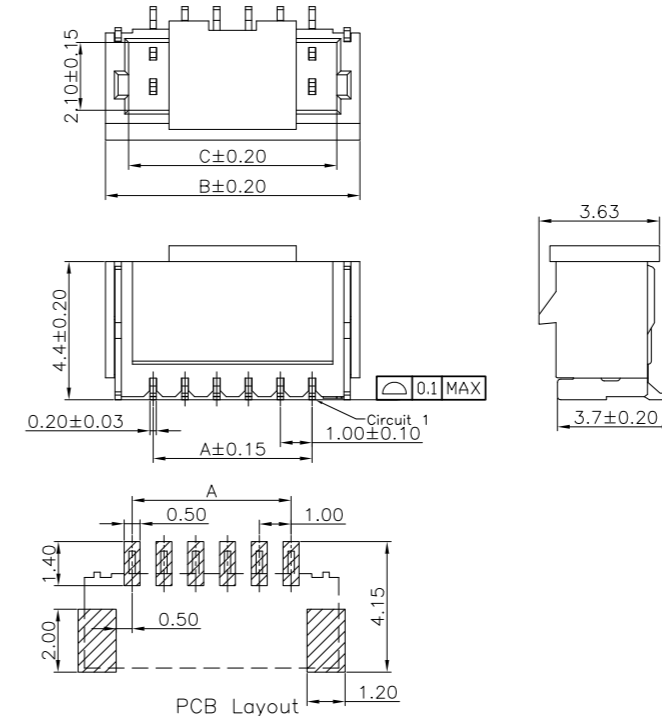

**Specifications**

MATERIAL SPECIFICATION:  
Housing: LCP,94V-0  
Contacts: Phosphor Bronze

PLATING SPECIFICATION:  
Contacts:Matte Tin

Mates with A1002 series housing

SERIES NO: A1002 W 0 1-1 XX 2 X X 0  
 CONNECTOR: W-WAFER  
 ANGLE: 0-180°  
 TYPE: 1-TYPE 1  
 ROW NO: 1-SINGLE ROW  
 COLOR: A-BLACK, S-NATURE  
 PLATING: A-ALL AU G/F, C-BRIGIE TIN, D-MATTE Tin  
 TERMIPOINT: 2-SMT  
 PIN Q'PY: 02~20

Circuit	Dimensions (mm)			Circuit	Dimensions (mm)		
	A	B	C		A	B	C
02	---	4.00	2.45	12	11.00	14.00	12.45
03	2.00	5.00	3.45	13	12.00	15.00	13.45
04	3.00	6.00	4.45	14	13.00	16.00	14.45
05	4.00	7.00	5.45	15	14.00	17.00	15.45
06	5.00	8.00	6.45	16	15.00	18.00	16.45
07	6.00	9.00	7.45	17	16.00	19.00	17.45
08	7.00	10.00	8.45	18	17.00	20.00	18.45
09	8.00	11.00	9.45	19	18.00	21.00	19.45
10	9.00	12.00	10.45	20	19.00	22.00	20.45
11	10.00	13.00	11.45				

**A1002W91-1XX2XX0**

Pitch 1.00mm 90° Single row SMT Wafer

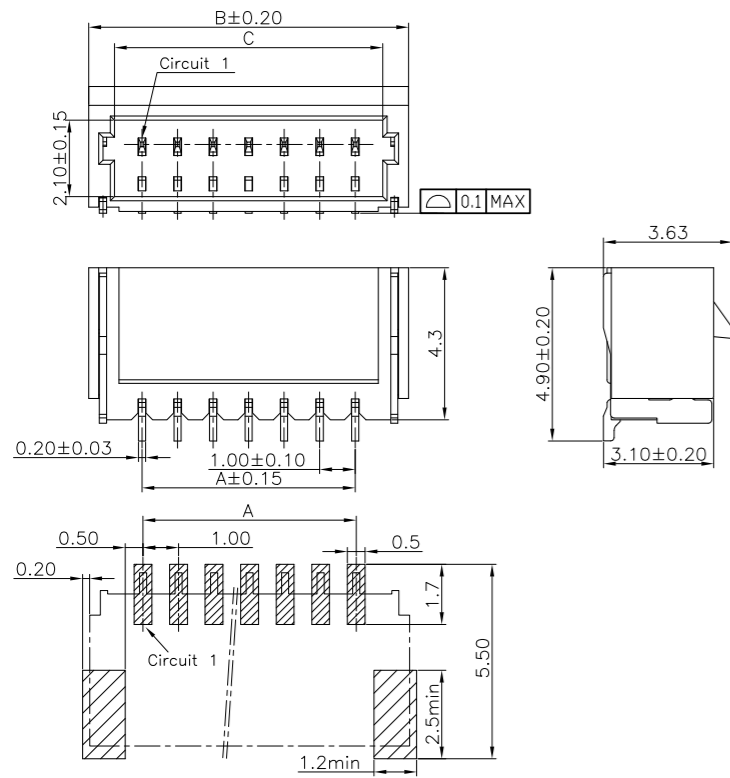

**Specifications**

MATERIAL SPECIFICATION:  
Housing: LCP,94V-0  
Contacts: Phosphor Bronze

PLATING SPECIFICATION:  
Contacts:Matte Tin

Mates with A1002 series housing

SERIES NO: A1002 W 9 1-1 XX 2 X X 0  
CONNECTOR: W-WAFER  
ANGLE: 9-90°  
TYPE: 1-TYPE 1  
ROW NO: 1-SINGLE ROW

COLOR:  
A-BLACK  
S-NATURE

PLATING:  
A-ALL AU G/F  
C-BRIGHE TIN  
D-MATTE Tin

TERMIPOINT:  
2-SMT

PIN Q' PY:  
02~20

Circuit	Dimensions (mm)			Circuit	Dimensions (mm)		
	A	B	C		A	B	C
02	---	4.00	2.45	12	11.00	14.00	12.45
03	2.00	5.00	3.45	13	12.00	15.00	13.45
04	3.00	6.00	4.45	14	13.00	16.00	14.45
05	4.00	7.00	5.45	15	14.00	17.00	15.45
06	5.00	8.00	6.45	16	15.00	18.00	16.45
07	6.00	9.00	7.45	17	16.00	19.00	17.45
08	7.00	10.00	8.45	18	17.00	20.00	18.45
09	8.00	11.00	9.45	19	18.00	21.00	19.45
10	9.00	12.00	10.45	20	19.00	22.00	20.45
11	10.00	13.00	11.45				

**Specifications**

Temperature range: -25°C~+85°C  
Voltage rating: 50V  
Current rating: 1A  
Contact resistance: 30mΩ Max  
Insulation resistance: 100MΩ Min  
Withstand voltage: 500V AC

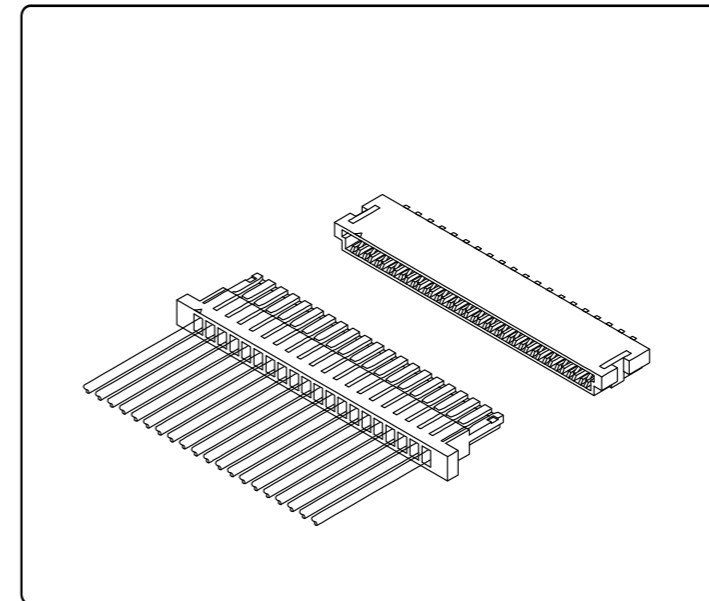

**Assembly layout**

wire to board

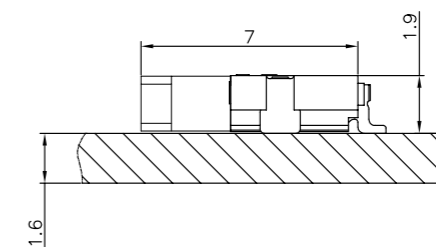

### A1006TFX-X

Pitch 1.00mm Terminal

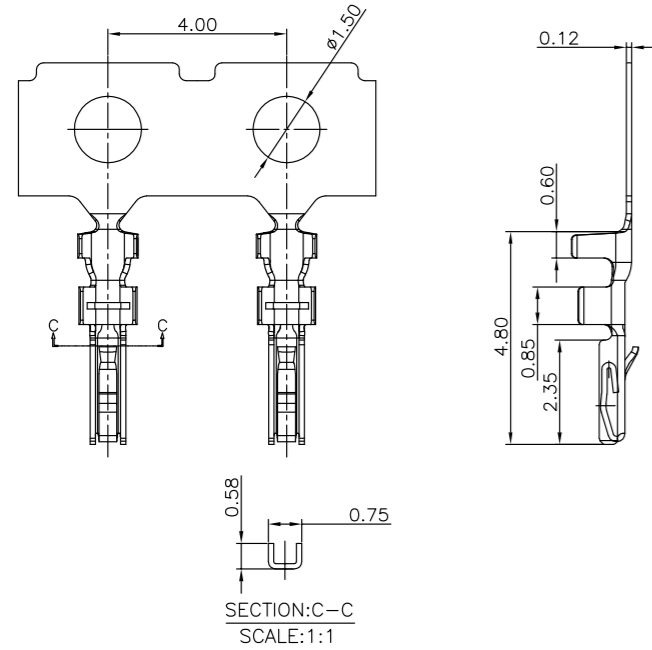

### Specifications

MATERIAL SPECIFICATION:  
Terminal: Phosphor Bronze

PLATING SPECIFICATION:  
Bright tin

APPLICABLE WIRES: AWG #28-#32  
SUITABLE A1006 series housing

SERIES NO: A1006 T F X-X  
CONNECTOR: T-TERMINAL  
MALE FEMALE: F-FEMALE M-MALE

PLATING:  
A-ALL AU G/F  
C-BRIGHT TIN  
D-MATTE TIN

METAL:  
P-PHOSPHOR BRONZE  
B-BRASS

### A1006W9-1XX2XX0

Pitch 1.00mm 90° Single row SMT Wafer

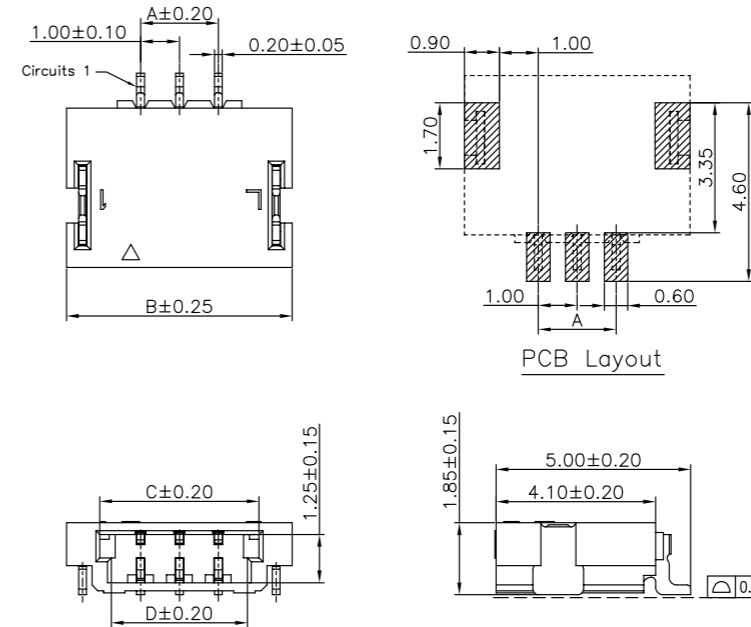

### Specifications

MATERIAL SPECIFICATION:  
Housing: PA6T,94V-0  
Contacts: Phosphor Bronze

PLATING SPECIFICATION:  
Contacts: Bright tin

Mates with A1006 series housing

SERIES NO: A1006 W 9-1 XX 2 X X 0  
CONNECTOR: W-WAFER  
ANGLE: 9-90°  
ROW NO: 1-SINGLE ROW  
PIN Q' PY: 02~30

COLOR:  
A-BLACK  
S-NATURE

PLATING:  
A-ALL AU G/F  
C-BRIGHT TIN  
D-MATTE Tin

TERMINIT:  
2-SMT

Circuit	Dimensions(mm)				Circuit	Dimensions(mm)			
	A	B	C	D		A	B	C	D
02	---	4.80	3.10	2.50	17	16.00	19.80	18.10	17.50
03	2.00	5.80	4.10	3.50	18	17.00	20.80	19.10	18.50
04	3.00	6.80	5.10	4.50	19	18.00	21.80	20.10	19.50
05	4.00	7.80	6.10	5.50	20	19.00	22.80	21.10	20.50
06	5.00	8.80	7.10	6.50	21	20.00	23.80	22.10	21.50
07	6.00	9.80	8.10	7.50	22	21.00	24.80	23.10	22.50
08	7.00	10.80	9.10	8.50	23	22.00	25.80	24.10	23.50
09	8.00	11.80	10.10	9.50	24	23.00	26.80	25.10	24.50
10	9.00	12.80	11.10	10.50	25	24.00	27.80	26.10	25.50
11	10.00	13.80	12.10	11.50	26	25.00	28.80	27.10	26.50
12	11.00	14.80	13.10	12.50	27	26.00	29.80	28.10	27.50
13	12.00	15.80	14.10	13.50	28	27.00	30.80	29.10	28.50
14	13.00	16.80	15.10	14.50	29	28.00	31.80	30.10	29.50
15	14.00	17.80	16.10	15.50	30	29.00	32.80	31.10	30.50
16	15.00	18.80	17.10	16.50					

### A1006HM-1XXX0

Pitch 1.00mm Single row Housing

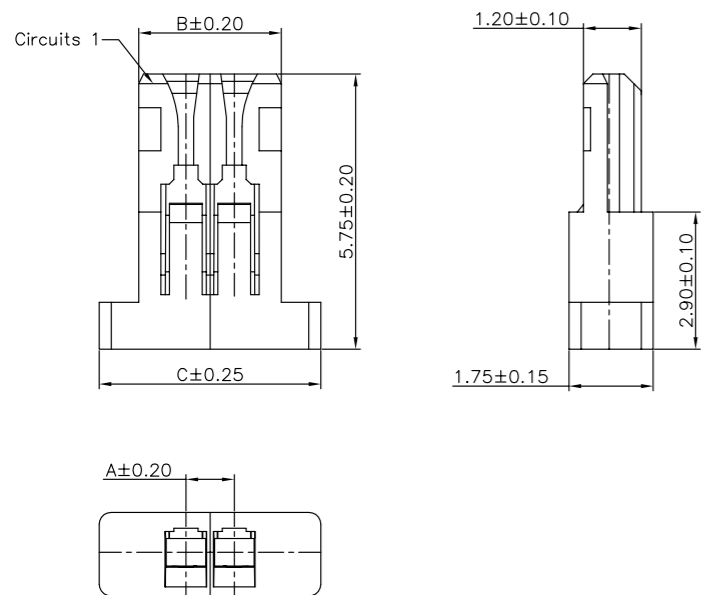

### Specifications

MATERIAL SPECIFICATION:  
Housing: PA66,94V-0

Suitable A1006 series Terminal  
Mates With A1006 series Wafer

SERIES NO: A1006 H M-1 XX X 0  
CONNECTOR: H-HOUSING  
MALE FEMALE: M-MALE

COLOR:  
A-BLACK  
S-NATURE

PIN Q' PY: 02~30

ROW NO: 1-SINGLE ROW

Circuit	Dimension(mm)			Circuit	Dimension(mm)		
	A	B	C		A	B	C
02	---	3.00	4.60	12	11.00	13.00	14.60
03	2.00	4.00	5.60	13	12.00	14.00	15.60
04	3.00	5.00	6.60	14	13.00	15.00	16.60
05	4.00	6.00	7.60	15	14.00	16.00	17.60
06	5.00	7.00	8.60	16	15.00	17.00	18.60
07	6.00	8.00	9.60	20	19.00	21.00	22.60
08	7.00	9.00	10.60	22	21.00	23.00	24.60
09	8.00	10.00	11.60	26	25.00	27.00	28.60
10	9.00	11.00	12.60	30	29.00	31.00	32.60
11	10.00	12.00	13.60				

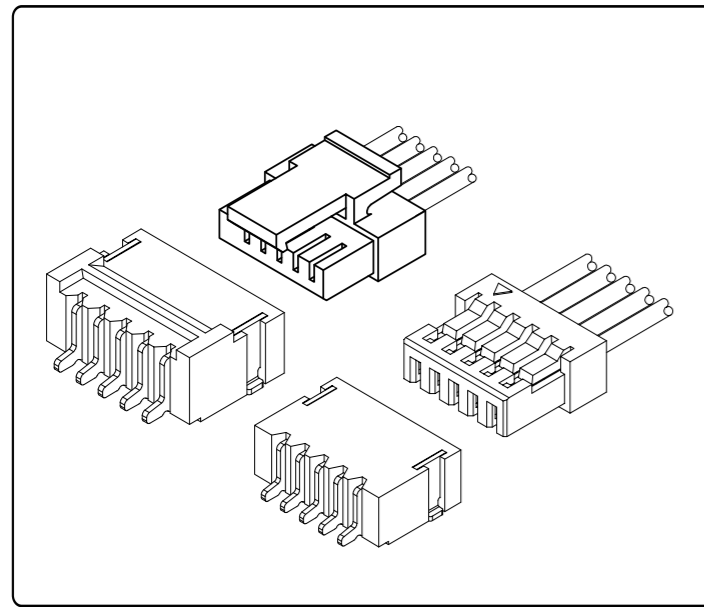

### Specifications

Temperature range: -25°C~+85°C  
 Voltage rating: 125V  
 Current rating: 1A  
 Contact resistance: 20mΩ Max  
 Insulation resistance: 100MΩ Min  
 Withstand voltage: 500V AC

### A1009TFX-X

Pitch 1.00mm Terminal

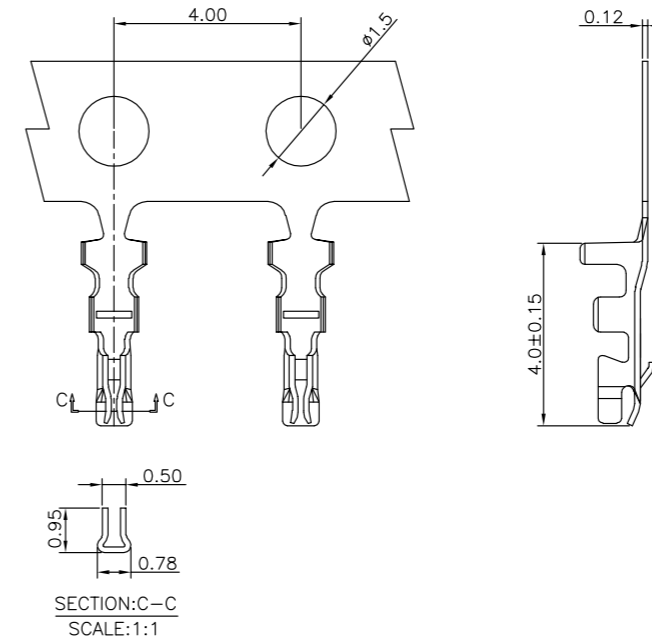

### Specifications

MATERIAL SPECIFICATION:  
Terminal: Phosphor Bronze

PLATING SPECIFICATION:  
Bright tin

APPLICABLE WIRES: AWG #28-#32  
SUITABLE A1009 series housing

SERIES NO: A1009 T F X-X  
 CONNECTOR: T-TERMINAL  
 MALE FEMALE: F-FEMALE

PLATING:  
A-ALL AU G/F  
C-BRIGHT TIN  
D-MATTE TIN

METAL:  
P-PHOSPHOR BRONZE  
B-BRASS

### Assembly layout

wire to board

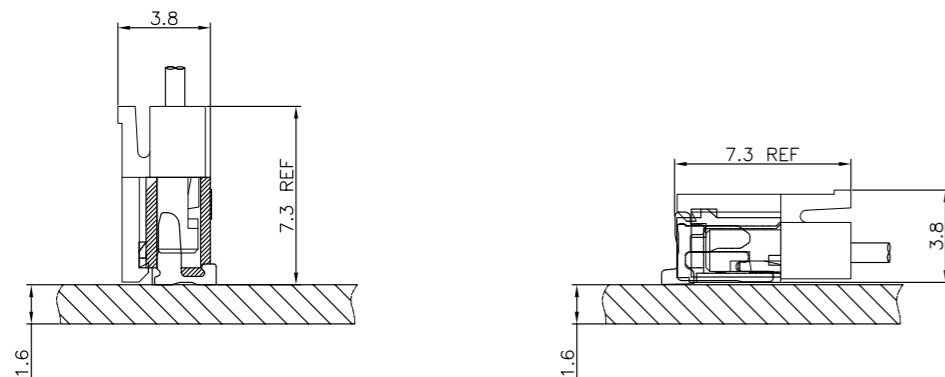

### A1009T1FX-X

Pitch 1.00mm Terminal

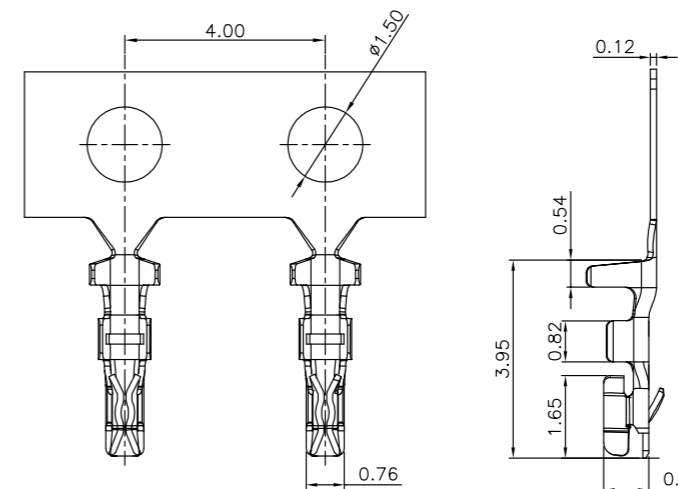

### Specifications

MATERIAL SPECIFICATION:  
Terminal: Phosphor Bronze

PLATING SPECIFICATION:  
Bright tin

APPLICABLE WIRES: AWG #28-#32  
SUITABLE A1009 series housing

SERIES NO: A1009 T 1 F X-X  
 CONNECTOR: T-TERMINAL  
 TYPE CODE: M-MALE

PLATING:  
A-ALL AU G/F  
C-BRIGHT TIN  
D-MATTE TIN

METAL:  
P-PHOSPHOR BRONZE  
B-BRASS

### A1009HM-1XXX0

Pitch 1.00mm Single row Housing

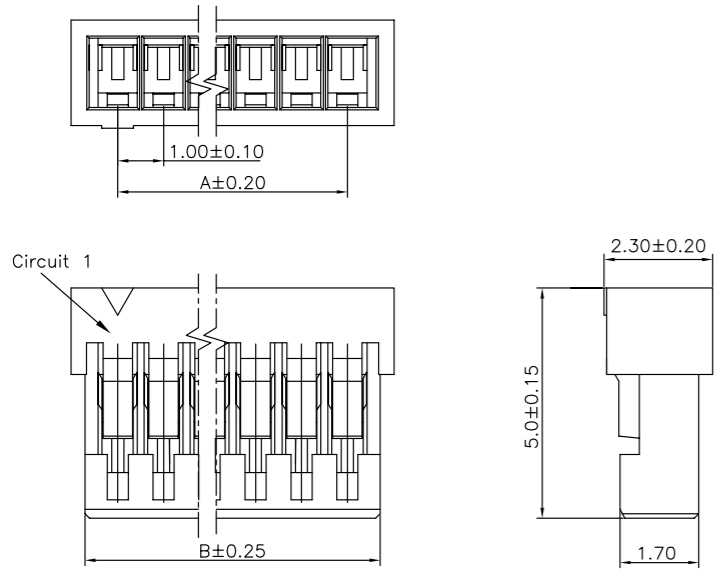

#### Specifications

MATERIAL SPECIFICATION:  
Housing: PA66,94V-0

Suitable A1009 series Terminal  
Mates With A1009 series Wafer

SERIES NO: A1009 H M-1 XX X 0  
 COLOR: A-BLACK, K-WHITE  
 CONNECTOR: H-HOUSING  
 MALE FEMALE: M-MALE  
 PIN Q'PY: 02~20  
 ROW NO: 1-SINGLE ROW

Circuit	Dimensions(mm)		Circuit	Dimensions(mm)	
	A	B		A	B
02	---	2.40	09	8.00	9.40
03	2.00	3.40	10	9.00	10.40
04	3.00	4.40	11	10.00	11.40
05	4.00	5.50	12	11.00	12.40
06	5.00	6.40	13	12.00	13.40
07	6.00	7.40	14	13.00	14.40
08	7.00	8.40	15	14.00	15.40

### A1009W9-1XX2XX0

Pitch 1.00mm 90° Single row SMT Wafer

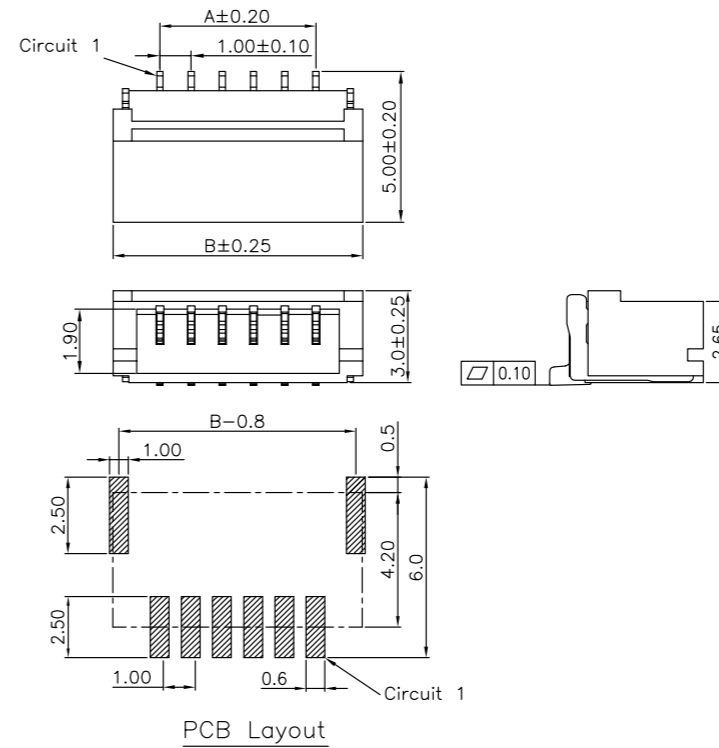

#### Specifications

MATERIAL SPECIFICATION:  
Housing: LCP,94V-0  
Contacts: Brass

PLATING SPECIFICATION:  
Contacts: Bright tin

Mates with A1009 series housing

SERIES NO: A1009 W 9-1 XX 2 X X 0  
 COLOR: A-BLACK, S-NATURE  
 CONNECTOR: W-WAFER  
 ANGLE: 9-90°  
 ROW NO: 1-SINGLE ROW  
 PIN Q'PY: 02~16  
 PLATING: A-ALL AU G/F, C-BRIGHT TIN  
 TERMIPOINT: 2-SMT

Circuit	Dimensions(mm)		Circuit	Dimensions(mm)	
	A	B		A	B
02	---	4.0	12	11.0	14.0
03	2.0	5.0	13	12.0	15.0
04	3.0	6.0	14	13.0	16.0
05	4.0	7.0	15	14.0	17.0
06	5.0	8.0	16	15.0	18.0
07	6.0	9.0	17	16.0	19.0
08	7.0	10.0	18	17.0	20.0
09	8.0	11.0	19	18.0	21.0
10	9.0	12.0	20	19.0	22.0
11	10.0	13.0			

### A1009H1M-1XXX0

Pitch 1.00mm Single row Housing

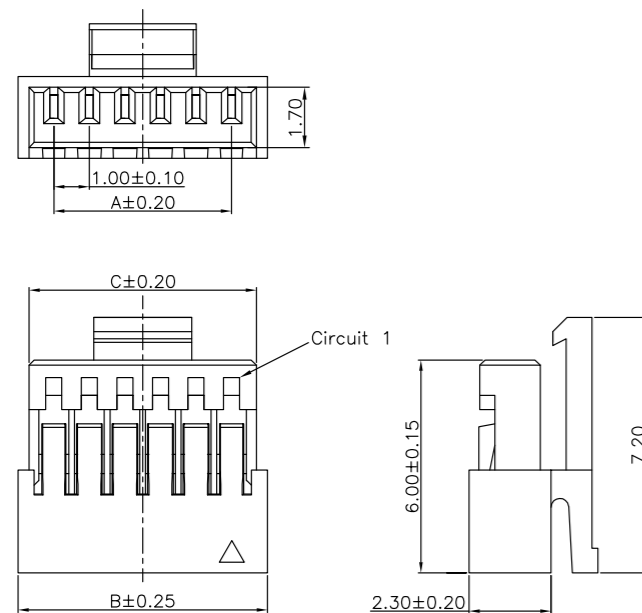

#### Specifications

MATERIAL SPECIFICATION:  
Housing: PA66,94V-0

Suitable A1009 series Terminal  
Mates With A1009 series Wafer

SERIES NO: A1009 H 1 M-1 XX X 0  
 COLOR: A-BLACK, S-NATURE  
 CONNECTOR: H-HOUSING  
 TYPE CODE:  
 MALE FEMALE: M-MALE  
 PIN Q'PY: 02~20  
 ROW NO: 1-SINGLE ROW

Circuit	Dimensions(mm)			Circuit	Dimensions(mm)		
	A	B	C		A	B	C
02	---	3.00	2.40	12	11.00	13.00	12.40
03	2.00	4.00	3.40	13	12.00	14.00	13.40
04	3.00	5.00	4.40	14	13.00	15.00	14.40
05	4.00	6.00	5.40	15	14.00	16.00	15.40
06	5.00	7.00	6.40	16	15.00	17.00	16.40
07	6.00	8.00	7.40	17	16.00	18.00	17.40
08	7.00	9.00	8.40	18	17.00	19.00	18.40
09	8.00	10.00	9.40	19	18.00	20.00	19.40
10	9.00	11.00	10.40	20	19.00	21.00	20.40
11	10.00	12.00	11.40				

### A1009W0-1XX2XX0

Pitch 1.00mm 90° Single row SMT Wafer

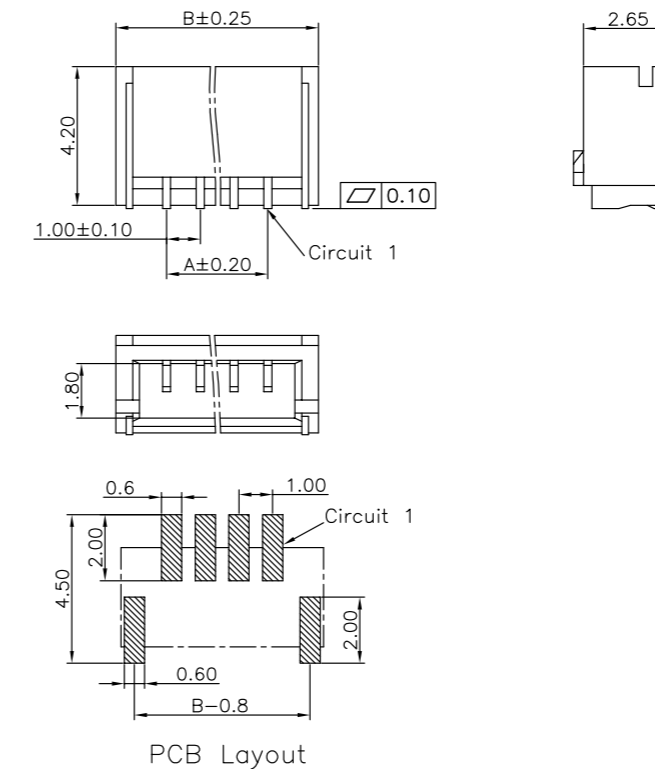

#### Specifications

MATERIAL SPECIFICATION:  
Housing: LCP,94V-0  
Contacts: Brass

PLATING SPECIFICATION:  
Contacts: Bright tin

Mates with A1009 series housing

SERIES NO: A1009 W 0-1 XX 2 X X 0  
 COLOR: A-BLACK, S-NATURE  
 CONNECTOR: W-WAFER  
 ANGLE: 0-180°  
 ROW NO: 1-SINGLE ROW  
 PIN Q'PY: 02~16  
 PLATING: A-ALL AU G/F, C-BRIGHT TIN, D-MATTE TIN  
 TERMIPOINT: 2-SMT

Circuit	Dimensions(mm)		Circuit	Dimensions(mm)	
	A	B		A	B
02	---	4.0	12	11.0	14.0
03	2.0	5.0	13	12.0	15.0
04	3.0	6.0	14	13.0	16.0
05	4.0	7.0	15	14.0	17.0
06	5.0	8.0	16	15.0	18.0
07	6.0	9.0	17	16.0	19.0
08	7.0	10.0	18	17.0	20.0
09	8.0	11.0	19	18.0	21.0
10	9.0	12.0	20	19.0	22.0
11	10.0	13.0			



**A1009W91-1XX2XXX**

Pitch 1.00mm 90° Single row SMT Wafer

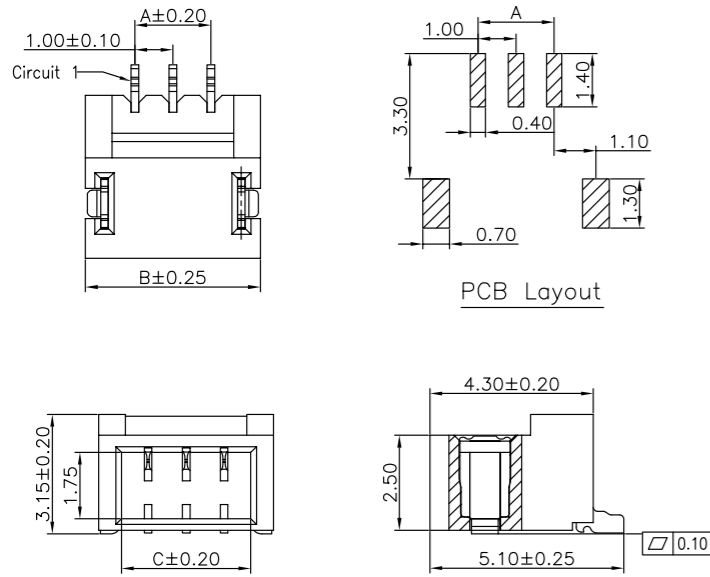

**Specifications**

MATERIAL SPECIFICATION:  
Housing: HTN/LCP,94V-0  
Contacts: Brass

PLATING SPECIFICATION:  
Contacts:Bright tin

Mates with A1009 series housing

SERIES NO: A1009 W 9 1-1 XX 2 X X X  
 CONNECTOR: W-WAFER  
 ANGLE: 9-90°  
 TYPE: 1-TYPE 1  
 ROW NO: 1-SINGLE ROW  
 PIN Q'PY: 02~15

COLOR:  
0-HTN ROHS+HF  
1-LCP ROHS+HF

COLOR:  
A-BLACK  
S-NATURE

PLATING:  
A-ALL AU G/F  
C-BRIGHE TIN  
D-MATTE Tin

TERMIPOINT:  
2-SMT

Circuit	Dimension(mm)			Circuit	Dimension(mm)		
	A	B	C		A	B	C
2	---	3.60	2.40	9	8.00	10.60	9.40
3	2.00	4.60	3.40	10	9.00	11.60	10.40
4	3.00	5.60	4.40	11	10.00	12.60	11.40
5	4.00	6.60	5.40	12	11.00	13.60	12.40
6	5.00	7.60	6.40	13	12.00	14.60	13.40
7	6.00	8.60	7.40	14	13.00	15.60	14.40
8	7.00	9.60	8.40	15	14.00	16.60	15.40

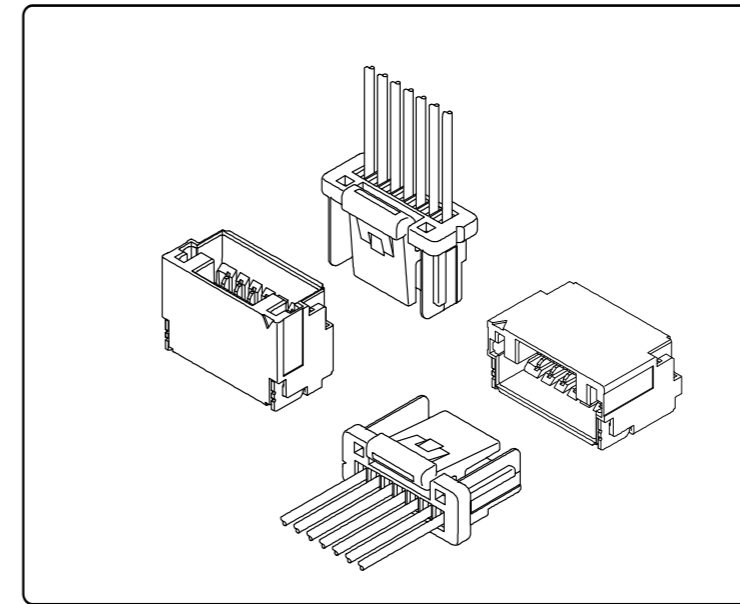

**Specifications**

Temperature range: -25°C~+85°C  
 Voltage rating: 50V  
 Current rating: 1A  
 Contact resistance: 30mΩ Max  
 Insulation resistance: 100MΩ Min  
 Withstand voltage: 500V AC

**Assembly layout**

wire to board

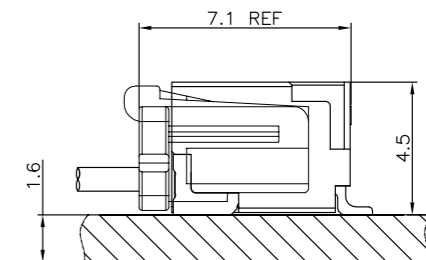
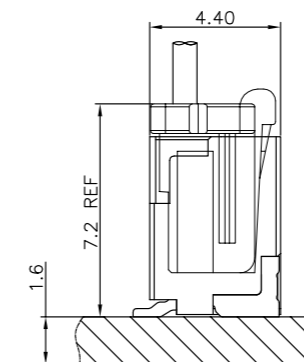

### A1010TFX-X

Pitch 1.00mm Terminal

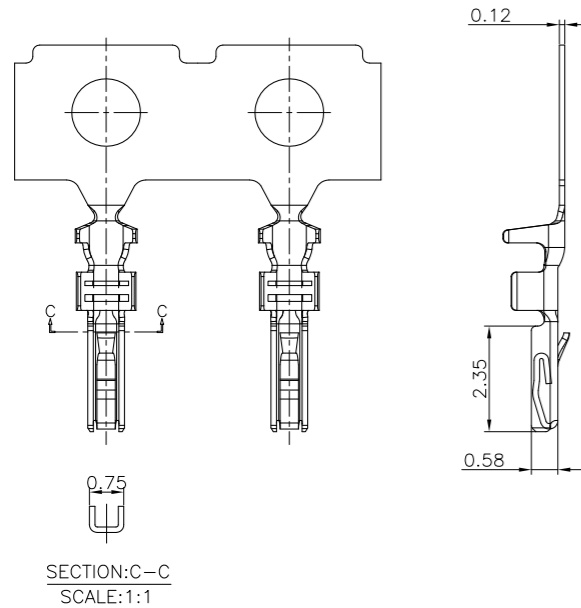

#### Specifications

MATERIAL SPECIFICATION:  
Terminal: Phosphor Bronze

PLATING SPECIFICATION:  
Bright tin

APPLICABLE WIRES:AWG #28-#32  
SUITABLE A1010 series housing

SERIES NO: A1010 T F X-X

CONNECTOR: T-TERMINAL

MALE FEMALE:  
F-FEMALE  
M-MALE

PLATING:  
A-ALL AU G/F  
C-BRIGHT TIN  
D-MATTE TIN

METAL:  
P-PHOSPHOR BRONZE  
B-BRASS

### A1010W0-1XX2XX0

Pitch 1.00mm 180° Single row SMT Wafer

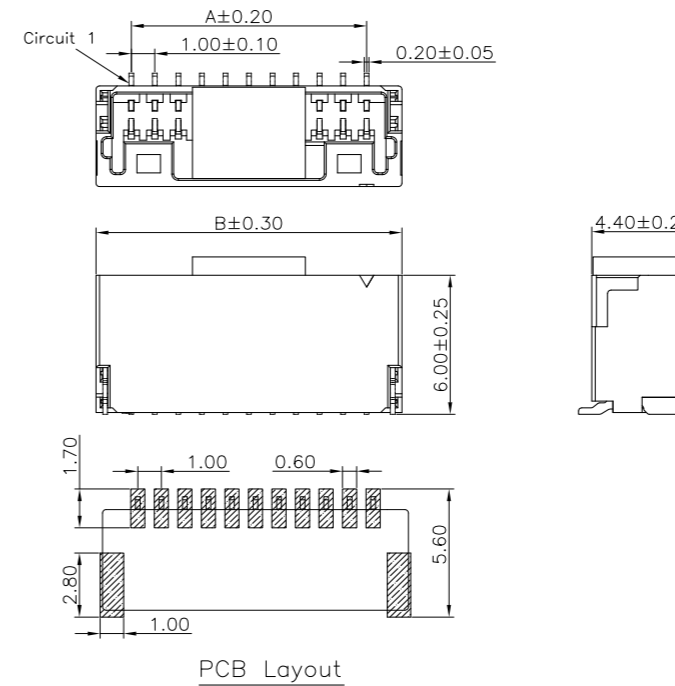

#### Specifications

MATERIAL SPECIFICATION:  
Housing: LCP,94V-0  
Contacts: Phosphor Bronze

PLATING SPECIFICATION:  
Contacts:Bright tin

Mates with A1010 series housing

SERIES NO: A1010 W 0-1 XX 2 X X 0

CONNECTOR: W-WAFER

ANGLE: 0-180°

ROW NO: 1-SINGLE ROW

COLOR: S-NATURE  
PLATING: C-BRIGHT TIN  
TERMIPOINT: 2-SMT  
PIN Q PY: 02~15

Circuit	Dimension(mm)		Circuit	Dimension(mm)	
	A	B		A	B
02	---	5.00	09	8.00	11.00
03	2.00	5.00	10	9.00	12.00
04	3.00	6.00	11	10.00	13.00
05	4.00	7.00	12	11.00	14.00
06	5.00	8.00	13	12.00	15.00
07	6.00	9.00	14	13.00	16.00
08	7.00	10.00	15	14.00	17.00

PCB Layout

### A1010HM-1XXX0

Pitch 1.00mm Single row Housing

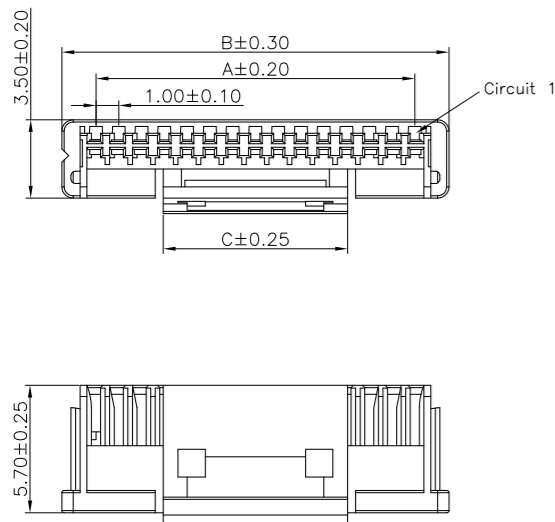

#### Specifications

MATERIAL SPECIFICATION:  
Housing: PA66,94V-0

Suitable A1010 series Terminal  
Mates With A1010 series Wafer

SERIES NO: A1010 H M-1 XX X 0

CONNECTOR: H-HOUSING

MALE FEMALE:  
M-MALE

COLOR: A-BLACK  
K-WHITE

PIN Q PY: 02~15

ROW NO: 1-SINGLE ROW

Circuit	Dimension(mm)			Circuit	Dimension(mm)		
	A	B	C		A	B	C
02	---	5.00	2.00	09	8.00	11.00	4.30
03	2.00	5.00	2.00	10	9.00	12.00	6.15
04	3.00	6.00	2.00	11	10.00	13.00	6.15
05	4.00	7.00	3.40	12	11.00	14.00	6.15
06	5.00	8.00	4.30	13	12.00	15.00	6.15
07	6.00	9.00	4.30	14	13.00	16.00	8.10
08	7.00	10.00	4.30	15	14.00	17.00	8.10

### A1010W9-1XX2XX0

Pitch 1.00mm 90° Single row SMT Wafer

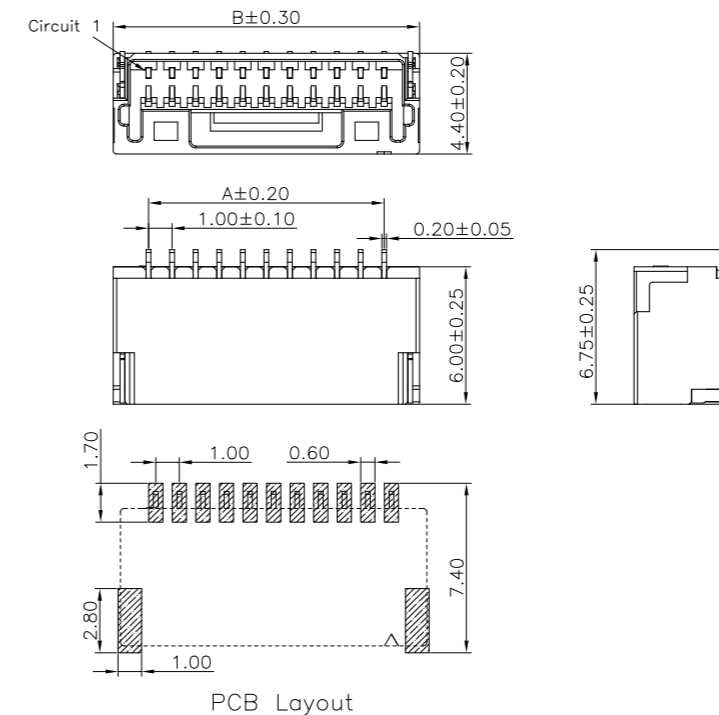

#### Specifications

MATERIAL SPECIFICATION:  
Housing: LCP,94V-0  
Contacts: Phosphor Bronze

PLATING SPECIFICATION:  
Contacts:Bright tin

Mates with A1010 series housing

SERIES NO: A1010 W 9-1 XX 2 X X 0

CONNECTOR: W-WAFER

ANGLE: 9-90°

ROW NO: 1-SINGLE ROW

COLOR: S-NATURE  
PLATING: C-BRIGHT TIN  
TERMIPOINT: 2-SMT  
PIN Q PY: 02~15

Circuit	Dimension(mm)		Circuit	Dimension(mm)	
	A	B		A	B
02	---	5.00	09	8.00	11.00
03	2.00	5.00	10	9.00	12.00
04	3.00	6.00	11	10.00	13.00
05	4.00	7.00	12	11.00	14.00
06	5.00	8.00	13	12.00	15.00
07	6.00	9.00	14	13.00	16.00
08	7.00	10.00	15	14.00	17.00

PCB Layout