

Specifications

Temperature range: $-25^{\circ}\text{C} \sim +85^{\circ}\text{C}$

Voltage rating: 600V

Current rating: 9A

Contact resistance: $10\text{m}\Omega$ Max

Insulation resistance: $1000\text{M}\Omega$ Min

Withstand voltage: 1500V AC

Assembly layout

wire to wire

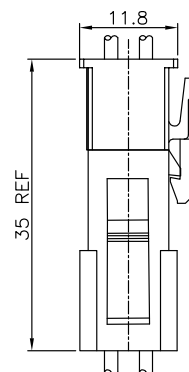
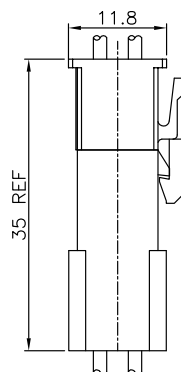
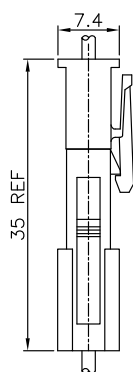
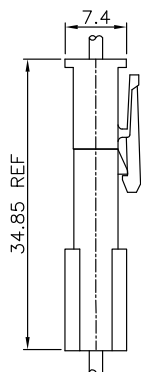

Assembly layout

wire to board

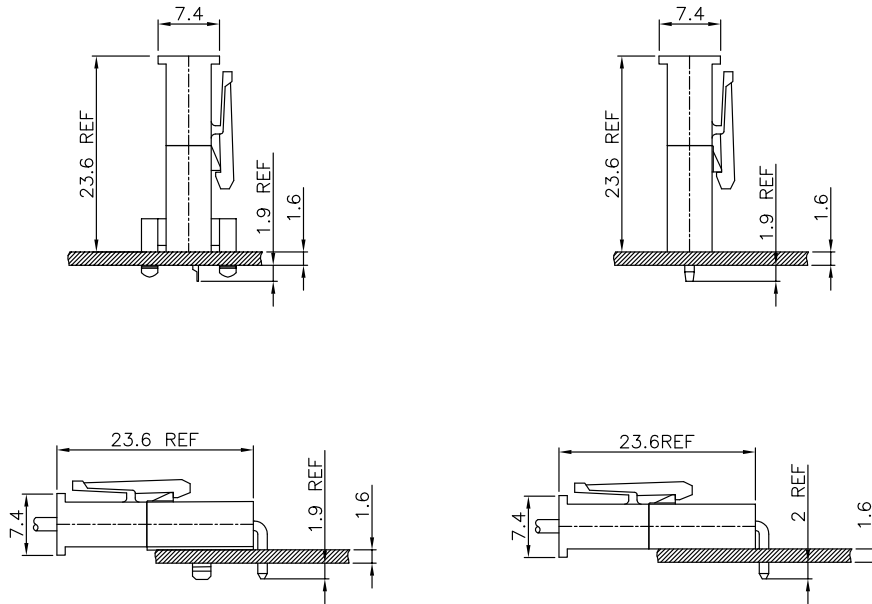

Single row DIP Type

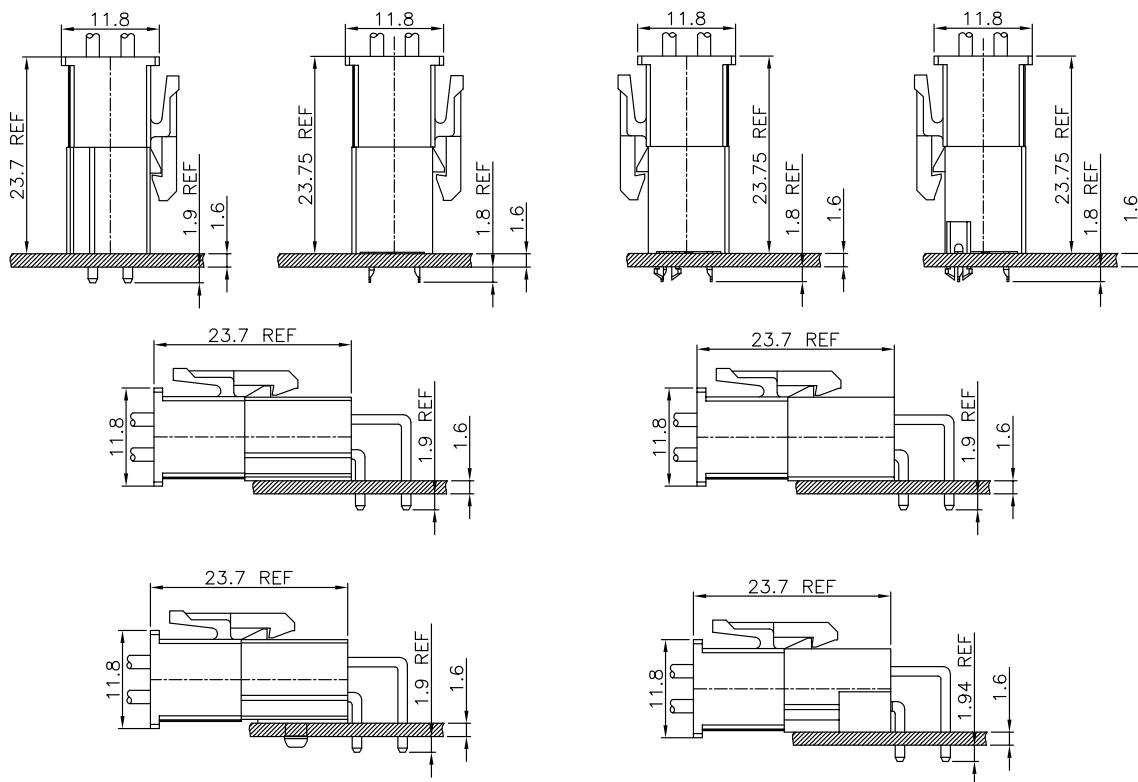

Double row DIP Type

C4201TXMX-X

Pitch 4.20mm Terminal

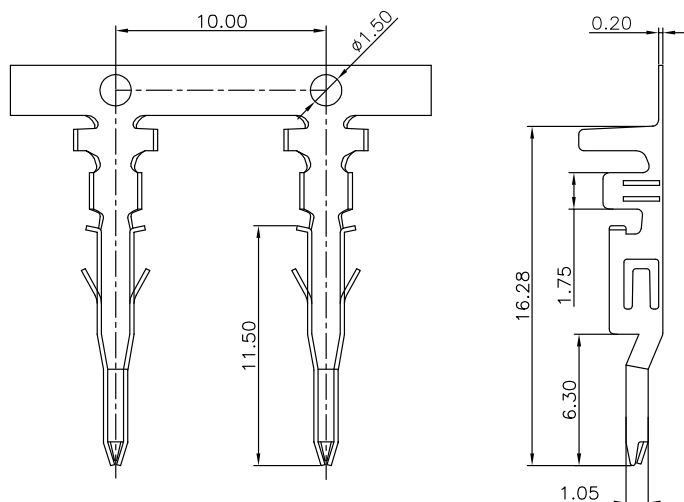

Specifications

MATERIAL SPECIFICATION:
Terminal: Phosphor Bronze

PLATING SPECIFICATION:
Bright tin

APPLICABLE WIRES: Normal (AWG #18-#24)
High (AWG #16-#22)

SUITABLE C4201 series Female housing

C4201 T X M X-X
SERIES NO: T X M X-X
CONNECTOR: T-TERMINAL
TYPE CODE: 1-NORMAL
2-HIGH
MALE FEMALE: F-FEMALE
M-MALE
PLATING:
1-G/F
A-ALL AU G/F
C-BRIGHT TIN
D-MATTE TIN
METAL:
P-PHOSPHOR BRONZE
B-BRASS
H-HIGH CONDUCTIVITY COPPER

C4201T1FX-X

Pitch 4.20mm Terminal

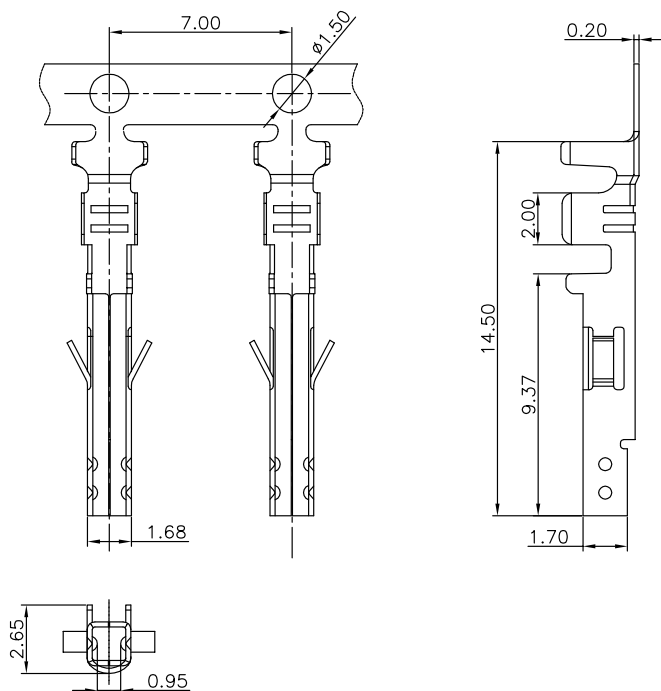

Specifications

MATERIAL SPECIFICATION:
Terminal: Phosphor Bronze

PLATING SPECIFICATION:
Bright tin

APPLICABLE WIRES: AWG #18-#22

SUITABLE C4201 series Male housing

C4201 T 1 F X-X
SERIES NO: T 1 F X-X
CONNECTOR: T-TERMINAL
TYPE CODE: 1
MALE FEMALE: F-FEMALE
M-MALE
PLATING:
1-G/F
A-ALL AU G/F
C-BRIGHT TIN
D-MATTE TIN
METAL:
P-PHOSPHOR BRONZE
B-BRASS
H-HIGH CONDUCTIVITY COPPER

C4201T2FX-X

Pitch 4.20mm Terminal

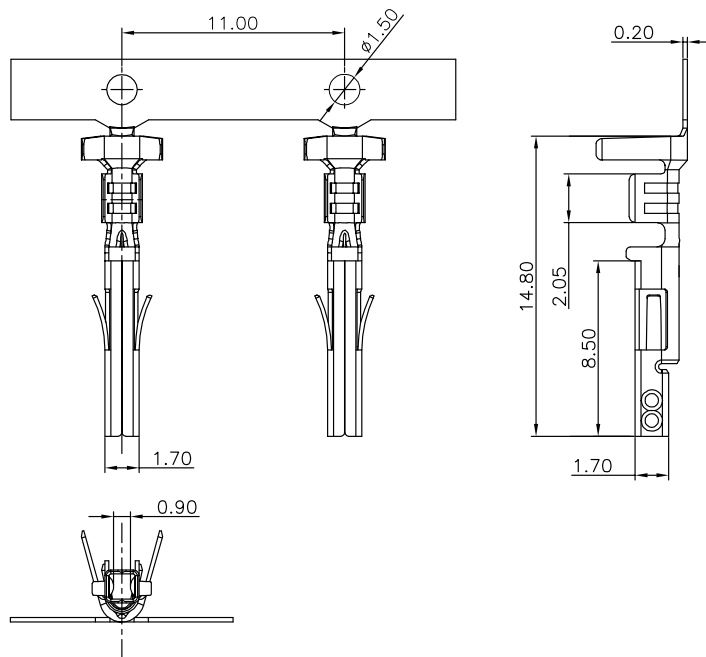

Specifications

MATERIAL SPECIFICATION:
Terminal: Phosphor Bronze

PLATING SPECIFICATION:
Bright tin

APPLICABLE WIRES:AWG #16-#20
SUITABLE C4201 series Male housing

C4201 T 2 F X-X
SERIES NO: T
CONNECTOR: 2
TYPE CODE: F
MALE FEMALE: X-X
F-FEMALE
M-MALE
PLATING:
1-G/F
A-ALL AU G/F
C-BRIGHT TIN
D-MATTE TIN
METAL:
P-PHOSPHOR BRONZE
B-BRASS
H-HIGH CONDUCTIVITY COPPER

C4201HF-1XXXX

Pitch 4.20mm Single row Housing

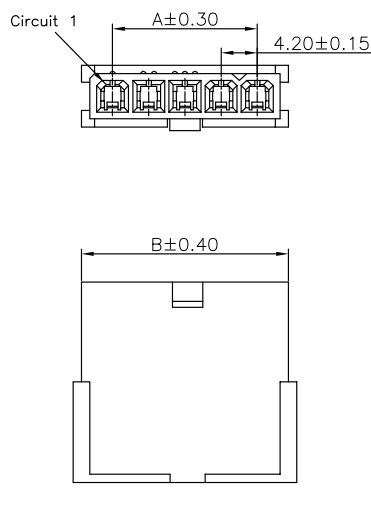

MATERIAL SPECIFICATION:
Housing: PA66,94V-0/94V-2

Suitable C4201 series Male Terminal
Mates With C4201 series Male housing

C4201 H F-1 XX X X
SERIES NO: H
CONNECTOR: F-1
H-HOUSING
MALE FEMALE: XX
F-FEMALE
ROW NO: X X
1-SINGLE ROW
WATER CODE
0-UL94V-0
2-UL94V-2
3-UL94V-0+HF
COLOR:
A-BLACK
S-NATURE
PIN Q'PY:
02~24

Circuit	Dimensions (mm)		Circuit	Dimensions (mm)	
	A	B		A	B
02	---	9.80	08	29.40	35.00
03	8.40	14.00	09	33.60	39.20
04	12.60	18.20	10	37.80	43.40
05	16.80	22.40	11	42.00	47.60
06	21.00	26.60	12	46.20	51.80
07	25.20	30.80			

C4201H1F-1XXXX

Pitch 4.20mm Single row Housing

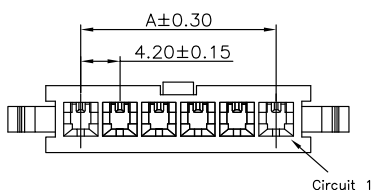
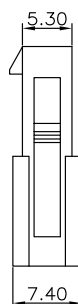
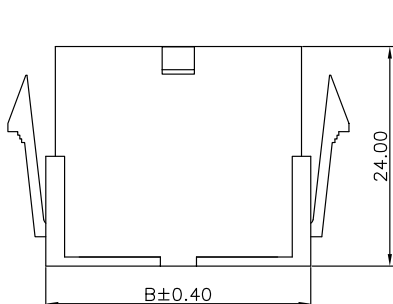

Specifications

MATERIAL SPECIFICATION:

Housing: PA66,94V-0/94V-2

Suitable C4201 series Male Terminal

Mates With C4201 series Male housing

SERIES NO: C4201 H 1 F-1 XX X X
 CONNECTOR: H-HOUSING
 1-TYPE CODE
 MALE FEMALE: F-FEMALE
 ROW NO: 1-SINGLE ROW
 WATER CODE
 0-UL94V-0
 2-UL94V-2
 COLOR:
 A-BLACK
 S-NATURE
 PIN Q'PY:
 02~06

Circuit	Dimensions (mm)	
	A	B
02	4.20	9.70
03	8.40	13.90
04	12.60	18.10
05	16.80	22.30
06	21.00	26.50

C4201HM-1XXXX

Pitch 4.20mm Single row Housing

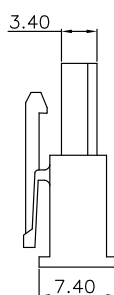
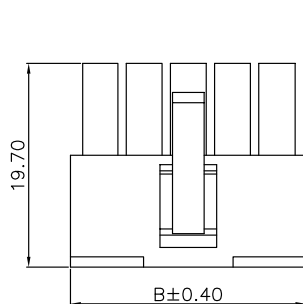
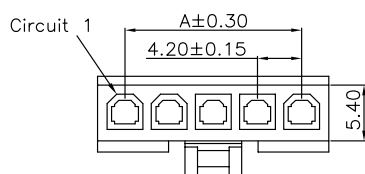

Specifications

MATERIAL SPECIFICATION:

Housing: PA66,94V-0/94V-2

Suitable C4201 series Female Terminal

Mates With C4201 series Female housing

Mates With C4201 series Wafer

SERIES NO: C4201 H M-1 XX X X
 CONNECTOR: H-HOUSING
 MALE FEMALE: M-MALE
 ROW NO: 1-SINGLE ROW
 WATER CODE
 0-UL94V-0
 2-UL94V-2
 3-UL94V-0+HF
 COLOR:
 A-BLACK
 S-NATURE
 PIN Q'PY:
 02~06

Circuit	Dimensions (mm)		
	A	B	C
02	---	9.60	7.50
03	8.40	13.80	11.60
04	12.60	18.00	15.80
05	16.80	22.20	20.20
06	21.00	26.60	24.10

C4201HF-2XXXX

Pitch 4.20mm Double row Housing

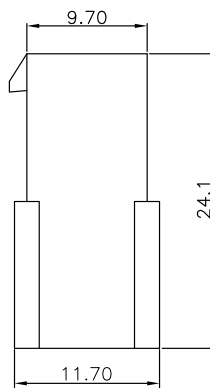
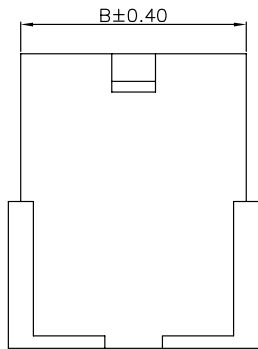
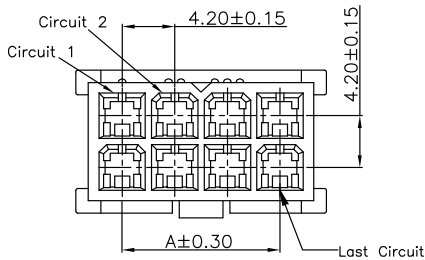

Specifications

MATERIAL SPECIFICATION:

Housing: PA66,94V-0/94V-2

Suitable C4201 series Male Terminal

Mates With C4201 series Male housing

SERIES NO: C4201 H F-2 XX X X
 CONNECTOR: H-HOUSING
 MALE FEMALE: F-FEMALE
 ROW NO: 2-DOUBLE ROW
 WATER CODE: 0-UL94V-0, 2-UL94V-2, 3-UL94V-0+HF
 COLOR: A-BLACK, S-NATURE
 PIN Q'PY: 02~24

Circuit	Dimensions (mm)		Circuit	Dimensions (mm)	
	A	B		A	B
2*01	---	5.60	2*07	25.20	30.80
2*02	---	9.80	2*08	29.40	35.00
2*03	8.40	14.00	2*09	33.60	39.20
2*04	12.60	18.20	2*10	37.80	43.40
2*05	16.80	22.40	2*11	42.00	47.60
2*06	21.00	26.60	2*12	46.20	51.80

C4201H1F-2XXXX

Pitch 4.20mm Double row Housing

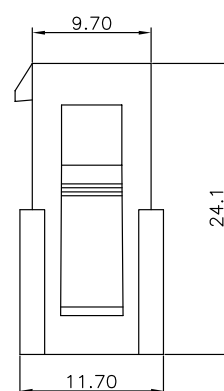
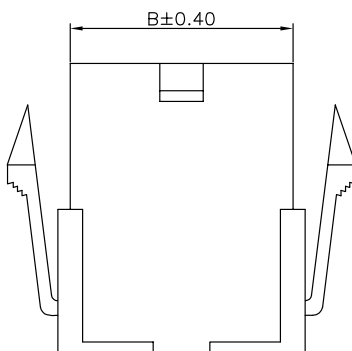
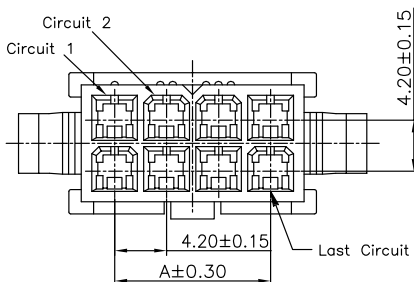

Specifications

MATERIAL SPECIFICATION:

Housing: PA66,94V-0/94V-2

Suitable C4201 series Male Terminal

Mates With C4201 series Male housing

SERIES NO: C4201 H 1 F-2 XX X X
 CONNECTOR: H-HOUSING
 1-TYPE CODE
 MALE FEMALE: F-FEMALE
 ROW NO: 2-DOUBLE ROW
 WATER CODE: 0-UL94V-0, 2-UL94V-2, 3-UL94V-0+HF
 COLOR: A-BLACK, S-NATURE
 PIN Q'PY: 02~24

Circuit	Dimensions (mm)		Circuit	Dimensions (mm)	
	A	B		A	B
2*01	---	5.60	2*07	25.20	30.80
2*02	---	9.80	2*08	29.40	35.00
2*03	8.40	14.00	2*09	33.60	39.20
2*04	12.60	18.20	2*10	37.80	43.40
2*05	16.80	22.40	2*11	42.00	47.60
2*06	21.00	26.60	2*12	46.20	51.80

C4201HM-2XXXX

Pitch 4.20mm Double row Housing

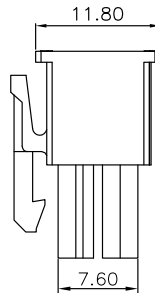
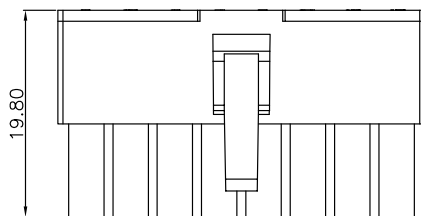
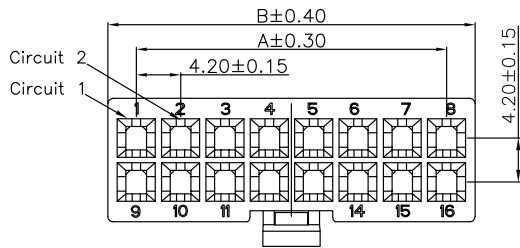

Specifications

MATERIAL SPECIFICATION:

Housing: PA66,94V-0/94V-2

Suitable C4201 series Female Terminal
Mates With C4201 series Female housing
Mates With C4201 series Wafer

SERIES NO: C4201 H M-2 XX X X
CONNECTOR: H-HOUSING
MALE FEMALE: M-MALE
ROW NO: 2-DOUBLE ROW
WATER CODE:
0-UL94V-0
2-UL94V-2
3-UL94V-0+HF
COLOR:
A-BLACK
S-NATURE
PIN Q' PY:
02~24

Circuit	Dimensions(mm)			Circuit	Dimensions(mm)		
	A	B	C		A	B	C
2*01	---	5.70	---	2*07	25.20	30.60	28.55
2*02	---	9.90	7.55	2*08	29.40	34.80	32.75
2*03	8.40	13.80	11.75	2*09	33.60	39.00	36.95
2*04	12.60	18.00	15.95	2*10	37.80	43.20	41.15
2*05	16.80	22.20	20.15	2*11	42.00	47.40	45.35
2*06	21.00	26.40	24.35	2*12	46.20	51.60	49.55

C4201H2M-2XXXX

Pitch 4.20mm Double row Housing

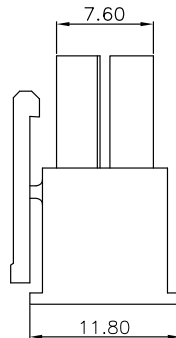
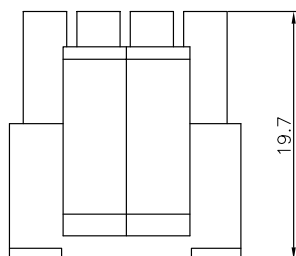
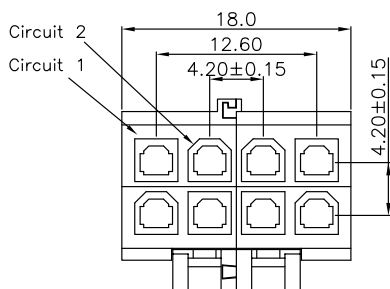

Specifications

MATERIAL SPECIFICATION:

Housing: PA66,94V-0/94V-2

Suitable C4201 series Female Terminal
Mates With C4201 series Wafer

SERIES NO: C4201 H 2 M-2 XX X X
CONNECTOR: H-HOUSING
2-TYPE CODE
MALE FEMALE: M-MALE
F-FEMALE
ROW NO: 2-DOUBLE ROW
HOUSING:
1-UL94V-0
2-UL94V-2
COLOR:
A-BLACK
S-NATURE
PIN Q' PY:
04+04

C4201W01-1XX1XXX

Pitch 4.20mm 180° Single row DIP Wafer

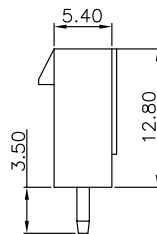
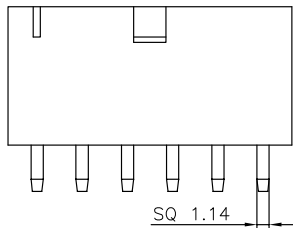
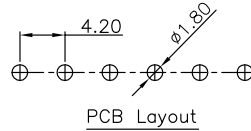
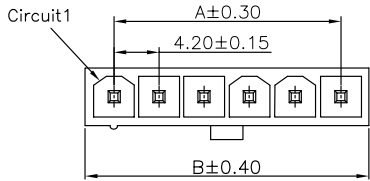

Specifications

MATERIAL SPECIFICATION:
Housing: PA66,94V-0/94V-2
Contacts: Brass

PLATING SPECIFICATION:
Contacts: Bright tin

Mates with C4201 series Male housing

C4201 W 0 1-1 XX 1 X X X
SERIES NO: ————
CONNECTOR: ————
W-WAFER
ANGLE: ————
0-180°
TYPE: ————
1-TYPE 1
ROW NO: ————
1-SINGLE ROW
PIN Q'PY: ————
02~06
HOUSING:
0-UL94V-0
2-UL94V-2
COLOR:
A-BLACK
S-NATURE
PLATING:
A-ALL AU G/F
C-BRIGHE TIN
D-MATTE Tin
TERMIPOINT:
1-DIP

Circuit	Dimensions (mm)	
	A	B
02	---	9.60
03	8.40	13.80
04	12.60	18.00
05	16.80	22.20
06	21.00	26.40

C4201W02-1XX1XXX

Pitch 4.20mm 180° Single row DIP Wafer

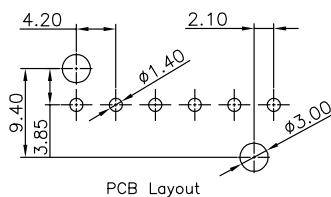
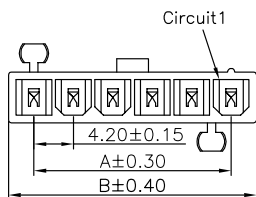
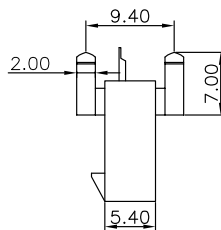
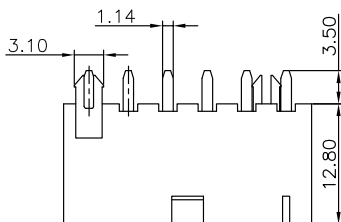

Specifications

MATERIAL SPECIFICATION:
Housing: PA66/LCP,94V-0/94V-2
Contacts: Brass

PLATING SPECIFICATION:
Contacts: Bright tin

Mates with C4201 series Male housing

C4201 W 0 2-1 XX 1 X X X
SERIES NO: ————
CONNECTOR: ————
W-WAFER
ANGLE: ————
0-180°
TYPE: ————
2-TYPE 2
ROW NO: ————
1-SINGLE ROW
PIN Q'PY: ————
03~06
WATER CODE
0-PA66,UL94V-0
2-PA66,UL94V-2
3-LCP,UL94V-0
COLOR:
A-BLACK
S-NATURE
PLATING:
A-ALL AU G/F
C-BRIGHE TIN
D-MATTE Tin
TERMIPOINT:
1-DIP

Circuit	Dimensions(mm)	
	A	B
03	8.40	13.80
04	12.60	18.00
05	16.80	22.20
06	21.00	26.40

C4201W91-1XX1XXX

Pitch 4.20mm 90° Single row DIP Wafer

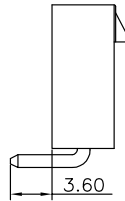
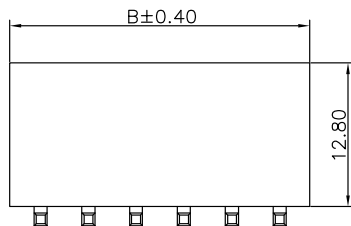
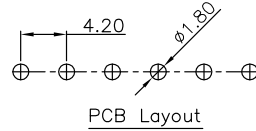
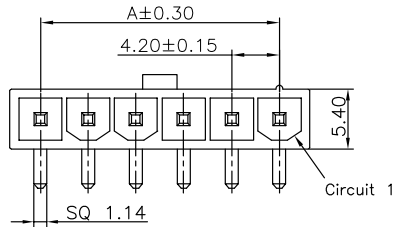

Specifications

MATERIAL SPECIFICATION:
Housing: PA66,94V-0/94V-2
Contacts: Brass

PLATING SPECIFICATION:
Contacts: Bright tin

Mates with C4201 series Male housing

SERIES NO: C4201 W 9 1-1 XX 1 X X X
CONNECTOR: W-WAFER
ANGLE: 9-90°
TYPE: 1-TYPE 1
ROW NO: 1-SINGLE ROW
PIN Q'PY: 02~06
HOUSING: 0-UL94V-0
2-UL94V-2
COLOR: A-BLACK
S-NATURE
PLATING: A-ALL AU G/F
C-BRIGHE TIN
D-MATTE Tin
TERMIPOINT: 1-DIP

Circuit	Dimensions (mm)	
	A	B
02	---	9.60
03	8.40	13.80
04	12.60	18.00
05	16.80	22.20
06	21.00	26.40

C4201W92-1XX1XXX

Pitch 4.20mm 90° Single row DIP Wafer

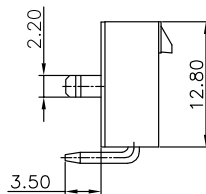
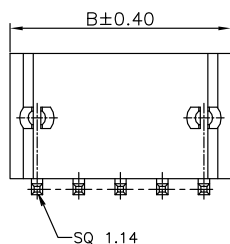
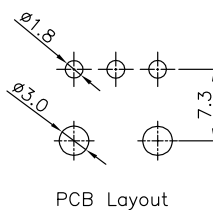
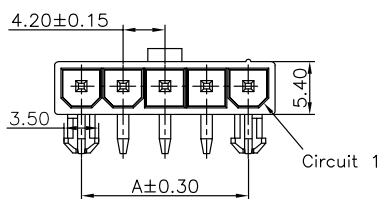

Specifications

MATERIAL SPECIFICATION:
Housing: PA66,94V-0/94V-2
Contacts: Brass

PLATING SPECIFICATION:
Contacts: Bright tin

Mates with C4201 series Male housing

SERIES NO: C4201 W 9 2-1 XX 1 X X X
CONNECTOR: W-WAFER
ANGLE: 9-90°
TYPE: 2-TYPE 2
ROW NO: 1-SINGLE ROW
PIN Q'PY: 02~06
HOUSING: 0-UL94V-0
2-UL94V-2
COLOR: A-BLACK
S-NATURE
PLATING: A-ALL AU G/F
C-BRIGHE TIN
D-MATTE Tin
TERMIPOINT: 1-DIP

Circuit	Dimensions (mm)	
	A	B
02	---	9.90
03	8.40	14.10
04	12.60	18.30
05	16.80	22.50

C4201W01-2XX1XXX

Pitch 4.20mm 180° Double row DIP Wafer

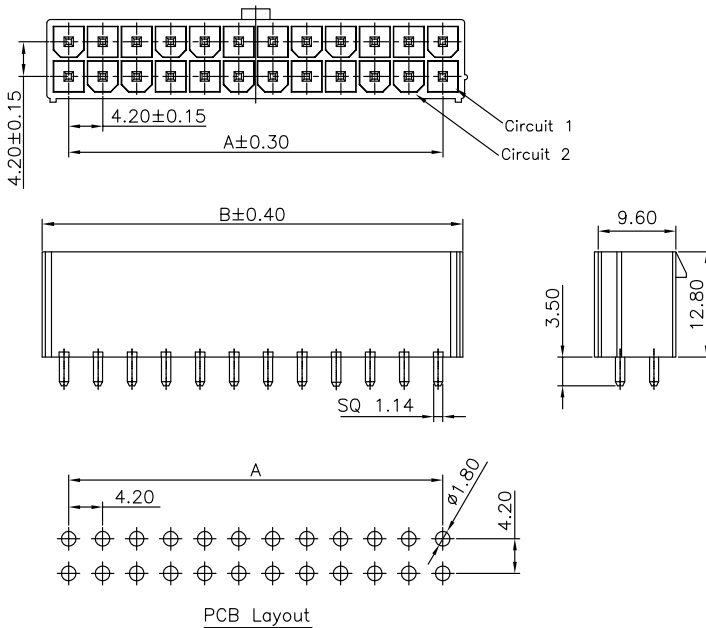

Specifications

MATERIAL SPECIFICATION:

Housing: PA66,94V-0/94V-2

Contacts: Brass

PLATING SPECIFICATION:

Contacts: Bright tin

Mates with C4201 series Male housing

SERIES NO: C4201 W 0 1-2 XX 1 X X X
 CONNECTOR: W-WAFER
 ANGLE: 0-180°
 TYPE: 1-TYPE 1
 ROW NO: 2-DOUBLE ROW
 PIN Q'PY: 02~24
 HOUSING: 0-UL94V-0, 2-UL94V-2
 COLOR: A-BLACK, S-NATURE
 PLATING: A-ALL AU G/F, C-BRIGHE TIN, D-MATTE Tin
 TERMIPOINT: 1-DIP

Circuit	Dimensions(mm)		Circuit	Dimensions(mm)	
	A	B		A	B
2*01	---	5.40	2*07	25.20	30.60
2*02	---	9.60	2*08	29.40	34.80
2*03	8.40	13.80	2*09	33.60	39.00
2*04	12.60	18.00	2*10	37.80	43.20
2*05	16.80	22.20	2*11	42.00	47.40
2*06	21.00	26.40	2*12	46.20	51.60

C4201W02-2081XXX

Pitch 4.20mm 180° Double row DIP Wafer

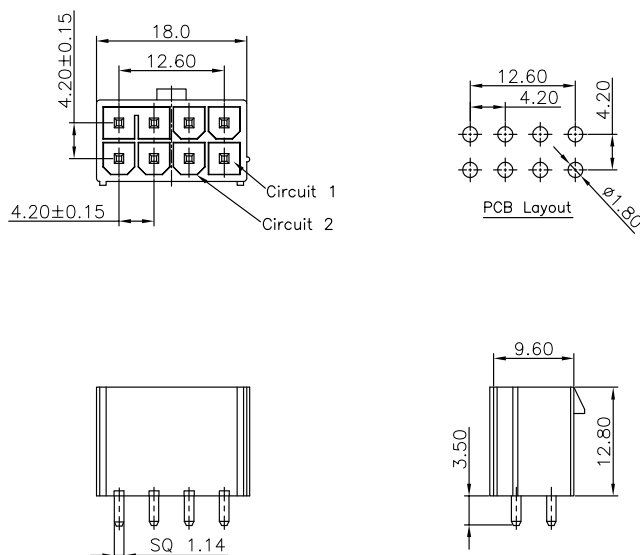

Specifications

MATERIAL SPECIFICATION:

Housing: PA66,94V-0/94V-2

Contacts: Brass

PLATING SPECIFICATION:

Contacts: Bright tin

Mates with C4201 series Male housing

SERIES NO: C4201 W 0 2-2 08 1 X X X
 CONNECTOR: W-WAFER
 ANGLE: 0-180°
 TYPE: 2-TYPE 2
 ROW NO: 2-DOUBLE ROW
 PIN Q'PY: 08 PIN
 HOUSING: 0-UL94V-0, 2-UL94V-2
 COLOR: A-BLACK, S-NATURE
 PLATING: A-ALL AU G/F, C-BRIGHE TIN, D-MATTE Tin
 TERMIPOINT: 1-DIP

C4201W03-2XX1XXX

Pitch 4.20mm 180° Double row DIP Wafer

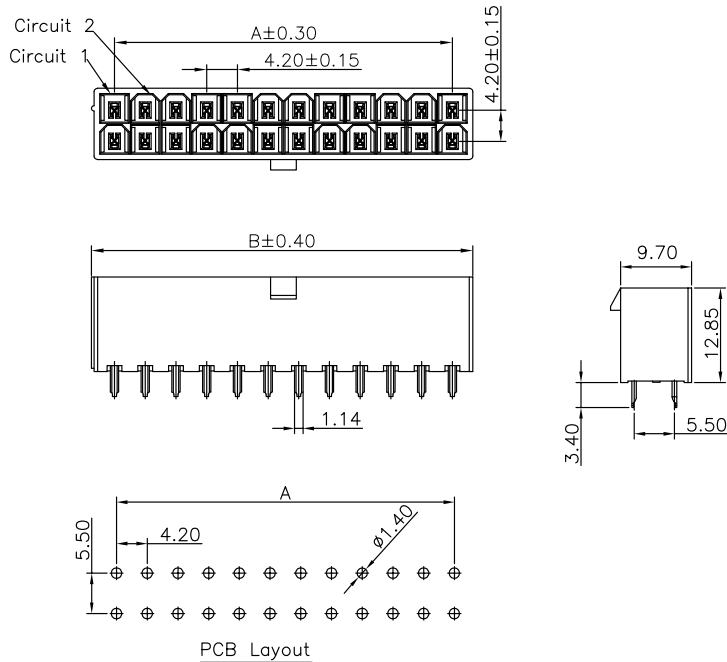

Specifications

MATERIAL SPECIFICATION:

Housing: PA66/LCP,94V-0/94V-2
Contacts: Brass

PLATING SPECIFICATION:

Contacts: Bright tin

Mates with C4201 series Male housing

SERIES NO: C4201 W 0 3-2 XX 1 X X X
CONNECTOR: W-WAFER
ANGLE: 0-180°
TYPE: 3-TYPE 3
ROW NO: 2-DOUBLE ROW
PIN Q' PY: 02~24

HOUSING:
0-PA66,UL94V-0
2-PA66,UL94V-2
3-LCP,UL94V-0
COLOR:
A-BLACK
S-NATURE
PLATING:
A-ALL AU G/F
C-BRIGHE TIN
D-MATTE Tin
TERMIPOINT:
1-DIP

Circuit	Dimensions(mm)		Circuit	Dimensions(mm)	
	A	B		A	B
2*01	---	5.60	2*07	25.20	30.80
2*02	---	9.80	2*08	29.40	35.00
2*03	8.40	14.00	2*09	33.60	39.20
2*04	12.60	18.20	2*10	37.80	43.40
2*05	16.80	22.40	2*11	42.00	47.60
2*06	21.00	26.60	2*12	46.20	51.80

C4201W04-2XX1XXX

Pitch 4.20mm 180° Double row DIP Wafer

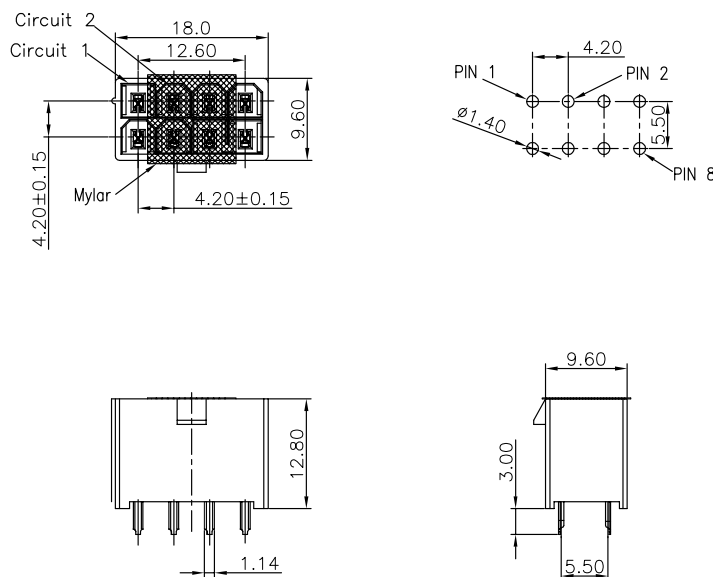

Specifications

MATERIAL SPECIFICATION:

Housing: PA66/LCP,94V-0/94V-2
Contacts: Brass

PLATING SPECIFICATION:

Contacts: Bright tin

Mates with C4201 series Male housing

SERIES NO: C4201 W 0 4-2 XX 1 X X X
CONNECTOR: W-WAFER
ANGLE: 0-180°
TYPE: 4-TYPE 4
ROW NO: 2-DOUBLE ROW
PIN Q' PY: 02~24

HOUSING:
0-PA66,UL94V-0
2-PA66,UL94V-2
3-LCP,UL94V-0
COLOR:
A-BLACK
S-NATURE
PLATING:
A-ALL AU G/F
C-BRIGHE TIN
D-MATTE Tin
TERMIPOINT:
1-DIP

C4201W05-2XX1XXX

Pitch 4.20mm 180° Double row DIP Wafer

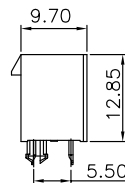
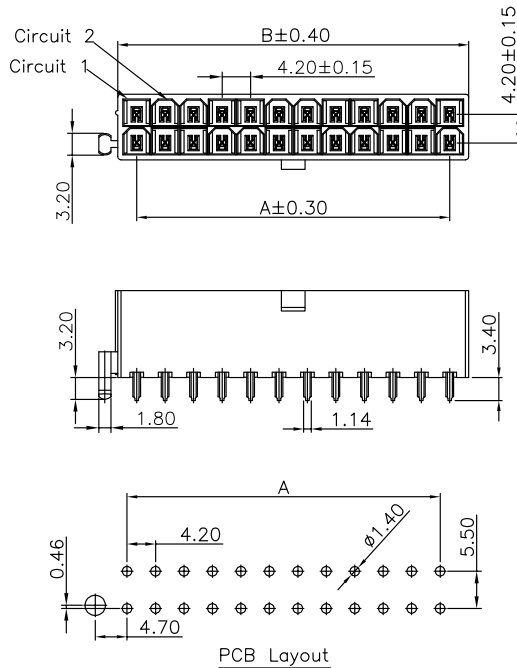

Specifications

MATERIAL SPECIFICATION:

Housing: PA66/LCP,94V-0/94V-2

Contacts: Brass

PLATING SPECIFICATION:

Contacts: Bright tin

Mates with C4201 series Male housing

SERIES NO: C4201 W 0 5-2 XX 1 X X X
 CONNECTOR: W-WAFER
 ANGLE: 0-180°
 TYPE: 5-TYPE 5
 ROW NO: 2-DOUBLE ROW
 PIN Q'PY: 02~24
 HOUSING:
 0-PA66,UL94V-0
 2-PA66,UL94V-2
 3-LCP,UL94V-0
 COLOR:
 A-BLACK
 S-NATURE
 PLATING:
 A-ALL AU G/F
 C-BRIGHE TIN
 D-MATTE Tin
 TERMIPOINT:
 1-DIP

Circuit	Dimensions(mm)		Circuit	Dimensions(mm)	
	A	B		A	B
2*01	---	5.60	2*07	25.20	30.80
2*02	---	9.80	2*08	29.40	35.00
2*03	8.40	14.00	2*09	33.60	39.20
2*04	12.60	18.20	2*10	37.80	43.40
2*05	16.80	22.40	2*11	42.00	47.60
2*06	21.00	26.60	2*12	46.20	51.80

C4201W06-2XX1XXX

Pitch 4.20mm 180° Double row DIP Wafer

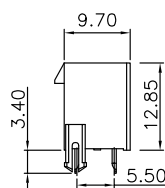
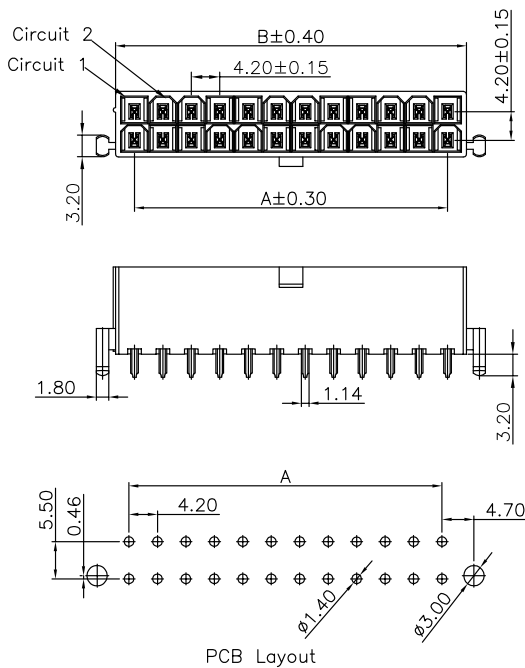

Specifications

MATERIAL SPECIFICATION:

Housing: PA66/LCP,94V-0/94V-2

Contacts: Brass

PLATING SPECIFICATION:

Contacts: Bright tin

Mates with C4201 series Male housing

SERIES NO: C4201 W 0 6-2 XX 1 X X X
 CONNECTOR: W-WAFER
 ANGLE: 0-180°
 TYPE: 6-TYPE 6
 ROW NO: 2-DOUBLE ROW
 PIN Q'PY: 02~24
 HOUSING:
 0-PA66,UL94V-0
 2-PA66,UL94V-2
 3-LCP,UL94V-0
 COLOR:
 A-BLACK
 S-NATURE
 PLATING:
 A-ALL AU G/F
 C-BRIGHE TIN
 D-MATTE Tin
 TERMIPOINT:
 1-DIP

Circuit	Dimensions(mm)		Circuit	Dimensions(mm)	
	A	B		A	B
2*01	---	5.60	2*07	25.20	30.80
2*02	---	9.80	2*08	29.40	35.00
2*03	8.40	14.00	2*09	33.60	39.20
2*04	12.60	18.20	2*10	37.80	43.40
2*05	16.80	22.40	2*11	42.00	47.60
2*06	21.00	26.60	2*12	46.20	51.80

C4201W07-2XX1XXX

Pitch 4.20mm 180° Double row DIP Wafer

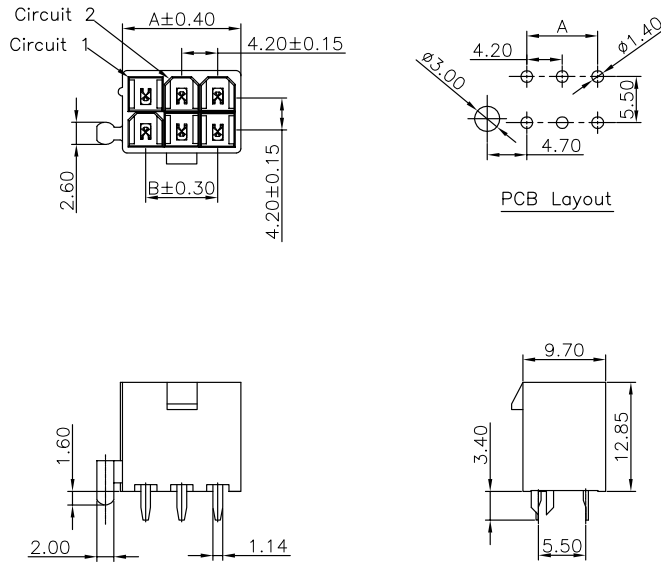

Specifications

MATERIAL SPECIFICATION:

Housing: PA66/LCP,94V-0/94V-2

Contacts: Brass

PLATING SPECIFICATION:

Contacts: Bright tin

Mates with C4201 series Male housing

SERIES NO: C4201 W 0 7-2 XX 1 X X X
 CONNECTOR: W-WAFER
 ANGLE: 0-180°
 TYPE: 7-TYPE 7
 ROW NO: 2-DOUBLE ROW
 PIN Q'PY: 02~24
 HOUSING:
 0-PA66,UL94V-0
 2-PA66,UL94V-2
 3-LCP,UL94V-0
 COLOR:
 A-BLACK
 S-NATURE
 PLATING:
 A-ALL AU G/F
 C-BRIGHE TIN
 D-MATTE Tin
 TERMIPOINT:
 1-DIP

Circuit	Dimensions(mm)		Circuit	Dimensions(mm)	
	A	B		A	B
2*01	---	5.60	2*07	25.20	30.80
2*02	---	9.80	2*08	29.40	35.00
2*03	8.40	14.00	2*09	33.60	39.20
2*04	12.60	18.20	2*10	37.80	43.40
2*05	16.80	22.40	2*11	42.00	47.60
2*06	21.00	26.60	2*12	46.20	51.80

C4201W08-2161XXX

Pitch 4.20mm 180° Double row DIP Wafer

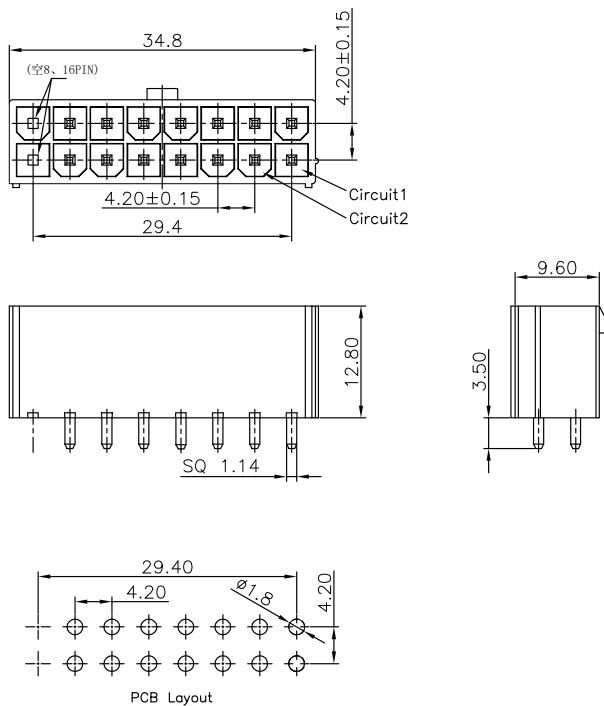

Specifications

MATERIAL SPECIFICATION:

Housing: PA66,94V-0/94V-2

Contacts: Brass

PLATING SPECIFICATION:

Contacts: Bright tin

Mates with C4201 series Male housing

SERIES NO: C4201 W 0 8-2 16 1 X X X
 CONNECTOR: W-WAFER
 ANGLE: 0-180°
 TYPE: 8-TYPE 8
 ROW NO: 2-DOUBLE ROW
 PIN Q'PY: 16 PIN
 HOUSING:
 0-UL94V-0
 2-UL94V-2
 COLOR:
 A-BLACK
 S-NATURE
 PLATING:
 A-ALL AU G/F
 C-BRIGHE TIN
 D-MATTE Tin
 TERMIPOINT:
 1-DIP

C4201W91-2XX1XXX

Pitch 4.20mm 90° Double row DIP Wafer

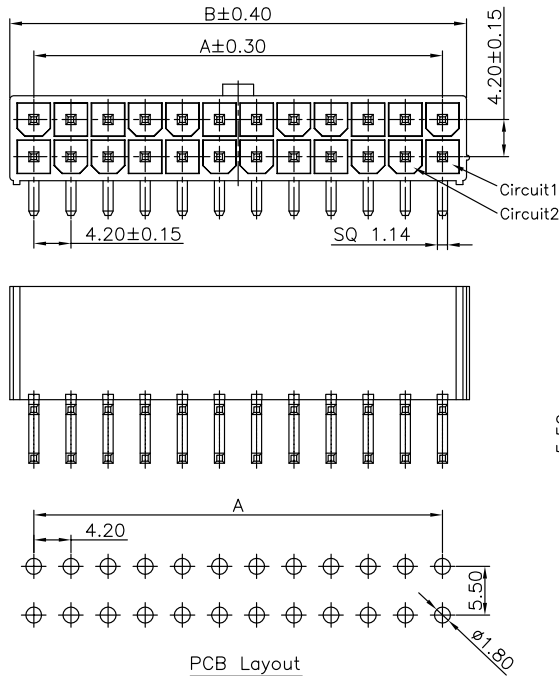

Specifications

MATERIAL SPECIFICATION:

Housing: PA66,94V-0/94V-2

Contacts: Brass

PLATING SPECIFICATION:

Contacts: Bright tin

Mates with C4201 series Male housing

SERIES NO: C4201 W 9 1-2 XX 1 X X X
 CONNECTOR: W-WAFER
 ANGLE: 9-90°
 TYPE: 1-TYPE 1
 ROW NO: 2-DOUBLE ROW
 PIN Q'PY: 02~24
 HOUSING: 0-UL94V-0, 2-UL94V-2
 COLOR: A-BLACK, S-NATURE
 PLATING: A-ALL AU G/F, C-BRIGHE TIN, D-MATTE Tin
 TERMIPOINT: 1-DIP

Circuit	Dimensions(mm)		Circuit	Dimensions(mm)	
	A	B		A	B
2*01	---	5.40	2*07	25.20	30.60
2*02	---	9.60	2*08	29.40	34.80
2*03	8.40	13.80	2*09	33.60	39.00
2*04	12.60	18.00	2*10	37.80	43.20
2*05	16.80	22.20	2*11	42.00	47.40
2*06	21.00	26.40	2*12	46.20	51.60

C4201W93-2XX1XXX

Pitch 4.20mm 90° Double row DIP Wafer

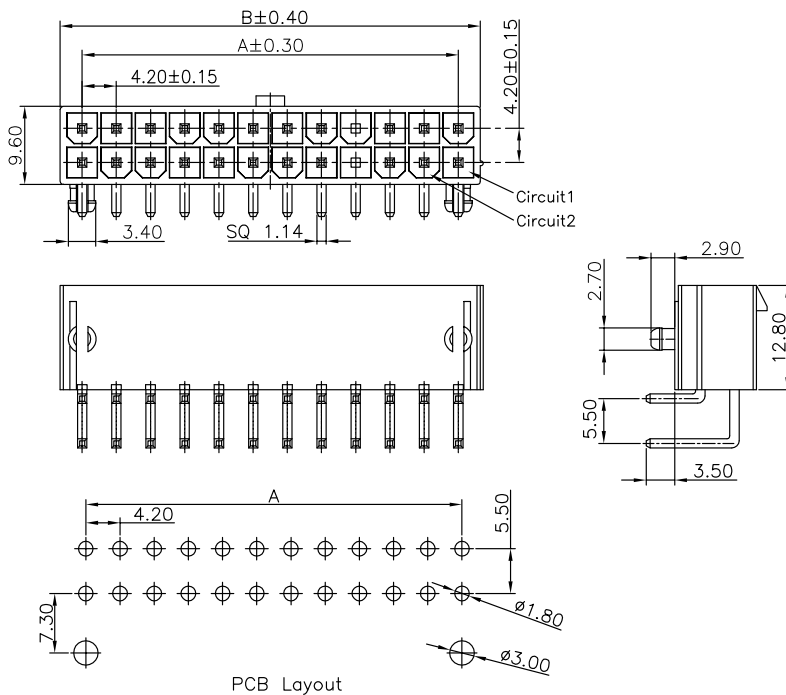

Specifications

MATERIAL SPECIFICATION:

Housing: PA66,94V-0/94V-2

Contacts: Brass

PLATING SPECIFICATION:

Contacts: Bright tin

Mates with C4201 series Male housing

SERIES NO: C4201 W 9 3-2 XX 1 X X X
 CONNECTOR: W-WAFER
 ANGLE: 9-90°
 TYPE: 3-TYPE 3
 ROW NO: 2-DOUBLE ROW
 PIN Q'PY: 02~24
 HOUSING: 0-UL94V-0, 2-UL94V-2
 COLOR: A-BLACK, S-NATURE
 PLATING: A-ALL AU G/F, C-BRIGHE TIN, D-MATTE Tin
 TERMIPOINT: 1-DIP

Circuit	Dimensions(mm)		Circuit	Dimensions(mm)	
	A	B		A	B
2*01	---	5.40	2*07	25.20	30.60
2*02	---	9.60	2*08	29.40	34.80
2*03	8.40	13.80	2*09	33.60	39.00
2*04	12.60	18.00	2*10	37.80	43.20
2*05	16.80	22.20	2*11	42.00	47.40
2*06	21.00	26.40	2*12	46.20	51.60

C4201W94-2XX1XXX

Pitch 4.20mm 90° Double row DIP Wafer

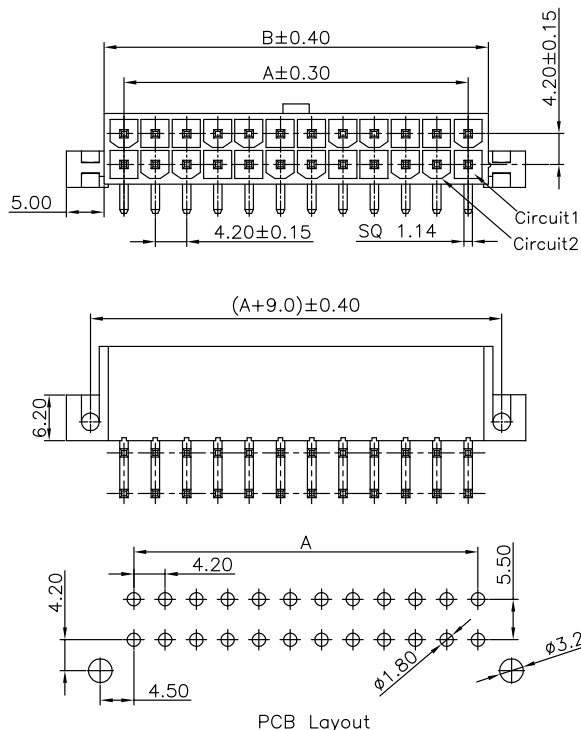

Specifications

MATERIAL SPECIFICATION:

Housing: PA66,94V-0/94V-2

Contacts: Brass

PLATING SPECIFICATION:

Contacts: Bright tin

Mates with C4201 series Male housing

SERIES NO: C4201 W 9 4-2 XX 1 X X X
 CONNECTOR: W-WAFER
 ANGLE: 9-90°
 TYPE: 4-TYPE 4
 ROW NO: 2-DOUBLE ROW
 PIN Q'PY: 02~24
 HOUSING: 0-UL94V-0, 2-UL94V-2
 COLOR: A-BLACK, S-NATURE
 PLATING: A-ALL AU G/F, C-BRIGHE TIN, D-MATTE Tin
 TERMIPOINT: 1-DIP

Circuit	Dimensions(mm)		Circuit	Dimensions(mm)	
	A	B		A	B
2*01	---	5.40	2*07	25.20	30.60
2*02	---	9.60	2*08	29.40	34.80
2*03	8.40	13.80	2*09	33.60	39.00
2*04	12.60	18.00	2*10	37.80	43.20
2*05	16.80	22.20	2*11	42.00	47.40
2*06	21.00	26.40	2*12	46.20	51.60

C4201W92-2XX1XX3

Pitch 4.20mm 90° Double row DIP Wafer

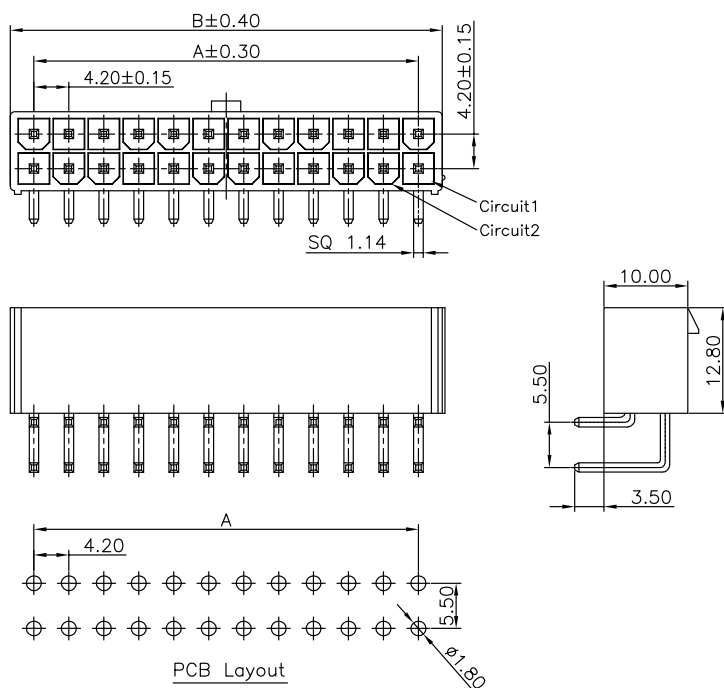

Specifications

MATERIAL SPECIFICATION:

Housing: LCP,94V-0

Contacts: Brass

PLATING SPECIFICATION:

Contacts: Bright tin

Mates with C4201 series Male housing

SERIES NO: C4201 W 9 2-2 XX 1 X X 3
 CONNECTOR: W-WAFER
 ANGLE: 9-90°
 TYPE: 2-TYPE 2
 ROW NO: 2-DOUBLE ROW
 PIN Q'PY: 02~24
 COLOR: A-BLACK, S-NATURE
 PLATING: A-ALL AU G/F, C-BRIGHE TIN, D-MATTE Tin
 TERMIPOINT: 1-DIP

Circuit	Dimensions(mm)		Circuit	Dimensions(mm)	
	A	B		A	B
2*01	---	5.70	2*07	25.20	30.90
2*02	---	9.90	2*08	29.40	35.10
2*03	8.40	14.10	2*09	33.60	39.30
2*04	12.60	18.30	2*10	37.80	43.50
2*05	16.80	22.50	2*11	42.00	47.70
2*06	21.00	26.70	2*12	46.20	51.90