

RoHS

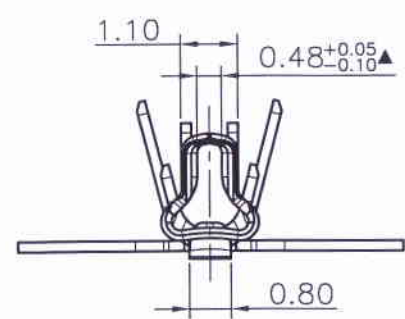
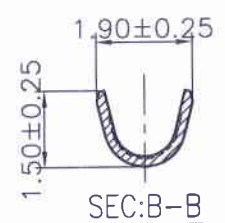
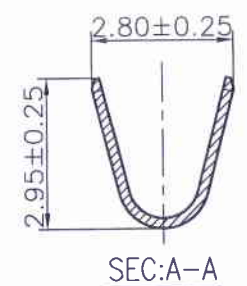
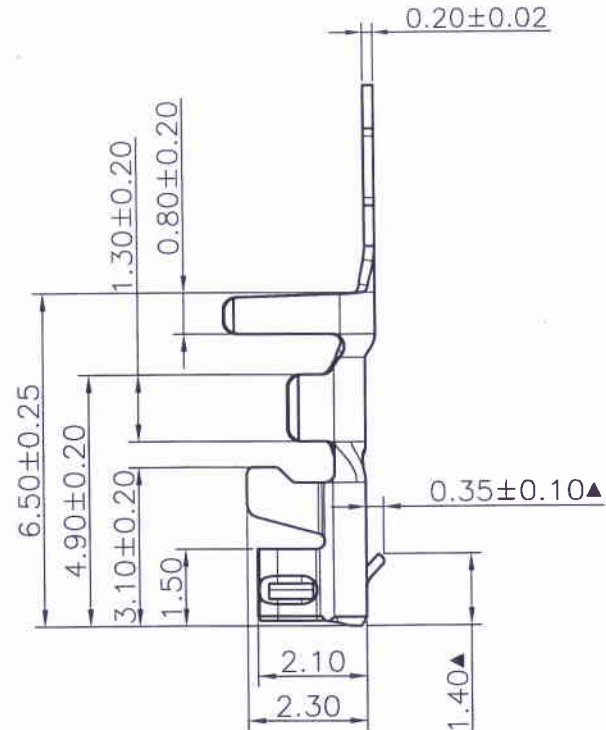
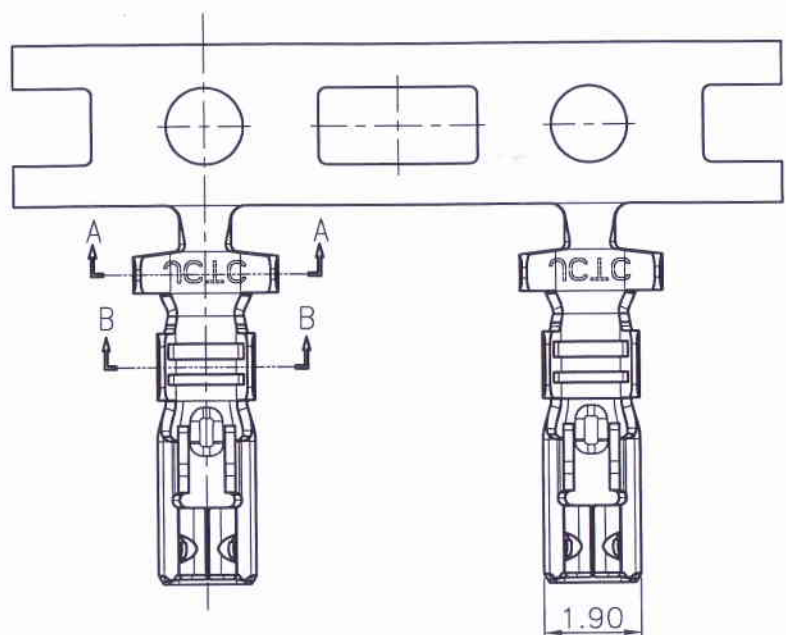

Note: 12505TOP-XX

Finish _____
 2E—Stamping before Tin-plated
 5A—Gold-flash 5B—2u”Au 5C—3u”Au 5E—5u”Au
 5G—15u”Au 5H—30u”Au
 0A—Gold-flash 0B—2u”Au 0C—3u”Au 0E—5u”Au
 0G—15u”Au 0H—30u”Au

Part No.	Wire Range	Insulation O.D.	Material	Finish	Qty/reel
12505TOP-2E	AWG #22~#28	1.90mm(max)	Phosphor Bronze	Tin-plated	8,000 pcs
12505TOP-0X	AWG #22~#28	1.90mm(max)	Phosphor Bronze	Gold-plated contact area	8,000 pcs
12505TOP-5X	AWG #22~#28	1.90mm(max)	Phosphor Bronze	Gold-plated over all	8,000 pcs

REV.	REVISION RECORD	DATE	UNIT	GENERAL TOLERANCES	SCALE:	NAME	DATE	PART. NO: 12505TOP-XX
C0	新图面发行	14.06.25	MM	LINEAR	1:1	APPROVED: [Signature]	17.03.28	
C1	更新公司名称	17.03.28		ANGLES	APPROVED: [Signature]			
			SIZE: A4	0.00±0.15 X° ±3°	DESIGNER: [Signature]	TITLE: XA 2.50 Terminal		REV: C1 SHEET: 1/1
				0.00±0.08 X° X'±2°	DRAWN: 伍文聪			

JGTC 胜蓝科技股份有限公司
 TERMINAL&CONNECTORS 东莞市富智达电子科技有限公司