

RoHS

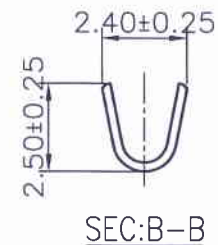
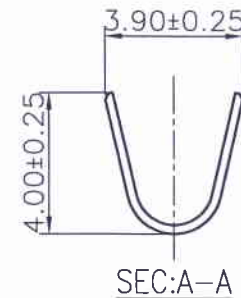
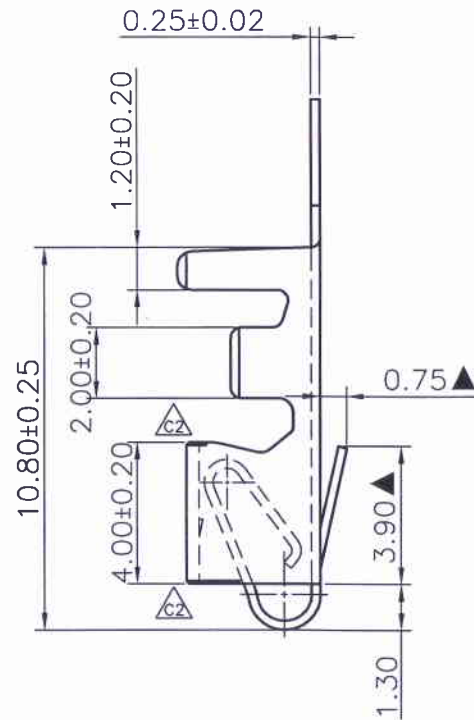
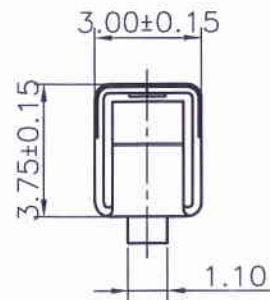
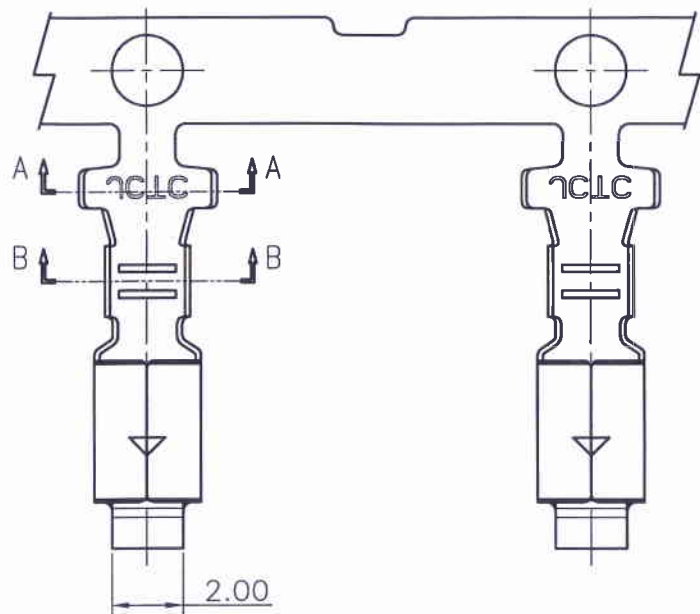

Note: 13962T0B-2E

Finish \_\_\_\_\_  
2E--Stamping before Tin-plated

Part No.	Wire Range	Insulation O.D.	Material	Finish	Qty/reel
13962T0B-2E	AWG #18~#22	2.80mm(max)	Brass	Ni 30u"Min. Tin-plated 60u"Min.	3,000 pcs

REV.	REVISION RECORD	DATE	UNIT: MM	SIZE: A4	GENERAL TOLERANCES		SCALE: 1:1	NAME	DATE	PART. NO: 13962T0B-2E
					LINER	ANGLES				
C1	HN1311010151	13.11.01			0.0±0.25	X° REF±6°				DWG. NO: ENDE05
C2	增加C角	13.11.11			0.00±0.15	X° ±3°				REV: C4
C3	修改每盘包装数量	14.07.29			0.000±0.08	X° X'±2°				SHEET: 1/1
C4	变更公司名称	17.03.07						卢小锋	17.03.07	

**JCTC** 胜蓝科技股份有限公司  
TERMINAL&CONNECTORS 东莞市富智达电子科技有限公司  
TITLE: 3.96mm PITCH Terminal