

RoHS

Specifications:
 Rated Voltage : 250V AC/DC
 Rated Current : 2A AC,DC
 Withstand Voltage : 1000V AC/minute
 Contact Resistance : 10mΩ(MAX.)
 Insulation Resistance : 1000MΩ(MIN.)
 Temperature Range : -25°C~+85°C

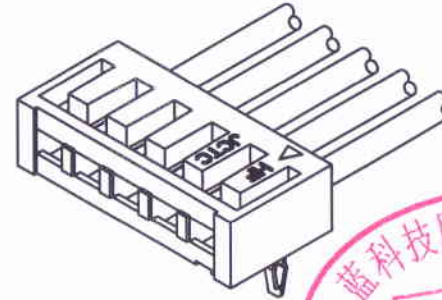

Dimensional Ordering Information:

Circuits Part No	Dimensions	
	A	B
2P	2.50	5.60
3P	5.00	8.10
4P	7.50	10.60
5P	10.00	13.10
6P	12.50	15.60
7P	15.00	18.10
8P	17.50	20.60
9P	20.00	23.10
10P	22.50	25.60
11P	25.00	28.10
12P	27.50	30.60
13P	30.00	33.10
14P	32.50	35.60
15P	35.00	38.10
16P	37.50	40.60

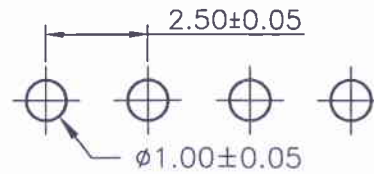
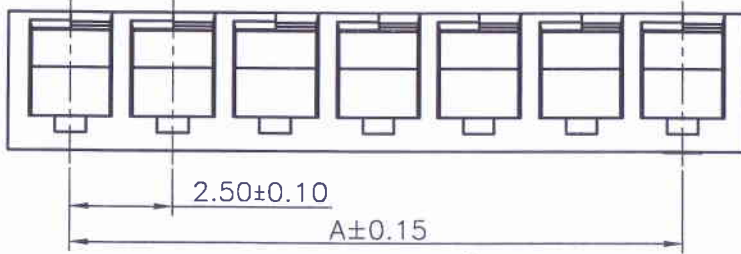
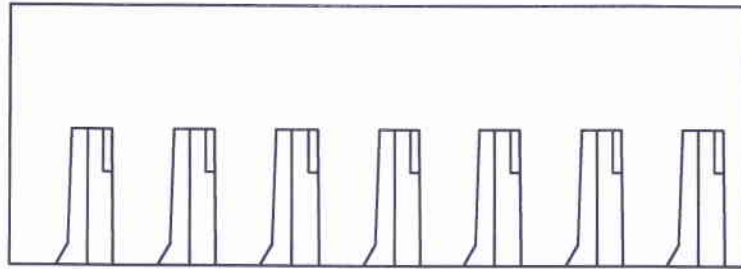

P.C.B LAYOUT

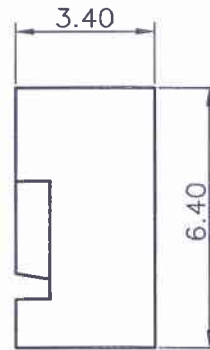

22501H90-NPA-HF-NK
 ① ② ③④ ⑤ ⑥

- ① Series No.
- ② H90 : Side Contact
H00 : Up Contact
- ③ No. of Circuits
- ④ A : Product color(A--Y)
Blank : Natural type
- ⑤ HF : Halogen Free
- ⑥ NK : No Mark
Blank : Mark

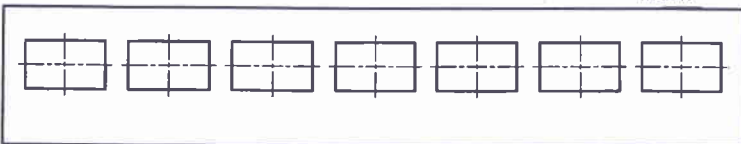
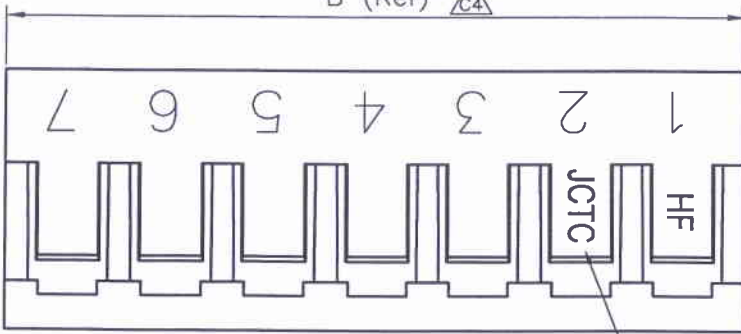

Suitable for JCTC 22501 series terminal

Part No.	Material	Color
22501H90-NP	Nylon 66,UL94V-0	本色
22501H90-NP-NK	Nylon 66,UL94V-0	本色
22501H90-NP-HF	Nylon 66,UL94V-0	无卤本色
22501H90-NP-HF-NK	Nylon 66,UL94V-0	无卤本色
22501H90-NPA-HF	Nylon 66,UL94V-0	黑色无卤

REV.	REVISION RECORD	DATE	GENERAL TOLERANCES	SCALE:	NAME	DATE	JCTC ® 胜蓝科技股份有限公司 TERMINAL&CONNECTORS 东莞市富智达电子科技有限公司 TITLE: SCN 2.50mm Pitch Housing	PART. NO:
C2	去掉“△”PIN标示	10.10.21	LINEAR	1:1				22501H90-NPX-XX-XX
C3	HR1105280083	11.05.28	ANGLES	APPROVED				DWG. NO:
C4	“B”尺寸改为参考尺寸	16.02.22	0.0±0.25 X° REF±6°	DESIGNER				ENDE05
C5	更新公司名称	17.03.18	0.00±0.15 X° ±3°	DRAWN	伍文聪	17.03.18		REV: C5 SHEET: 1/1