

环保物料

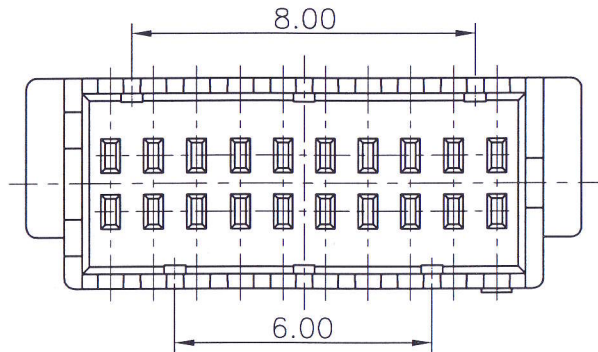
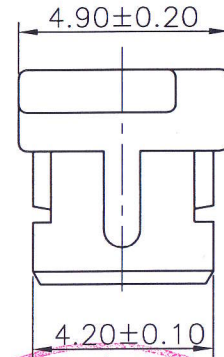
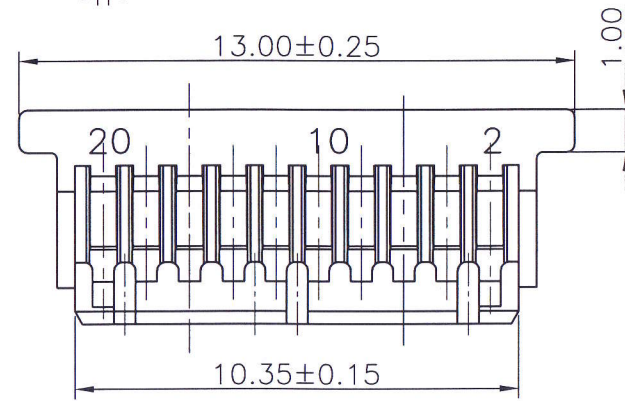
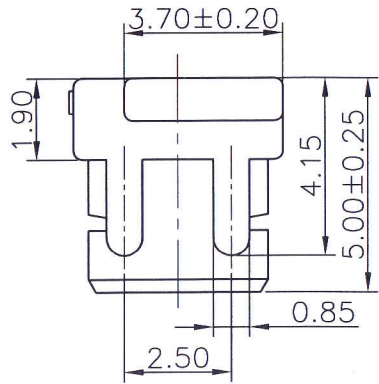
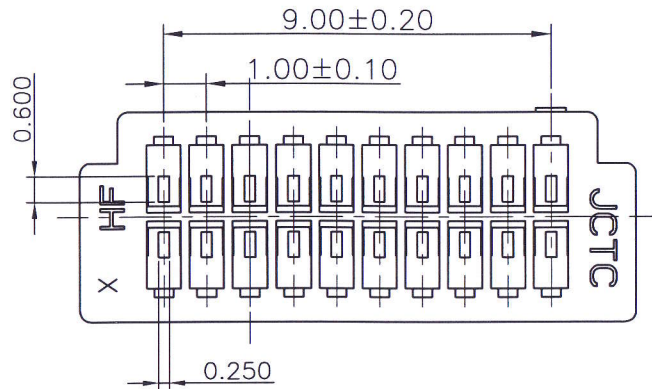

Specifications:  
 Rated Voltage : 50V AC/DC  
 Rated Current : 1A AC,DC  
 Withstand Voltage : 500V AC/minute  
 Contact Resistance : 20mΩ(MAX.)  
 Insulation Resistance : 100MΩ(MIN.)  
 Temperature Range : -25°C~+85°C

11002H00-2X10PA-HF-S1  
 ① ② ③ ④ ⑤ ⑥

- ① Series No.
- ② H90 : Side Contact  
H00 : Up Contact
- ③ No. of Circuits
- ④ A: Product color (A--Y)
- ⑤ HF : Halogen Free
- ⑥ S1: S1 TYPE



Suitable for JCTC 11002 series terminal

| Part No.              | Material         | Color |
|-----------------------|------------------|-------|
| 11002H00-2X10PA-HF-S1 | Nylon 66,UL94V-0 | Black |

| REV. | REVISION RECORD | DATE     | GENERAL TOLERANCES |            | SCALE:   | NAME               | DATE               |
|------|-----------------|----------|--------------------|------------|----------|--------------------|--------------------|
| C0   | 新图面发行           | 14.05.04 | LINER              | ANGLES     | 1:1      |                    |                    |
|      |                 |          | 0.0±0.25           | X° REF±6°  | APPROVED | <i>[Signature]</i> | 14.5.4             |
|      |                 |          | UNIT: MM           | 0.00±0.15  | X° ±3°   | DESIGNER           | <i>[Signature]</i> |
|      |                 |          | SIZE: A4           | 0.000±0.08 | X° X'±2° | DRAWN              | 邓群庄 14.05.04       |

**JCTC**®  
 TERMINAL&CONNECTORS  
 TITLE: JST 1.0mm PITCH 双排 Housing

苏州伟聚     东莞胜景  
 东莞胜蓝     东莞富强

|                                   |            |
|-----------------------------------|------------|
| PART. NO:<br>11002H00-2X10P-HF-S1 |            |
| DWG. NO:<br>ENDE05                |            |
| REV: C0                           | SHEET: 1/1 |