

环保物料

2~3P单卡槽

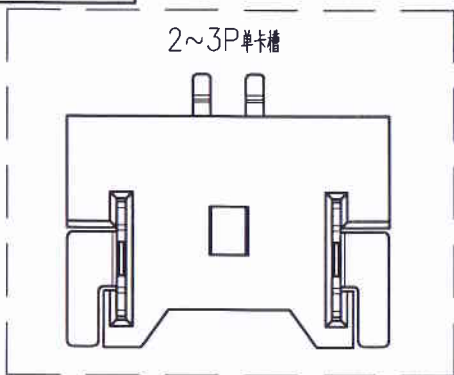

0.4±0.10 A±0.20 1.25±0.10

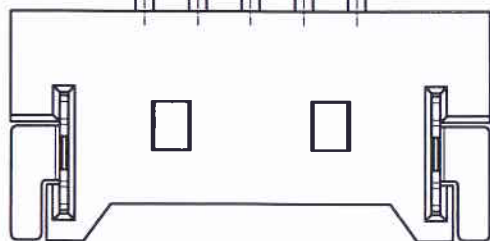

4~30P双卡槽

B±0.25

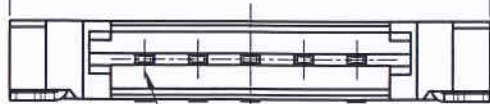

Circuit 1

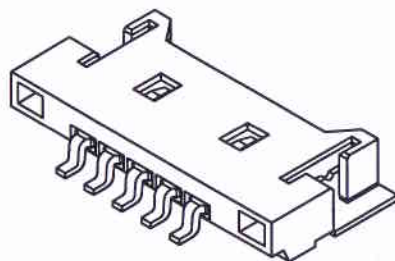

2.20±0.10 A±0.10 1.25±0.10 0.80±0.05

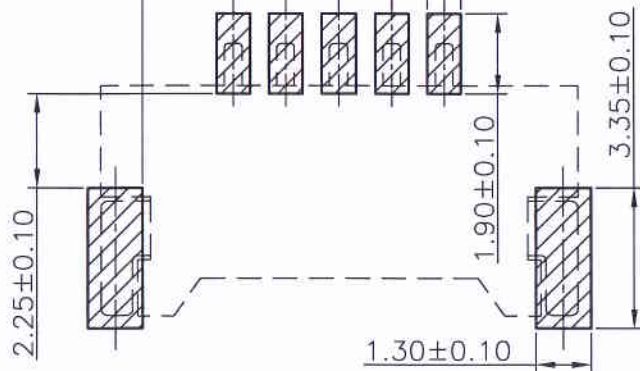

P.C.B. LAYOUT

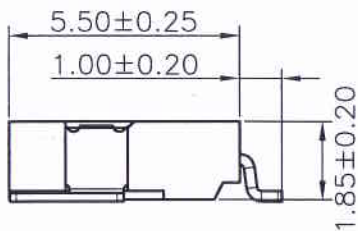

SPECIFICATIONS
 Current Rating: 1A AC,DC
 Voltage Rating: 125V AC,DC
 Temperature Range: -25°C ~ +85°C
 Contact Resistance: 20mΩ Max.
 Insulation Resistance: 100MΩ Min.
 Withstanding Voltage: 500V AC/minute
 Contact: Phosphor Bronze/Gold Flash
 Solder Tabs: Brass/Gold Flash
 Insulator: Thermal Plasticity Resin, UL 94V-0
 Halogen Free

11255W90-NP-S-H1-5A-HF-NK-R
 ① ② ③ ④ ⑤ ⑥ ⑦ ⑧ ⑨

- ① Series No.
- ② W00 : Up Contact
- ③ No. of Circuits
- ④ S : SMT Type
- ⑤ High temperature plastic
- ⑥ Plating code for contacts:
 5A : Gold-flash
- ⑦ HF : Halogen Free
- ⑧ NK : No Mark
- ⑨ R : Reel Packaging

Circuits	Dimensions	
	A	B
2P	--	7.65
3P	2.50	8.90
4P	3.75	10.15
5P	5.00	11.40
6P	6.25	12.65
7P	7.50	13.90
8P	8.75	15.15
9P	10.00	16.40
10P	11.25	17.65



Part No.	Material	Color	Pin Material	Solder Tabs
11255W90-NP-S-H1-5A-HF-R	High temperature plastic,UL94V-0	Natural	Phosphor Bronze/Gold-flash	Brass/Gold-flash

REV.	REVISION RECORD	DATE		GENERAL TOLERANCES		SCALE:	NAME	DATE	<input type="checkbox"/> 苏州伟聚 <input type="checkbox"/> 东莞胜景 <input checked="" type="checkbox"/> 东莞胜蓝	PART. NO:
A0	新图面发行	15.10.09		L:LINEAR	ANGLES	1:1				APPROVED
			UNIT: MM	0.0±0.25	X° REF±6°	DESIGNER	15.10.09	TITLE:	DWG. NO:	
			SIZE: A4	0.00±0.15	X° ±3°	DRAWN	邓群庄	1.25mm PITCH 90° SMT TYPE WAFER	ENDE05	
				0.000±0.08	X° X'±2°			REV: A0	SHEET: 1/2	

环保物料

2~8 Contacts

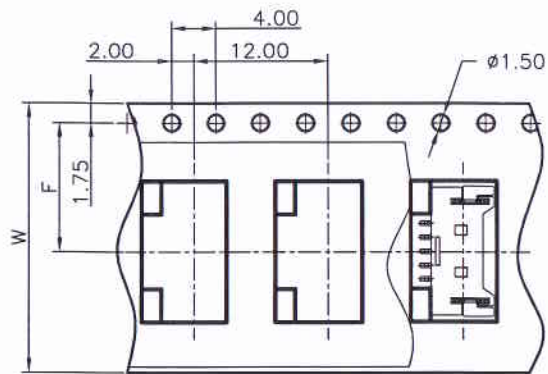

Unreeling direction →

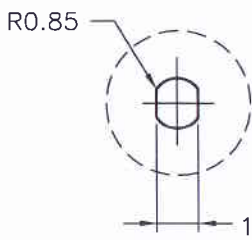

9~10 Contacts

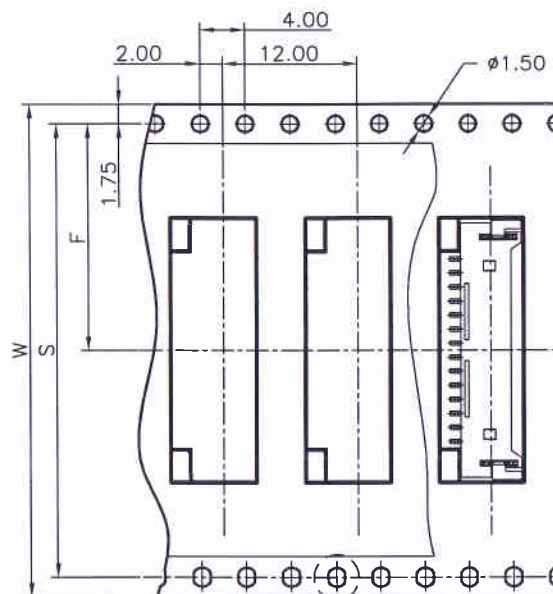

Unreeling direction →

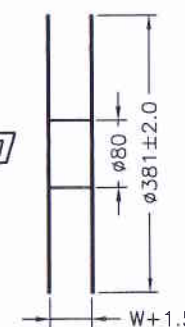
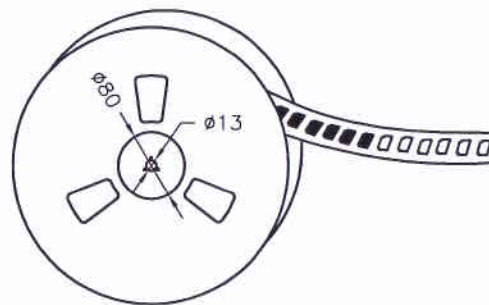
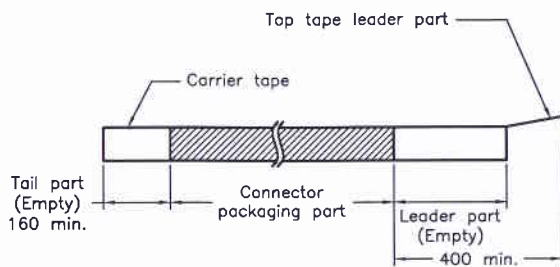

Number of Contacts	W±0.3	F±0.1	S±0.1	Q'ty/Reel
2P	16	7.50	--	2,000
3~8P	24	11.50	--	2,000
9~10P	32	14.20	28.40	2,000

REV.	REVISION RECORD	DATE	GENERAL TOLERANCES	SCALE: 1:1	NAME	DATE	PART. NO:
A0	新图面发行	15.10.09	LINEAR 0.0±0.25	APPROVED	陈永发	15.10.09	11255W90-NP-S-H1-XX-HF-NK-R
			ANGLES 0.00±0.15	DESIGNER	王立群	15.10.09	DWG. NO: ENDE05
			0.00±0.08	DRAWN	邓群庄	15.10.09	REV: A0 SHEET: 2/2

JCTC® 苏州伟聚 东莞胜景
TERMINAL&CONNECTORS 东莞胜蓝

TITLE: 1.25mm PITCH 90° SMT TYPE WAFER