

ROHS

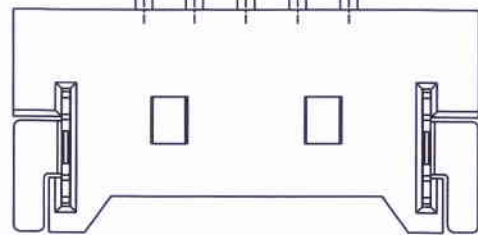

4~30P双卡槽

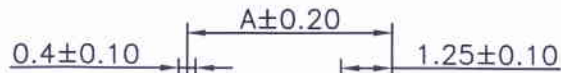
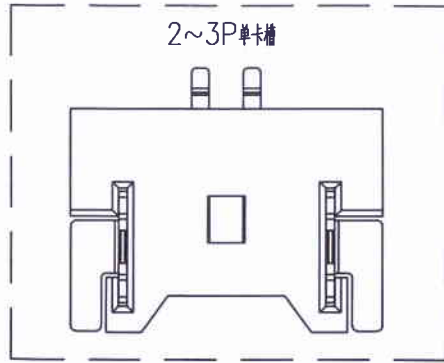
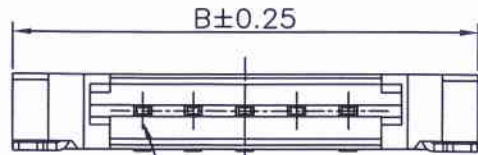

Circuit 1

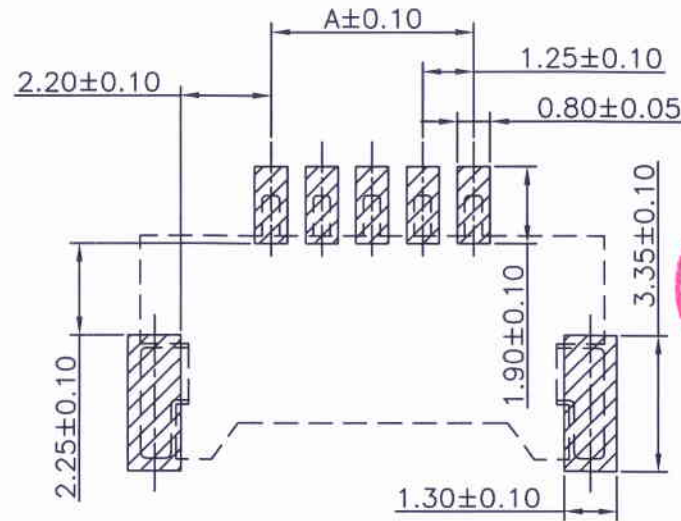
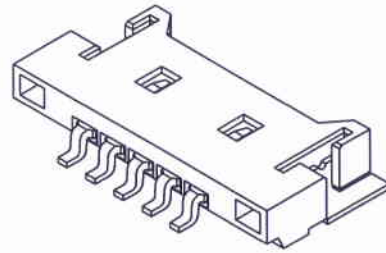

P.C.B. LAYOUT

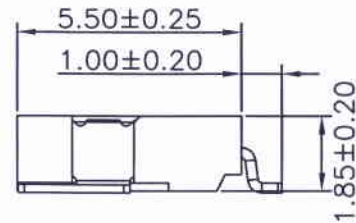

SPECIFICATIONS  
 Current Rating: 1A AC,DC  
 Voltage Rating: 125V AC,DC  
 Temperature Range: -25°C ~ +85°C  
 Contact Resistance: 20mΩ Max.  
 Insulation Resistance: 100MΩ Min.  
 Withstanding Voltage: 500V AC/minute  
 Contact: Phosphor Bronze/Matte Tin-plated  
 Solder Tabs: Brass/Matte Tin-plated  
 Insulator: Thermal Plasticity Resin, UL 94V-0  
 Halogen Free



Circuits	Dimensions	
	A	B
2P	--	7.65
3P	2.50	8.90
4P	3.75	10.15
5P	5.00	11.40
6P	6.25	12.65
7P	7.50	13.90
8P	8.75	15.15
9P	10.00	16.40
10P	11.25	17.65
11P	12.50	18.90
12P	13.75	20.15
14P	16.25	22.65
15P	17.50	23.90
16P	18.75	25.15
20P	23.75	30.15
30P	36.25	42.65

11255W90-NP X-S-HF-NK  
 ① ② ③ ④ ⑤ ⑥ ⑦

- ① Series No.
- ② W00 : Up Contact
- ③ No. of Circuits
- ④ X : Product color(A--Y)  
A : Black
- ⑤ S : SMT Type
- ⑥ HF : Halogen Free
- ⑦ NK : No Mark

REV.	REVISION RECORD	DATE	GENERAL TOLERANCES	SCALE:	NAME	DATE
C0	新图面发行	13.06.18	LINEAR	1:1		
C1	变更公司名称	17.04.05	0.0±0.25	APPROVED		
			0.00±0.15	DESIGNER		
			0.000±0.08	DRAWN		

**JCTC** 胜蓝科技股份有限公司

TERMINAL&CONNECTORS 东莞市富智达电子科技有限公司

TITLE: 1.25mm PITCH 90° SMT TYPE WAFER

PART. NO: 11255W90-NPX-S-HF-NK

DWG. NO: ENDE05

REV: C1 SHEET: 1/2

ROHS

2~8 Contacts

9~30 Contacts

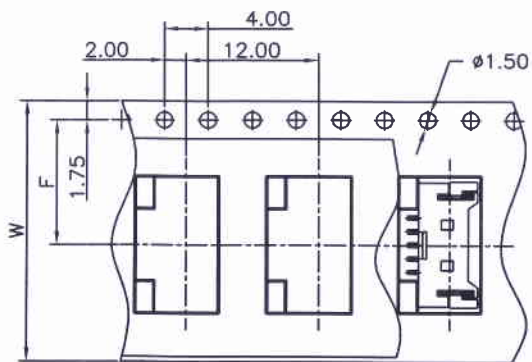

Unreeling direction →

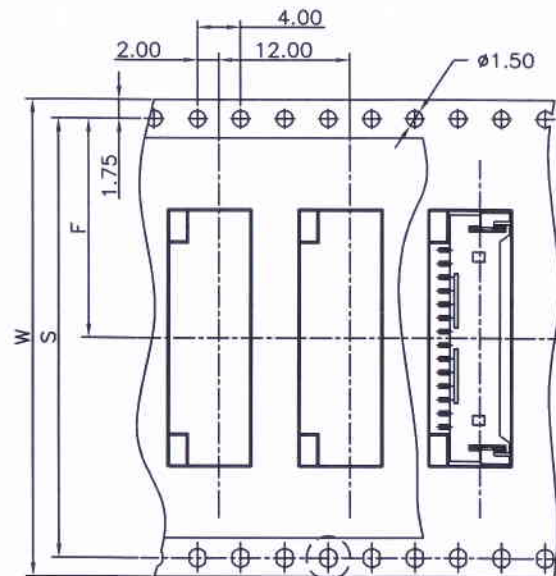
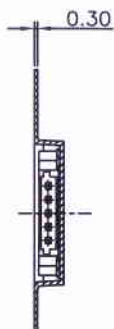

Unreeling direction →

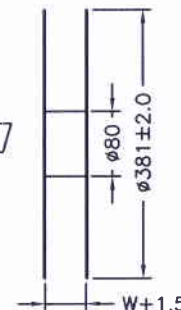
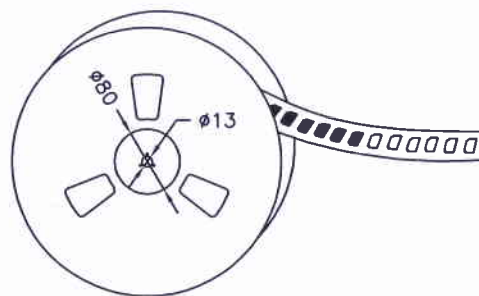
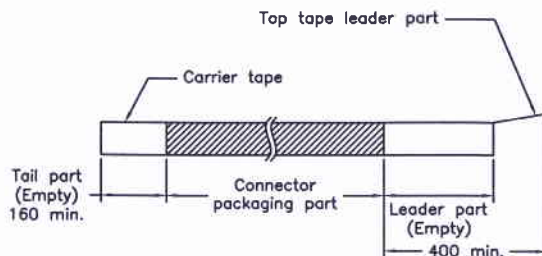
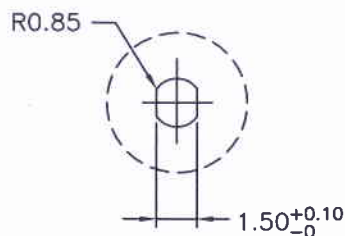

Number of Contacts	W±0.3	F±0.1	S±0.1	Q'ty/Reel
2P	16	7.50	--	2,000
3~8P	24	11.50	--	2,000
9~12P	32	14.20	28.40	2,000
13~20P	44	20.20	40.40	2,000
30P	56	26.20	52.40	2,000

REV.	REVISION RECORD	DATE	UNIT: MM
C0	新图面发行	13.06.18	SIZE: A4
C1	变更公司名称	17.04.05	

GENERAL TOLERANCES		SCALE: 1:1	NAME	DATE
LINEAR	ANGLES	APPROVED	<i>[Signature]</i>	
0.0 ± 0.25	X° REF ± 6°	DESIGNER	<i>[Signature]</i>	17.04.05
0.00 ± 0.15	X° ± 3°	DRAWN	邓群庄	17.04.05
0.000 ± 0.08	X° X' ± 2°			

**JCTC** 胜蓝科技股份有限公司  
 TERMINAL&CONNECTORS 东莞市富智达电子科技有限公司

TITLE:  
 1.25mm PITCH 90° SMT TYPE WAFER

PART NO:	11255W90-NPX-S-HF-NK
DWG NO:	ENDE05
REV:	C1
SHEET:	2/2