

1 2 3 4 5 6 7 8

A

B

C

D

E

F

G

H

A

B

C

D

E

F

G

H

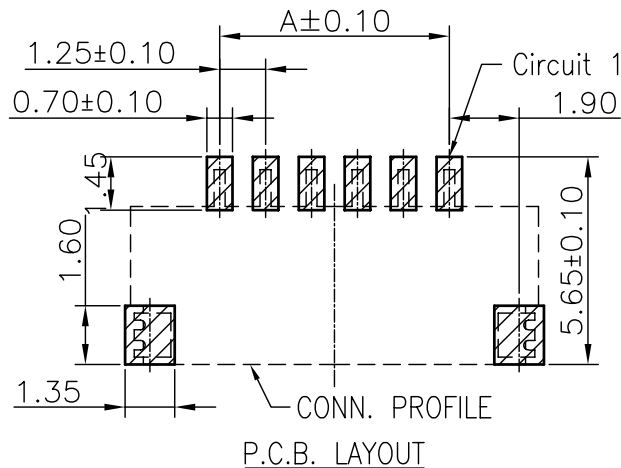
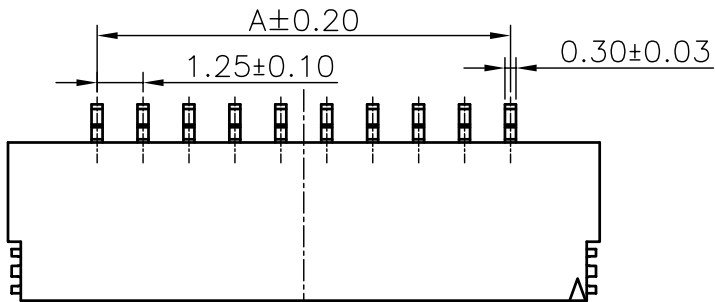

Rated Current : 1A AC,DC
 Rated Voltage : 150V AC/DC
 Withstand Voltage : 500V AC/minute
 Contact Resistance : 30mΩ(MAX.)
 Insulation Resistance : 500MΩ(MIN.)
 Temperature Range : -35°C~+85°C
 The product using material and processing must conform to the "WI-PZ-142"HSF technical standard control requirements

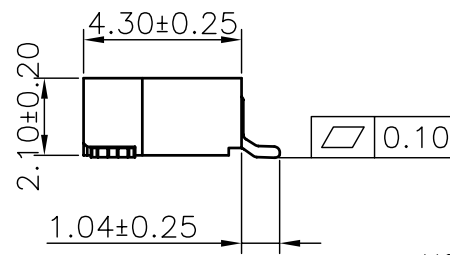
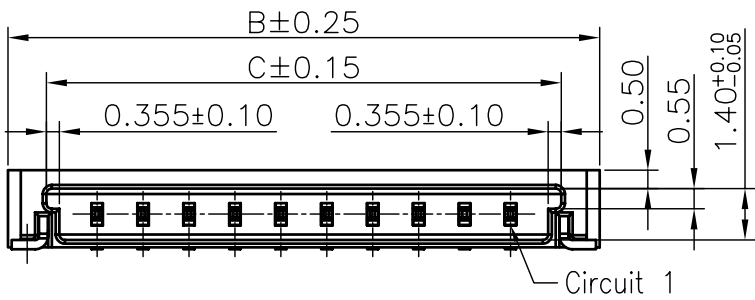

Circuits Part No	Dimensions			
	A	B	C	D
2P	--	6.10	4.01	
3P	2.50	7.35	5.26	
4P	3.75	8.60	6.51	
5P	5.00	9.85	7.76	
6P	6.25	11.10	9.01	
7P	7.50	12.35	10.26	6.25
8P	8.75	13.60	11.51	7.50
9P	10.00	14.85	12.76	8.75
10P	11.25	16.10	14.01	10.00
11P	12.50	17.35	15.26	11.25
12P	13.75	18.60	16.51	12.50
13P	15.00	19.85	17.76	13.75
14P	16.25	21.10	19.01	15.00
15P	17.50	22.35	20.26	16.25
20P	23.75	28.60	26.51	22.50
25P	30.00	34.85	32.76	28.75
30P	36.25	41.10	39.01	35.00

11256W90-NPX-S-2E-HF
 ① ② ③④⑤ ⑥ ⑦

- ① Series No.
- ② W90 : Side Contact
W00 : Up Contact
- ③ No. of Circuits
- ④ X : Product color (A--Y)
Blank : Natural type
- ⑤ S: SMT type
- ⑥ 2E: Tin-plated
- ⑦ HF: Halogen Free

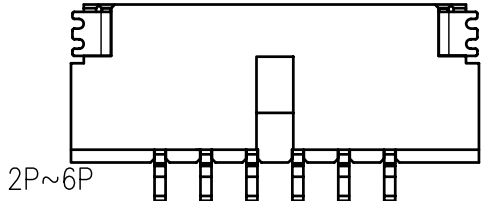
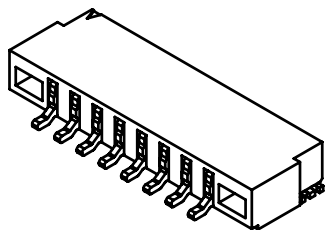
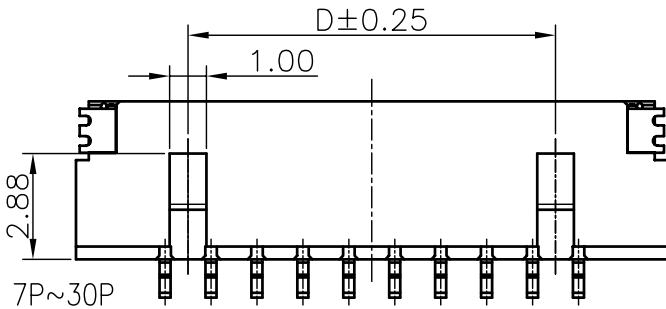

Part No.	Material	Color	Pin Material	Solder Tabs
11256W90-NP-S-2E	High temperature plastic,UL94V-0	Natural(Beige)	Phosphor Bronze/Tin-plated	Brass/Tin-plated
11256W90-NP-S	High temperature plastic,UL94V-0	Natural(Beige)	Phosphor Bronze/Gold-plated	Brass/Gold-flash
11256W90-NPA-S	High temperature plastic,UL94V-0	Natural(Black)	Phosphor Bronze/Gold-plated	Brass/Gold-flash
11256W90-NP-S-HF	High temperature plastic,UL94V-0	Natural(Beige)	Phosphor Bronze/Gold-plated	Brass/Gold-flash
11256W90-NP-S-2E-HF	High temperature plastic,UL94V-0	Natural(Beige)	Phosphor Bronze/Tin-plated	Brass/Tin-plated

REV.	REVISION RECORD	DATE	UNIT	SIZE	GENERAL TOLERANCES	SCALE:	NAME	DATE	TITLE:	PART. NO:
C1	新增镀锡规格	13. 11. 06	MM	A4	LINEAR	1:1			JCTC ® 胜蓝科技股份有限公司 TERMINAL&CONNECTORS 东莞市富智达电子科技有限公司	11256W90-NPX-S-XX
C2	整理图面	14. 11. 26			ANGLES	APPROVED				DWG. NO:
C3	WN1605040052	16. 05. 04			0.00±0.15	DESIGNER				ENDE05
C4	变更公司名称	17. 04. 25			0.000±0.08	DRAWN	邓群庄	17. 04. 25		REV: C4

1 2 3 4 5 6 7 8

2~9 Contacts

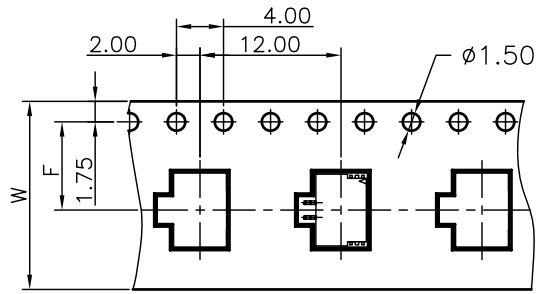

Unreeling direction →

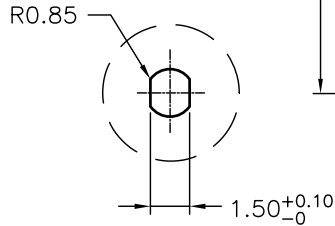
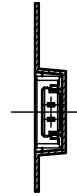
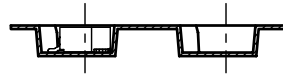

10~30 Contacts

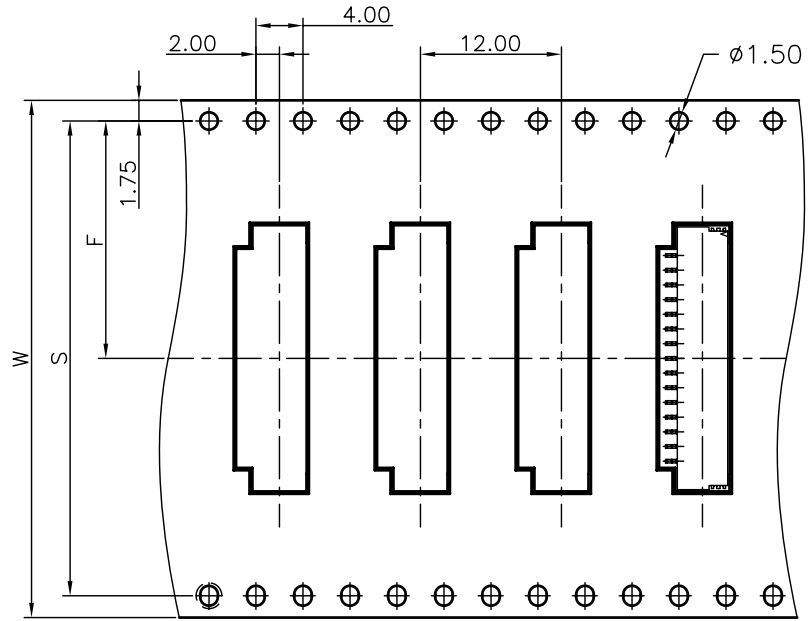

Unreeling direction →

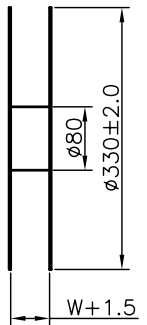
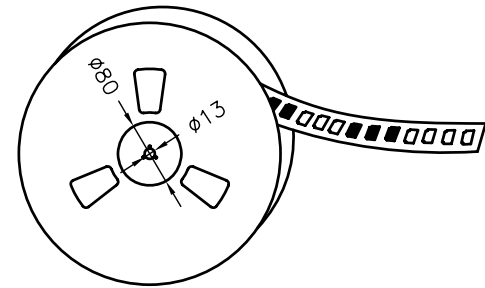
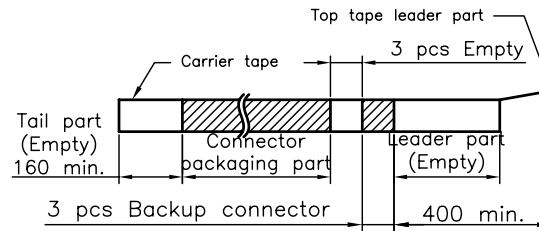
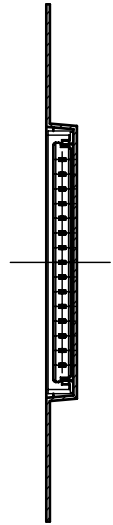

Number of Contacts	W \pm 0.3	F \pm 0.1	S \pm 0.1	Q'ty/Reel
02P	16	7.50		1,500
03P	16	7.50		1,500
04P	16	7.50		1,500
05P	24	11.50		1,500
06P	24	11.50		1,500
07P	24	11.50		1,500
08P	24	11.50		1,500
10P	32	14.20		28.40
11P	32	14.20	28.40	1,500
12P	32	14.20	28.40	1,500
13P	32	14.20	28.40	1,500
14P	32	14.20	28.40	1,500
15P	44	20.20	40.40	1,500
20P	44	20.20	40.40	1,500
25P	56	26.20	52.40	1,500
30P	56	26.20	52.40	1,500

REV.	REVISION RECORD	DATE	
C0	新图面发行	10.06.26	
C1	整理图面	14.11.26	
C2	变更公司名称	17.04.25	

GENERAL TOLERANCES		SCALE:	NAME	DATE
LINEAR	ANGLES	1:1		
0.0 \pm 0.25	X $^{\circ}$ REF \pm 6 $^{\circ}$	APPROVED		
0.00 \pm 0.15	X $^{\circ}$ \pm 3 $^{\circ}$	DESIGNER		
0.000 \pm 0.08	X $^{\circ}$ X' \pm 2 $^{\circ}$	DRAWN	邓群庄	17.04.25

JCTC® 胜蓝科技股份有限公司
 TERMINAL&CONNECTORS 东莞市富智达电子科技有限公司

TITLE: 1.25mm PITCH WAFER-SMT TYPE

PART. NO:	11256W90-NPX-S
DWG. NO:	ENDE05
REV:	C2
SHEET:	2/2