

Specifications:
 Rated Voltage : 250V AC/DC
 Rated Current : 3A AC,DC
 Withstand Voltage : 1000V AC/minute
 Contact Resistance : 30mΩ(Max.)
 Insulation Resistance : 1000MΩ(Min.)
 Temperature Range : -25°C~+85°C
 Contact: Brass/Tin-plated
 Solder Tabs: Brass/Tin-plated
 Insulator: Thermal Plasticity Resin, UL94V-0
 Halogen Free/Natural(Beige)
 The product using material and processing must conform to the "WI-PZ-142"HSF technical standard control requirements

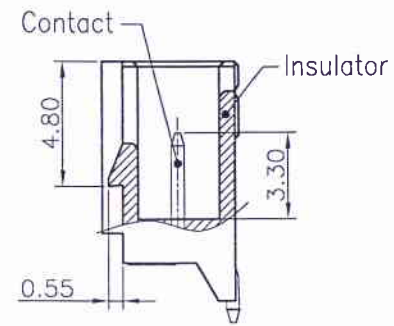
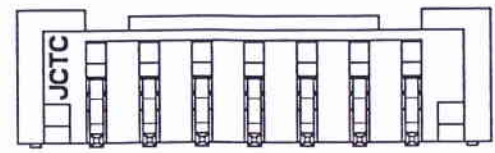
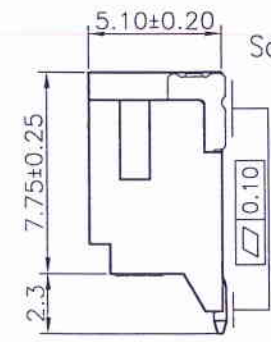
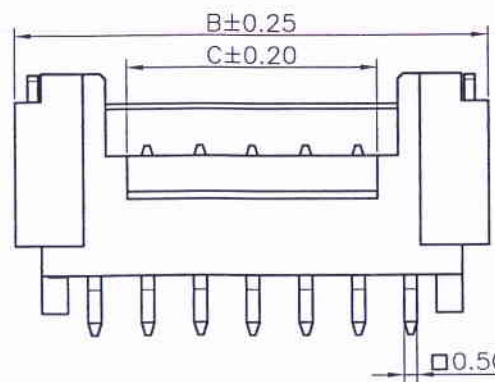

12005W90-NPX-S-HF-R
 ① ② ③④⑤⑥⑦
 ① Series No.
 ② W90 : Side Contact
 W00 : Up Contact
 ③ No. of Circuits
 ④ X : Product color(A--Y)
 Blank-Natural A-Black G-Blue
 ⑤ S: SMT TYPE
 ⑥ HF: Halogen Free
 ⑦ R: Tape & Reel(Without Cap or Mylar)

Circuits	Dimensions		
	A	B	C
2P	--	8.00	1.50
3P	4.00	10.00	
4P	6.00	12.00	3.50
5P	8.00	14.00	5.50
6P	10.00	16.00	7.50
7P	12.00	18.00	9.50
8P	14.00	20.00	11.50
9P	16.00	22.00	13.50
10P	18.00	24.00	15.50
11P	20.00	26.00	
12P	22.00	28.00	
13P	24.00	30.00	
14P	26.00	32.00	
15P	28.00	34.00	
16P	30.00	36.00	

REV.	REVISION RECORD	DATE	GENERAL TOLERANCES		SCALE:	NAME	DATE	JCTC® 胜蓝科技股份有限公司 TERMINAL&CONNECTORS 东莞市富智达电子科技有限公司	PART. NO:
A0	新图面发行	15.01.21	LINER	ANGLES	1:1	伍文聪	17.03.03		12005W90-NPX-S-HF
A1	变更公司名称	17.03.03	0.0±0.25	X° RGF±6°	APPROVED	伍文聪	17.03.03		
			UNIT: MM	0.00±0.15	X° ±3°	DESIGNER		DWG. NO:	
			SIZE: A4	0.000±0.08	X° X'±2°	DRAWN		ENDE05	
								TITLE:	REV: A1
								2.00mm PITCH SMT TYPE 90° WAFER	SHREET: 1/2

2~3 Contacts

4~16 Contacts

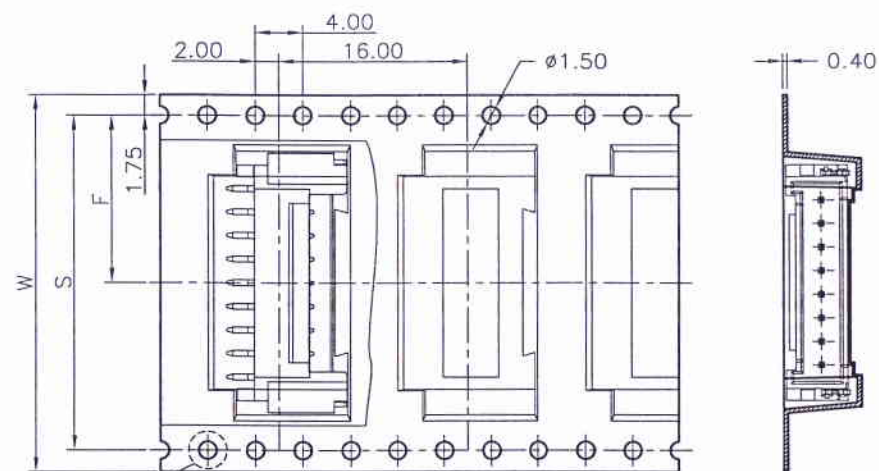
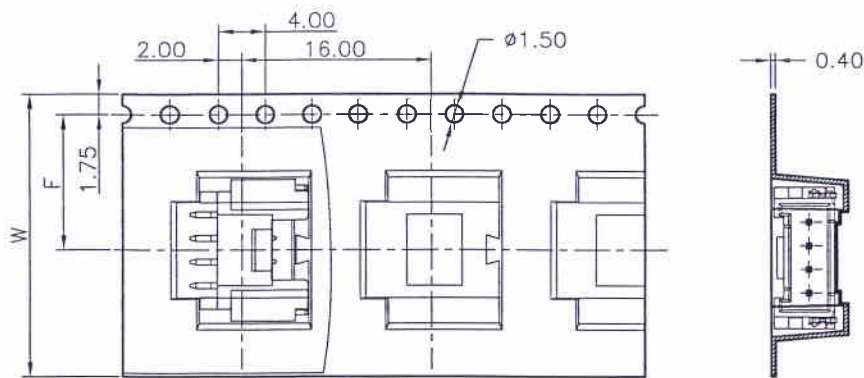

Unreeling direction →

Unreeling direction →

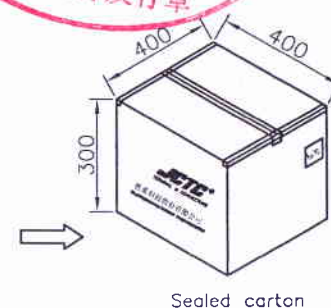
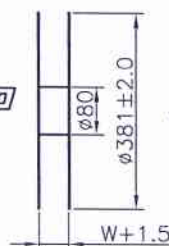
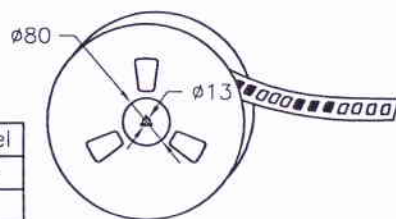
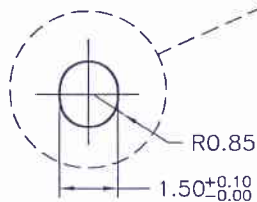
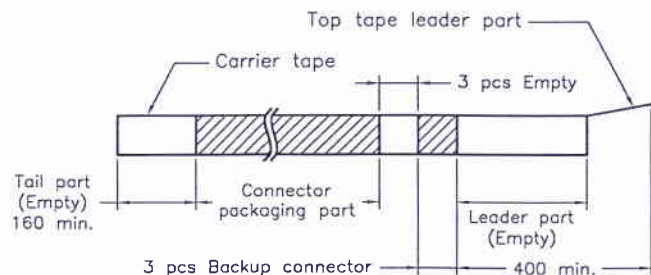
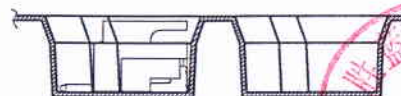
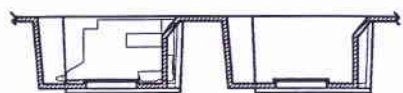

Number of Contacts	W±0.3	F±0.1	S±0.1	Q'ty/Reel	Q'ty/Reel
2P~3P	16	7.50	/	800	12,000
4P~6P	24	11.50		800	8,000
7P~9P	32	14.20	28.40	800	6,400
10P~14P	44	20.20	40.40	800	4,800
15P~16P	56	26.20	52.40	800	4,000

REV.	REVISION RECORD	DATE	GENERAL TOLERANCES		SCALE:	NAME	DATE	PART. NO: 12005W90-NPX-S-HF
A0	新图面发行	15.01.21	LINEAR	ANGLES	1:1			
A1	变更公司名称	17.03.03	0.0 ± 0.25	X° REF ± 6°	APPROVED	<i>[Signature]</i>	17.12.9	
			UNIT: MM	X° ± 3°	DESIGNER	<i>[Signature]</i>	17.12.9	
			SIZE: A4	X° X' ± 2°	DRAWN	伍文聪	17.03.03	
TITLE: 2.00mm PITCH SMT TYPE 90° WAFER JGTC® 胜蓝科技股份有限公司 TERMINAL&CONNECTORS 东莞市高智达电子科技有限公司								DWG. NO: ENDE05 REV: A1 SHEET: 2/2