

环保物料

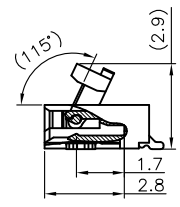

SECTION A-A  
SCALE 1:1

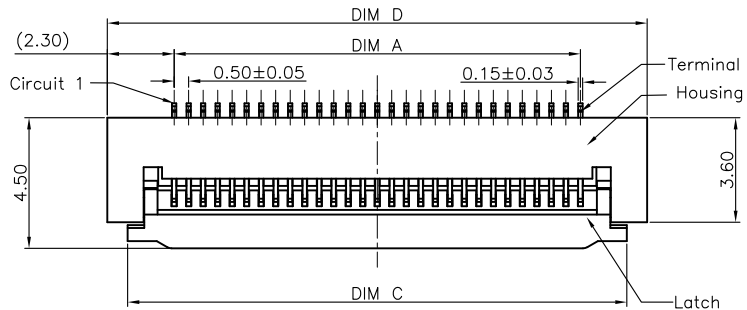
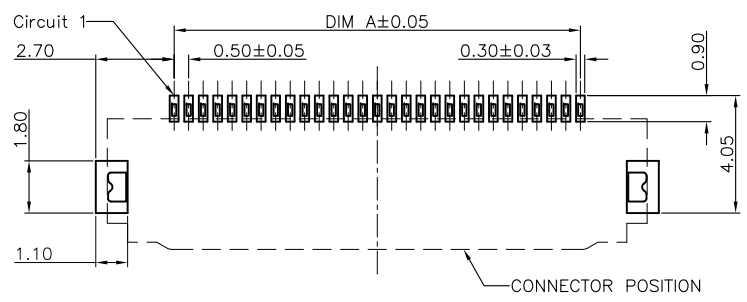
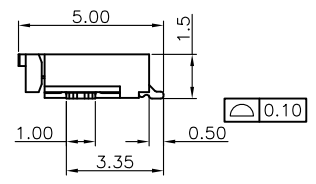
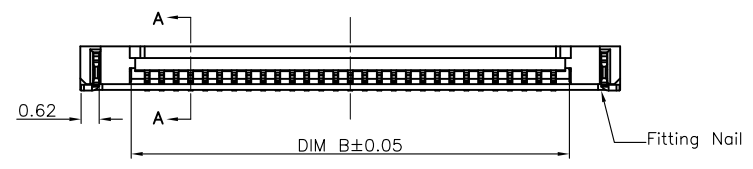

RECOMMENDED P.C.B PATTERN LAYOUT

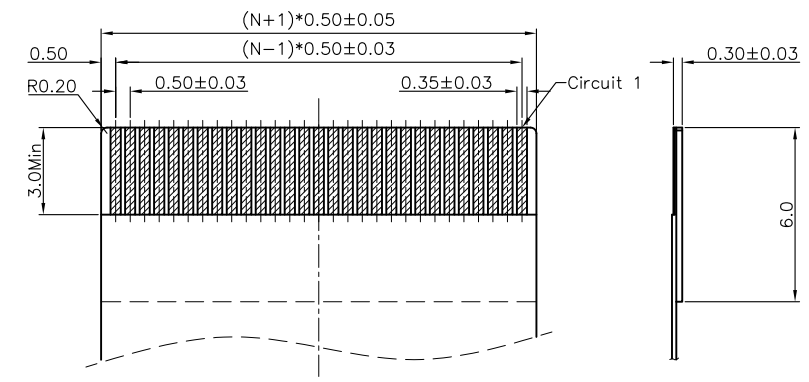

RECOMMENDED FPC/FFC DIMENSION

Note:

- Material:
  - Housing: thermoplastic high temp.UL94V-0; Color: natural.
  - Latch: thermoplastic high temp.UL94V-0; Color: black.
  - Terminal: copper alloy.
  - Fitting Nail: copper alloy.
- Finsh:
  - Terminal: Underplating: Au/matt Tin overall.
  - Fitting Nail: Underplating: matt Tin overall.
- Product must comply HF RoHS specification.

40598W90-NPN-S H L xx T B R  
① ② ③④⑤⑥⑦⑧⑨⑩⑪

- ① Series No.
- ② W90 :Right angle
- ③ No. of Circuits
- ④ Color: N=Natural
- ⑤ S: SMT type
- ⑥ H=Halogen Free
- ⑦ Material: L=LCP
- ⑧ Plating for contacts:  
2E=Matte Tin-plated  
0A=Gold-flash on contact area
- ⑨ Plating for solder area:  
T=Matte Tin-plating(80~120u")
- ⑩ Assembly Style  
B=Bottom Contacts
- ⑪ R=Tape & Reel  
M=Tape Reel&Mylar

Current Rating : 0.5A AC/DC  
 额定电流 : 0.5A AC/DC  
 Voltage Rating : 50V AC/DC  
 额定电压 : 50V AC/DC  
 Withstand Voltage : 250V AC/minute  
 耐压 : 250V AC/minute  
 Contact Resistance : 30mΩ(MAX.)  
 接触电阻 : 30mΩ(MAX.)  
 Insulation Resistance : 100MΩ(MIN.)  
 绝缘电阻 : 100MΩ(MIN.)  
 Temperature Range : -25°C~+85°C  
 温度范围 : -25°C~+85°C

CKTS	DIM A	DIM B	DIM C	DIM D
4	1.50	2.60	4.70	6.10
5	2.00	3.10	5.20	6.60
6	2.50	3.60	5.70	7.10
7	3.00	4.10	6.20	7.60
8	3.50	4.60	6.70	8.10
9	4.00	5.10	7.20	8.60
10	4.50	5.60	7.70	9.10
11	5.00	6.10	8.20	9.60
12	5.50	6.60	8.70	10.10
13	6.00	7.10	9.20	10.60
14	6.50	7.60	9.70	11.10
15	7.00	8.10	10.20	11.60
16	7.50	8.60	10.70	12.10
17	8.00	9.10	11.20	12.60
18	8.50	9.60	11.70	13.10
19	9.00	10.10	12.20	13.60
20	9.50	10.60	12.70	14.10
21	10.00	11.10	13.20	14.60
22	10.50	11.60	13.70	15.10
23	11.00	12.10	14.20	15.60
24	11.50	12.60	14.70	16.10
25	12.00	13.10	15.20	16.60
26	12.50	13.60	15.70	17.10
27	13.00	14.10	16.20	17.60
28	13.50	14.60	16.70	18.10
29	14.00	15.10	17.20	18.60
30	14.50	15.60	17.70	19.10
31	15.00	16.10	18.20	19.60
32	15.50	16.60	18.70	20.10
33	16.00	17.10	19.20	20.60
34	16.50	17.60	19.70	21.10
35	17.00	18.10	20.20	21.60
36	17.50	18.60	20.70	22.10
37	18.00	19.10	21.20	22.60
38	18.50	19.60	21.70	23.10
39	19.00	20.10	22.20	23.60
40	19.50	20.60	22.70	24.10
41	20.00	21.10	23.20	24.60
42	20.50	21.60	23.70	25.10
43	21.00	22.10	24.20	25.60
44	21.50	22.60	24.70	26.10
45	22.00	23.10	25.20	26.60
46	22.50	23.60	25.70	27.10
47	23.00	24.10	26.20	27.60
48	23.50	24.60	26.70	28.10
49	24.00	25.10	27.20	28.60
50	24.50	25.60	27.70	29.10
51	25.00	26.10	28.20	29.60
52	25.50	26.60	28.70	30.10
53	26.00	27.10	29.20	30.60
54	26.50	27.60	29.70	31.10
55	27.00	28.10	30.20	31.60
56	27.50	28.60	30.70	32.10
57	28.00	29.10	31.20	32.60
58	28.50	29.60	31.70	33.10
59	29.00	30.10	32.20	33.60
60	29.50	30.60	32.70	34.10

8							
	A0	18. 10. 23	换图框发行	李兴泽			
	版次REV.	日期 DATE	变更内容 DESCRIPTION	审核 CHK.	核准 APPD.		

一般公差 GENERAL TOLERANCE		绘图 DR.	程功银
X.X ±0.30	X* ±2*	校对 CHK.	李兴泽
X.XX ±0.20	X.X* ±1*	审核 CHK.	李兴泽
X.XXX ±0.10	▲ MAJOR DIM.	核准 APPD.	杨章雄
单位 UNIT	mm		

料号 PART NO.	文件编号 NUMBER
40598W90-NPN-SHLxxTBR	ENDPT01
品名 TITLE	
FPC 0.5Pitch H=1.5 FPC R/A Type1 SMT CONN	

**JCTC**®  
 TERMINAL&CONNECTORS

比例 SCALE	SHEET	版次 REV.
1/1	1/1	A0

环保物料

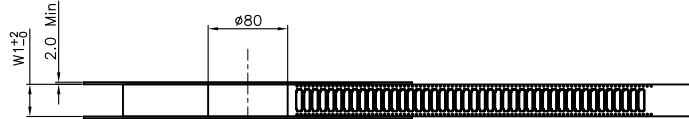

- NOTES:
1. 10 SPROCKET HOLE PITCH CUMULATIVE TOLERANCE.±0.20mm
  2. CARRIER CAMBER NOT TO EXCEED 1mm IN 250mm.
  3. ALL DIMENSIONS MEET EIA-481-C REQUIREMENTS.
  4. MATERIAL: BLACK ANTI-STATIC POLYSTYRENE.
  5. THICKNESS: 0.35 ± 0.05 mm.
  6. PACKING LENGTH PER 13" REEL: 32.60METERS.
  7. COMPONENT LOAD PER 13" REEL: 4000PCS
  8. PEELING OFF FORCE OF TOP TAPE 0.1N~0.7N(10.2gf~71.4gf).

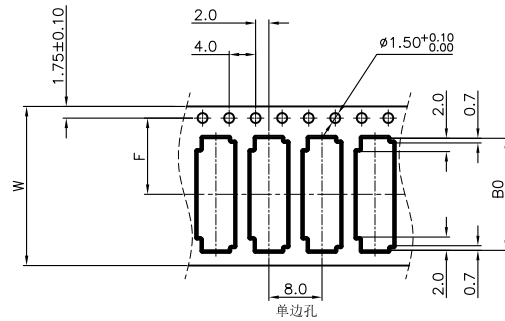
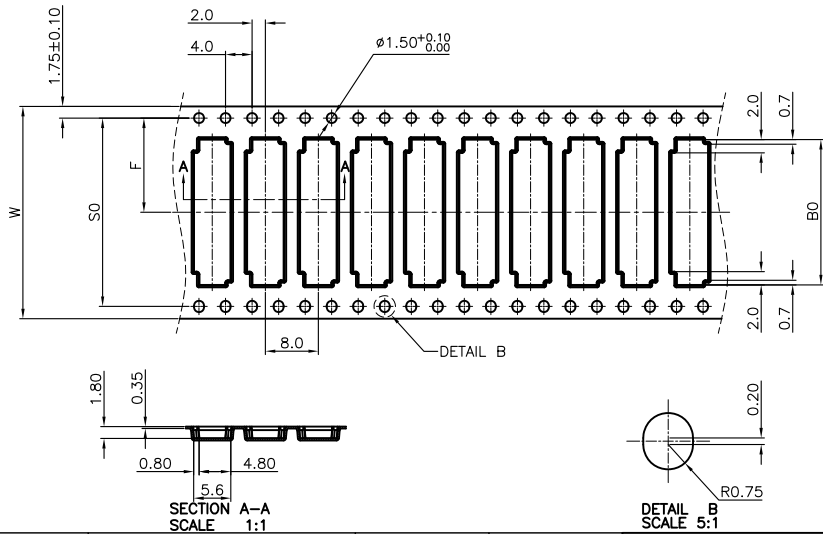
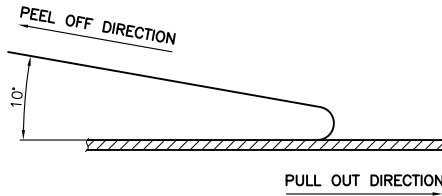
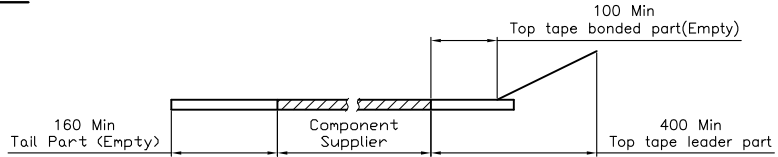
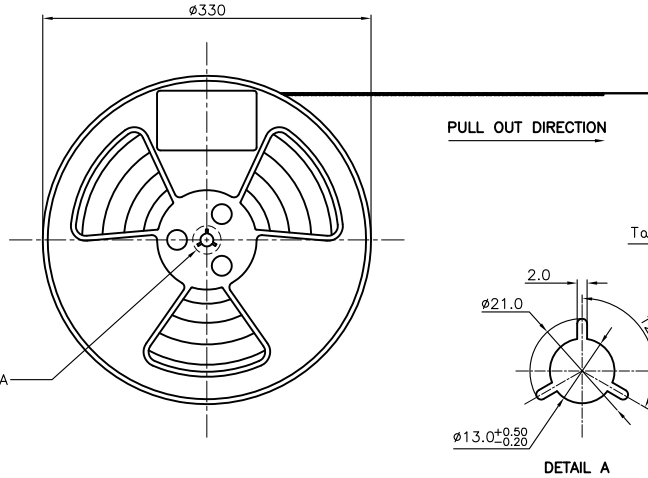

CKTS	B0±C.10	W	W1	F	S0±0.10
4	6.40	16+0.3/-0	16.4	7.5±0.10	
5	6.90				
6	7.40				
7	7.90				
8	8.40				
9	8.90				
10	9.40				
11	9.90				
12	10.40				
13	10.90				
14	11.40	24+0.3/-0	24.4	11.5	单边孔
15	11.90				
16	12.40				
17	12.90				
18	13.40				
19	13.90				
20	14.40				
21	14.90				
22	15.40				
23	15.90				
24	16.40	32±0.30	32.4	14.2±0.10	28.4
25	16.90				
26	17.40				
27	17.90				
28	18.40				
29	18.90				
30	19.40				
31	19.90				
32	20.40				
33	20.90				
34	21.40	44±0.30	44.4	20.2±0.15	40.4
35	21.90				
36	22.40				
37	22.90				
38	23.40				
39	23.90				
40	24.40				
41	24.90				
42	25.40				
43	25.90				
44	26.40	56±0.30	56.4	26.2±0.15	52.4
45	26.90				
46	27.40				
47	27.90				
48	28.40				
49	28.90				
50	29.40				
51	29.90				
52	30.40				
53	30.90				
54	31.40				
55	31.90				
56	32.40				
57	32.90				
58	33.40				
59	33.90				
60	34.40				

A0		18.10.23	换图框发行	李兴泽	一般公差 GENERAL TOLERANCE		绘图 DR. 程功银	料号 PART NO. 40598W90-NPN-SHLxxTBR	文件编号 NUMBER ENDPT01	 TERMINAL&CONNECTORS	
X.X ±0.30		X.XX ±0.20		X.XXX ±0.10		X* ±2*	校对 CHK. 李兴泽	品名TITLE FPC 0.5Pitch H=1.5 FPC R/A Type1 SMT CONN			
X.XX ±0.20		X.XXX ±0.10		▲ MAJOR DIM.			审核 CHK. 李兴泽	FPC 0.5Pitch H=1.5 FPC R/A Type1 SMT CONN		SHEET 1/1	
X.XXX ±0.10		▲ MAJOR DIM.					核准 APPD. 杨章雄				
单位 UNIT mm											