

The product using material and processing must conform to the "WL-PZ-001"HSF technical standard control requirements

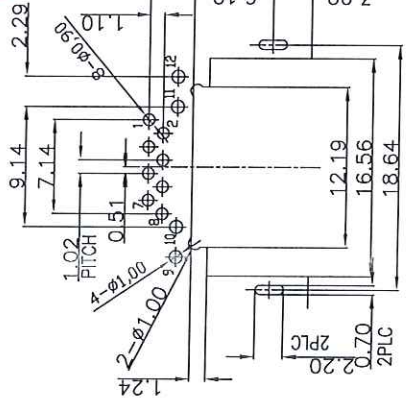
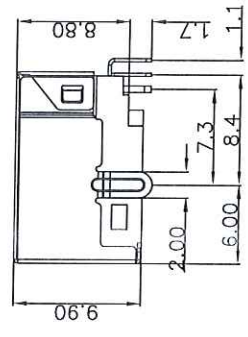
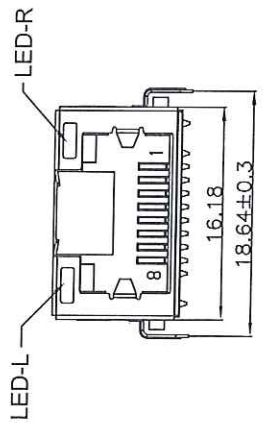
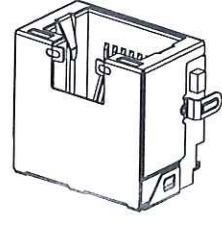
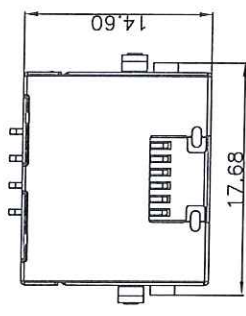

PCBLAYOUT
TOL:±0.05

RoHS

- NOTE:
- MATERIAL SPECIFICATION:
 - HOUSING: LCP UL94V-0
 - SHELL: C2680 T=0.2mm
 - CONTACT: C5191 T=0.25mm
 - PLATING SPECIFICATION:
 - PLATING ON CONTACT AREA
 - PLATING ON SOLDER AREA
 - PLATING ALL AREA
 - SHELL:
 - PLATING OVER ALL
 - LED:
 - PLATING OVER ALL
 - MECHANICAL PERFORMANCE:
 - INSERTION FORCE: 22N MAX
 - REMOVAL FORCE: 22N MAX
 - DURABILITY: 750 CYCLES MIN.
 - ELECTRICAL PERFORMANCE:
 - CURRENT RATING: 1.5A
 - VOLTAGE RATING: 125V MAX
 - CONTACT RESISTANCE: 40mΩ Max.
 - INSULATION RESISTANCE: 500MΩ MIN
 - DIELECTRIC WITHSTANDING VOLTAGE: 500V AC Min
 - ENVIRONMENTAL PERFORMANCE:
 - OPERATING TEMPERATURE: -40°C~+85°C.
 - PACKAGE SPEC: TRAY



- P/N: WLR4F9-08 8 X X X X 033
- LED:
 - 0-W/O LED
 - 1-LEFT:YELLOW
 - RIGHT:GREEN
 - 2-LEFT:GREEN
 - RIGHT:YELLOW
- PLATING:
 - 1-G/F
 - 2-Au 3u"
 - 3-Au 6u"
- COLOUR:
 - A-BLACK
 - E-YELLOW
- LED-L $\begin{matrix} \nearrow 10- \\ \circlearrowleft 9+ \end{matrix}$
- LED-R $\begin{matrix} \nearrow 12- \\ \circlearrowleft 11+ \end{matrix}$

REV. A0	REVISION RECORD NEW RELEASE	DATE 21.01.13	SCALE 1:1	NAME Wang Ji	DATE 2025.09.12	PART.NO. WLR4F9-08BXXX033	DWG.NO. ENDE05	
			GENERAL TOLERANCES LINEAR: 0.0±0.35 ANGLES: X°REF±6° UNIT: mm SIZE: A4 0.000±0.10	APPROVED DESIGNER DRAWN		TITLE: RJ45 8P8C DIP封装式 8MM		
1	2	3	4	5	6	7	8	
<p>WanLian Technology Co., Ltd</p>							REV: A0	SHEET: 1/1