

The product using material and processing must conform to the "WL-PZ-001"HSF technical standard control requirements

RoHS

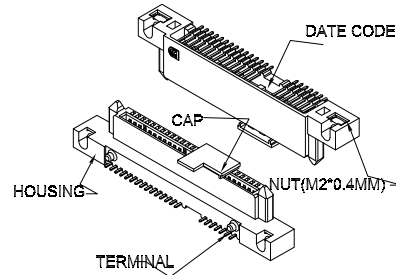

NOTES:
 1.MATERIAL:
 1.1 HOUSING: HIGH TEMPERATURE THERMOPLASTIC, GLASS FIBER FILLED, UL94V-0, BLACK.
 1.2 CAP: HIGH TEMPERATURE THERMOPLASTIC, GLASS FIBER FILLED, UL94V-0, BLACK.
 1.3 TERMINAL: COPPER ALLOY.
 1.4 NUT:BRASS.
 2. FINISH:
 2.1 TERMINAL: NICKEL UNDERPLATING OVER ALL.GOLD FLASH ON CONTACT AREA, MATTE TIN 100u" ON SOLDER AREA.
 2.2 NUT:NICKEL PLATING OVER ALL.
 3. HALOGEN FREE & RoHS COMPLIANT PRODUCTS.

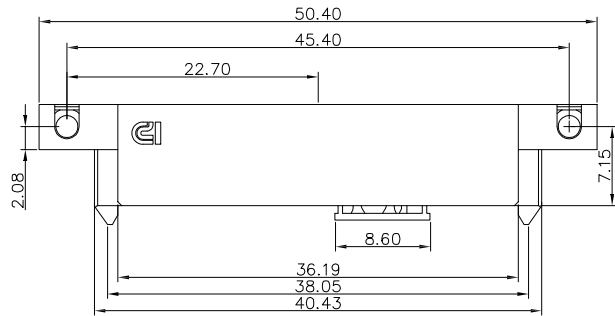
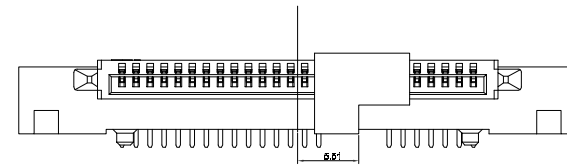
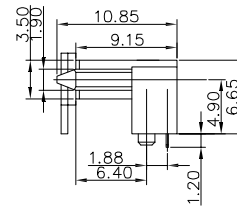
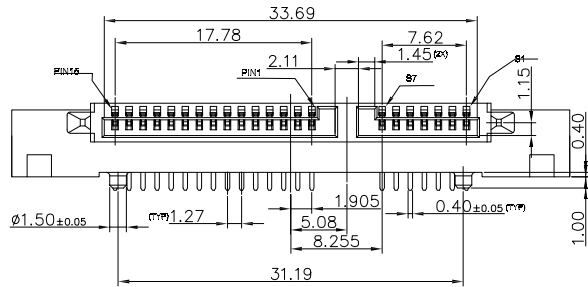

ASSEMBLY WITH CAP

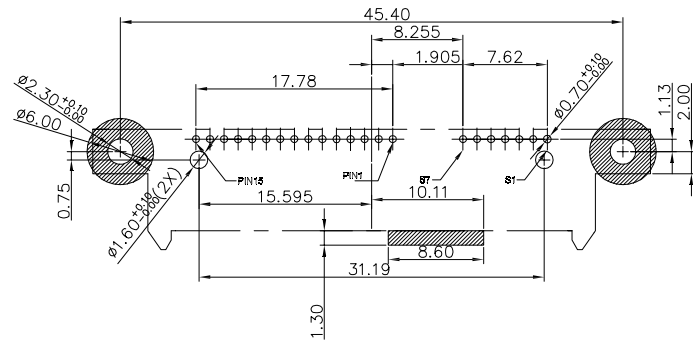

RECOMMENDED P.C.BOARD LAYOUT
 (TOP SIDE) TOLERANCE=±0.05mm

PATTERN SOLDER AREA
 PATTERN PROHIBITED AREA

P/N: WL SA F 9-15 1 1 A 0 010

CONNECTOR: SA-SATA COLOR: A-BLACK

MALE FEMALE: F-FEMALE PLATING: 1-G/F, 3-5U, 5-15U, 6-30U

ANGLE: 9-90°

PIN Q'PY: 15PIN TERMIPOINT: 1-DIP

④	NUT	C3604,T=0.30, Ni PLATING	2
③	CONTACT	C5210-EH,T=0.2, G/F PLATING	22
②	CAP	LCP,UL94V-0, BLACK	1
①	HOUSING	LCP,UL94V-0, BLACK	1
ITEM	DESCRIPTION	REMARK	Q'TY

REV.	REVISION RECORD	DATE		GENERAL TOLERANCES		SCALE: 1:1	NAME	DATE	PART.NO:	DWG.NO:	万连科技 WanLian Teconology Co., Ltd
AO	NEW RELEASE	22.05.09		LINEAR	ANGLES						
			UNIT:mm	0.00±0.25	X'±3°	DESIGNER	Han_Gao	22.05.09	TITLE:		REV: A0 SHEET: 1/1
			SIZE: A4	0.000±0.10	X'X' ±2°	DRAWN	LanXuan_Hou	22.05.09	SATA HDD RECEPACLE REVERSR R/A DIP C/H=4.90mm WITH NUTS		