

The product using material and processing must conform to the "WL-PZ-001"HSF technical standard control requirements

RoHS

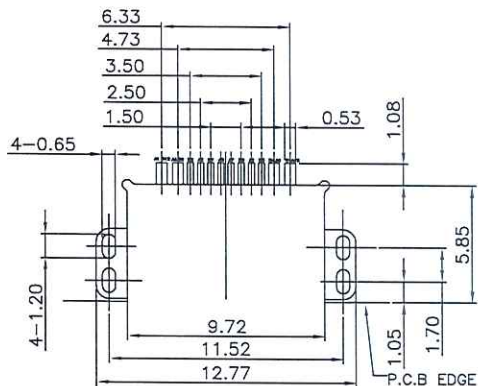
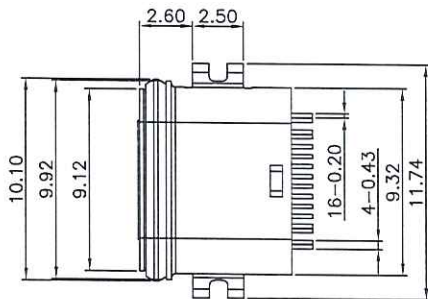

RECOMMENDED PCB LAYOUT(TOP VIEW)
DEFAULT TOLERANCE:±0.05

- NOTE:
- MATERIAL SPECIFICATION:
 - HOUSING :PA10T BLACK
 - CONTACT :COPPER ALLOY
 - MID PLATE:STAINLESS STEEL
 - FRONT PLATE:STAINLESS STEEL
 - PLATING SPECIFICATION:
 - CONTACT:AU G/F PLATING ON CONTACT AREA.
 - MID PLATE:NI PLATING OVER ALL.
 - FRONT PLATE:NI PLATING OVER ALL.
 - MECHANICAL PERFORMANCE:
 - INSERTION FORCE:2.0Kgf MAX
 - EXTRACTION FORCE:0.8Kgf MIN
 - DURABILITY: 10000 CYCLES.
 - ELECTRICAL PERFORMANCE:
 - RATED CURRENT:5.0A
 - VOLTAGE RATING:20V
 - CONTACT RESISTANCE:
 - VBUS & GND PINS AND OTHER PINS: 40mΩ/PIN MAX.
 - SHIELD: 50mΩ/MAX.
 - LLCR MAX. CHANGE OF ALL PINS: 10mΩ.
 - INSULATION RESISTANCE: 100MΩ MIN
 - WITHSTANDING VOLTAGE: 100V AC
 - OPERATION TEMPERATURE RANGE:-25°C~85°C
 - IR REFLOW: THE PEAK TEMPERATURE ON THE BOARD SHALL BE MAINTAINED FOR 10 SECONDS AT 260°C.
 - PACKAGE SPEC: REEL
 - P/N:

WLT2F9-16 8 X X X 123

- PLATED:
- G/F
 - Au 3u"
 - Au 15u"
 - Au 30u"
- HOUSING:
- PA10T
 - LCP
- COLOUR:
- A-BLACK

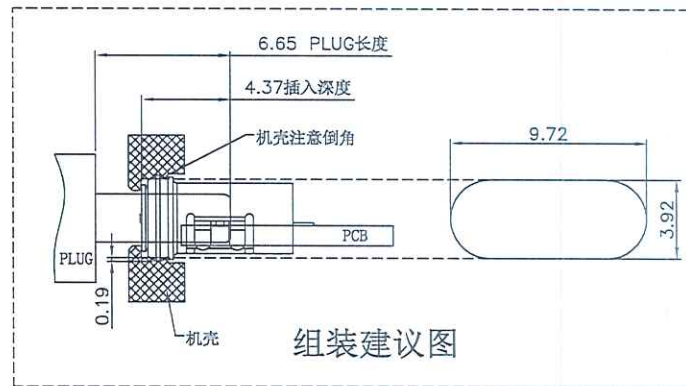
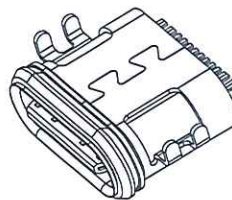
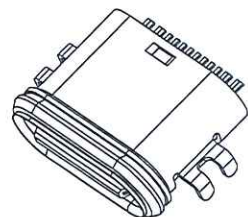
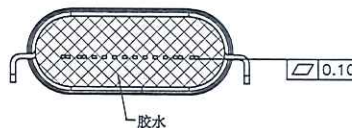
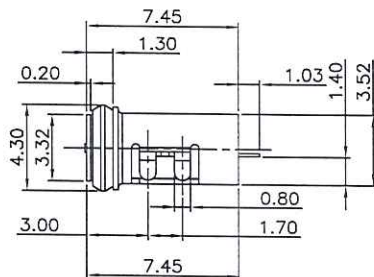
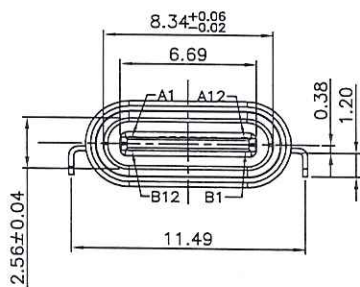

组装建议图

USB TYPE-C PIN ASSIGNMENTS

PIN NUMBER	SIGNAL NAME	PIN NUMBER	SIGNAL NAME
A1	GND	B12	GND
A4	VBUS	B9	VBUS
A5	CC1	B8	SBU2
A6	Dp1	B7	Dn2
A7	Dn1	B6	Dp2
A8	SBU1	B5	CC2
A9	VBUS	B4	VBUS
A12	GND	B1	GND

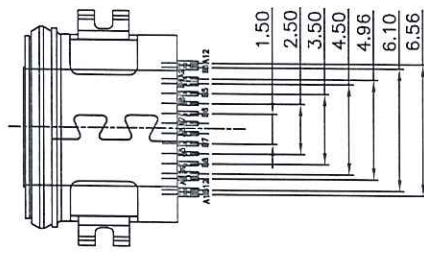

REV.	REVISION RECORD	DATE	GENERAL TOLERANCES		SCALE:	NAME	DATE	PART.NO:	DWG.NO:
A0	NEW RELEASE	21.01.13	LINEAR	ANGLES	1:1			WLT2F9-168XXX123	ENDE05
A1	REMOVE POINT, ADD PACKING SPEC	2025.10.15	0.0±0.35	X°REF±6°	APPROVED	<i>mpz</i>	2025.10.15		
			0.00±0.25	X°±3°	DESIGNER	<i>Nangji</i>	2025.10.7	TITLE:	
			0.000±0.10	X°X'±2'	DRAWN	Jian_Ou	21.01.13	TYPE C 16P/F SMT IPX7	



REV: A1 SHEET: 1/2

The product using material and processing must conform to the "WL-PZ-001" HSF technical standard control requirements

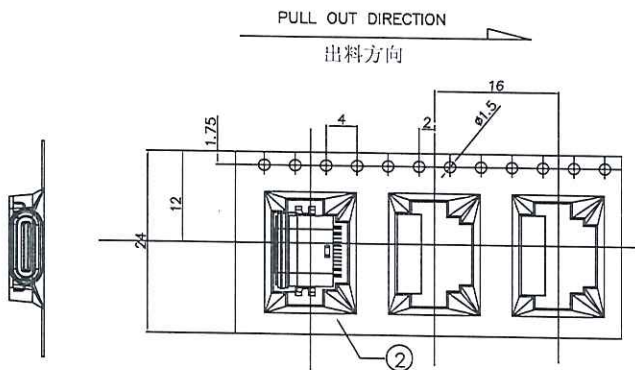
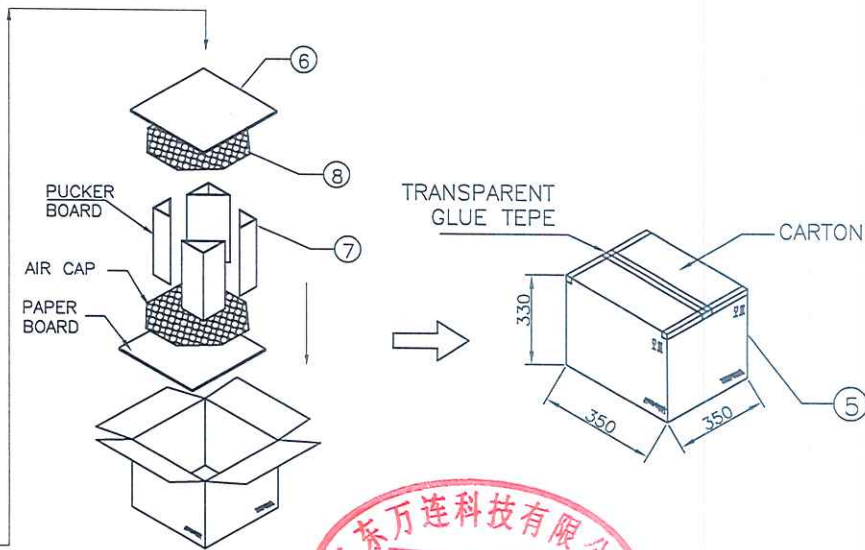
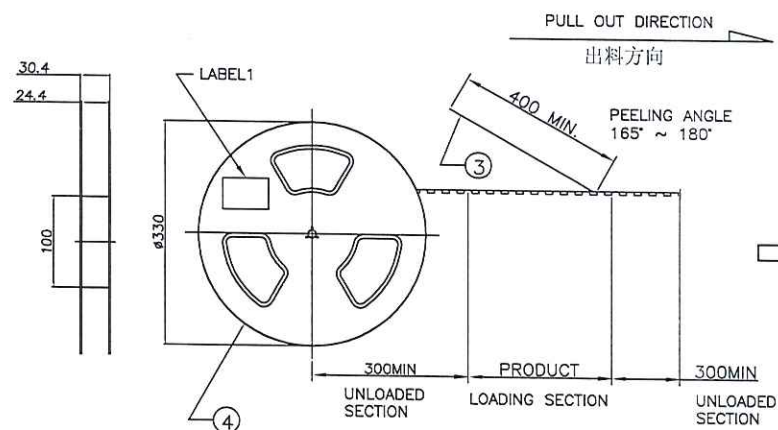

8	气泡垫	L=345,W=345,T=10	2PCS
7	纸板(折三角垫)	L=430,W=330,T=6	4PCS
6	硬纸板	L=330,W=330,T=6	2PCS
5	外箱	L=350,W=350,H=330	1PCS
4	卷盘	PS,BLUE,A=330,B=100,W=32.4	10PCS
3	上带	PET,CLEAR,W=21.3	14.5m
2	载带	PS,BLACK,W=24,T=0.4,P=16	14.5m
1	UAB CONN	UAB CONN	8000PCS
NO.	NAME	SPEC	Q'TY

备注:

1. 包装方式

- 1-1: 使用半自动包装机, 先将 CARRY TAPE 送入导轨中, 并与 COVER TAPE 贴合在上面, 其中前端20空槽不要放产品, 尾端20空槽不要放产品, 然后将产品如图所示方向依次放入 CARRY TAPE 每个槽放1PCS;
- 1.2. 用胶带将 CARRY TAPE 聚合在一起, 真空包装后在图示指定位置贴上 LABEL;
- 1-3: 按图示要求将10盘包装好的 REEL 套入防水袋后装入纸箱, 纸箱上下按图示要求加垫硬纸板和海绵垫, 四角折三角垫固定;
- 1-4: 将装好产品的纸箱按图示要求封箱, 在指定区域贴好 LABEL;

2. 包装数量:

- 800PCS/REEL;
- 10REEL(8000PCS)/CARTON.

3. 耐剥离性:

- 上带引拔力测试规格: 20-150gf
- 测试条件: 以每分钟300mm速度引拔测试

REV.	REVISION RECORD	DATE	GENERAL TOLERANCES	SCALE:	NAME	DATE	PART.NO:	DWG.NO:
A0	NEW RELEASE	21.01.13	LINEAR	1:1			WLT2F9-168XXX123	ENDE05
A1	REMOVE POINT, ADD PACKING SPEC	2025.10.15	0.0±0.35	APPROVED	<i>Mx2</i>	<i>2025.10.15</i>		
			0.00±0.25	DESIGNER	<i>Wang Jij</i>	<i>2025.10.15</i>	TITLE:	
			0.000±0.10	DRAWN	Jian_Ou	21.01.13	TYPE C 16P/F SMT IPX7 PACKING	



REV: A1 SHEET: 2/2