

The product using material and processing must conform to the "WI-PZ-001" HSF technical standard control requirements

RoHS

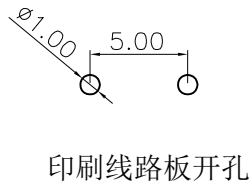

印刷电路板开孔

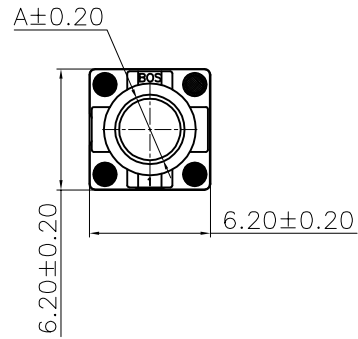
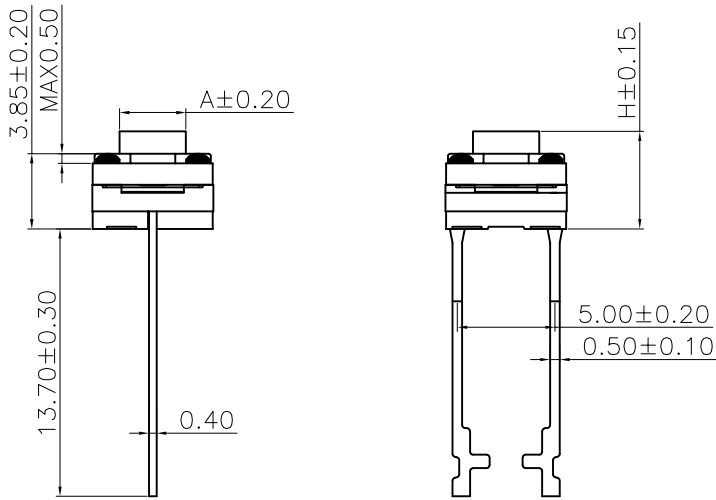
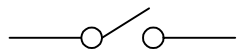

原理图

产品零部件剖析图

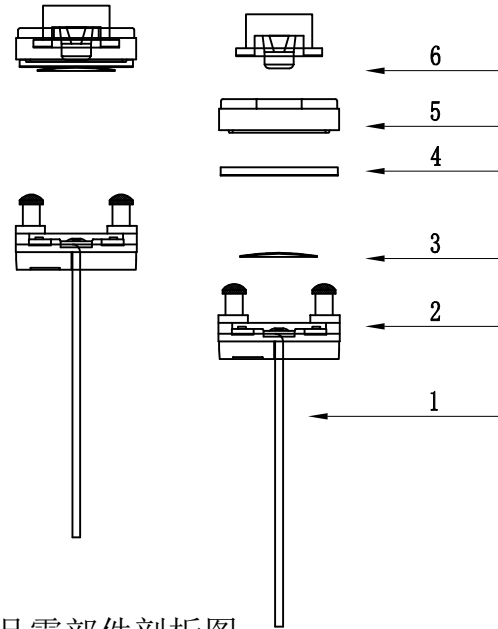

NOTE:

- 1.MATERIAL SPECIFICATION:
 - 1-1.CONTACTS:BRASS T=0.4mm
 - 1-2.HOUSING:PPA COLOUR:BALCK
 - 1-3.SHRAPNEL:φ4 STAINLESS STEEL
 - 1-4.WATERPROOF COMPOSITE VINYL: POLYIMIDE COLOUR:YELLOW AND BLACK
 - 1-5.COVER: PPA COLOUR:BLACK
 - 1-6.BUTTON: PPA COLOUR:BLACK
- 2.PLATING SPECIFICATION:
 - 2-1.CONTACT:AG PLATED ON CONTACT AREA
 - 2-2.SHRAPNEL:AG PLATED.
- 3.ELECTRICAL PERFORMANCE:
 - 3-1.RATING CURRENT:50mA DC
 - 3-2.RATING VOLTAGE:12V DC
 - 3-3.CONTACT RESISTANCE: 100mΩ MAX;
 - 3-4.INSULATION RESISTANCE:100MΩ MIN
 - 3-5.WITHSTANDING VOLTAGE: AC 250V/50HZ,1MIN
- 4.MECHANICAL PERFORMANCE:
 - 4-1.DURABILITY: 100000 CYCLES.
 - 4-2.WATERPROOF:IP67
- 5.OPERATION TEMPERATURE RANGE:-20°C~+85°C
- 6.PACKAGE SPEC:PE STRAP PACKING

7.P/N: WLSW10-02 1 8 A X 056

- PLATED: 8.AG
- COLOUR: A.BLACK
- A.H=4.30mm
- B.H=4.50mm
- C.H=5.00mm
- D.H=5.50mm
- E.H=6.00mm
- F.H=6.50mm
- G.H=7.00mm
- H.H=7.50mm
- I.H=8.00mm
-

H	A
总高/mm	按钮顶部尺寸/mm
4.3	3.4
4.5	3.4
5.0	3.4
5.5	3.25
6.0	3.3
6.5	3.15
7.0	3.1
7.5	3.1
8.0	3.15

N (按力值gf)				
130	180	250	350

REV.	REVISION RECORD	DATE	GENERAL TOLERANCES		SCALE:	NAME	DATE	PART.NO:	DWG.NO:
A0	NEW RELEASE	21.01.13	LINEAR	ANGLES	1:1	Wang_jr	21.01.13	WLSW10-0218AX056	ENDE05
			0.0±0.35	X°REF±6°	APPROVED	Han_Gao	21.01.13	TITLE:	 WanLian Teconology Co., Ltd
			0.00±0.25	X'±3°	DESIGNER	Zijun_Huang	21.01.13	TACT SWITCH	
			0.000±0.10	X°X'±2°	DRAWN				

REV: A0 SHEET: 1/2

The product using material and processing must conform to the "WI-PZ-001"HSF technical standard control requirements

RoHS

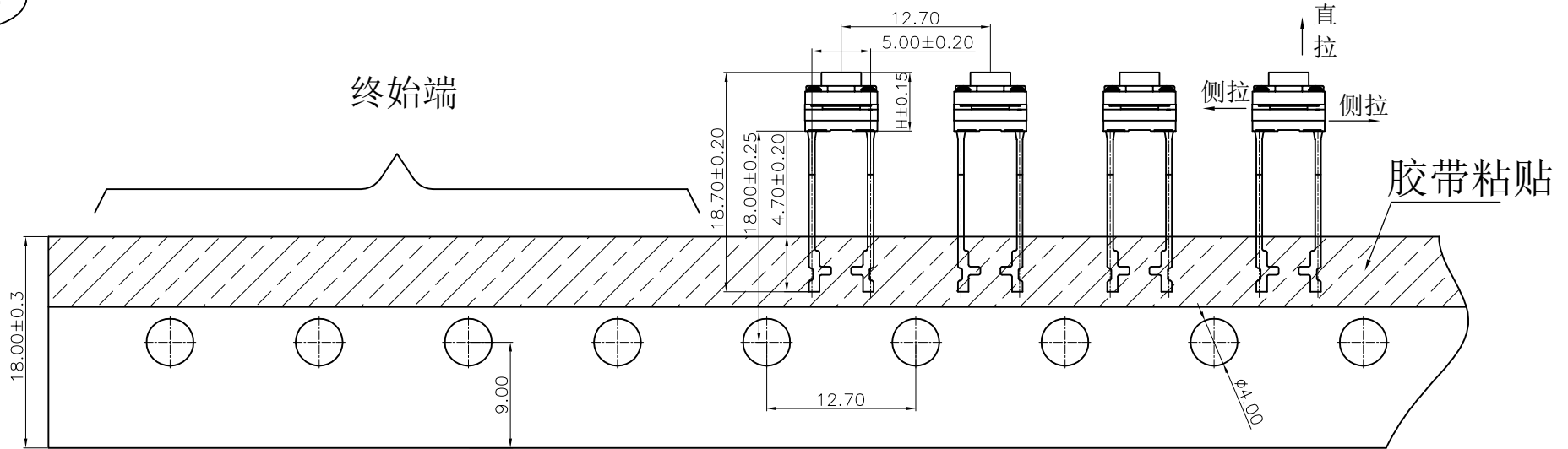

技术要求:

- 1.本产品不含环境危险物质,适用于RoHS指令2011/65/EU要求。
- 2.纸带:用宽18mm,厚0.45mm,编带定位孔间距为 12.7 ± 0.2 mm。
- 3.起始端和终止端分别空置5个位置,防止裁脚使用时,因上料而浪费;正常编带后按24只空1个位置的顺序编,防止编带后折弯装盘变形。
- 4.胶带粘贴的牢固度:为了防止因粘贴不牢固而脱落,或不同心而造成后续裁脚尺寸保证困难。要求其测拉力要大于1.5N,直拉力要大于5N。

H (产品总高mm)		
4.3	4.5	5.0
5.5	6.0	6.5
7.0	7.5	8.0
8.5	9.0	9.5
10.0	10.5	11.0
11.5	12.0
N (按力值gf)		
100	160	250 350

部件规格表

序号	部件名称	部件材料	部件用量	其它
1	卡件	0.4黄铜	1PCS	镀银白色
2	基座	PPA	1PCS	黑色
3	弹片	Φ4进口不锈钢覆银	1PCS	镀银白色
4	防水复合黑胶	聚酰亚胺(防水黑胶+防水膜)	1PCS	黑色+黄色
5	盖板	PPA	1PCS	黑色
6	按钮	PPA	1PCS	黑色
7				
8				

REV.	REVISION RECORD	DATE	UNIT:mm	GENERAL TOLERANCES		SCALE: 1:1	NAME	DATE	PART.NO:	DWG.NO:	WanLian Teconology Co., Ltd
A0	NEW RELEASE	21.01.13		SIZE: A4	LINEAR	ANGLES	APPROVED	Wang_jr	21.01.13	WLSW10-0218AX056	
				0.0±0.35	X°REF±6°	DESIGNER	Han_Gao	21.01.13	TITLE:		REV: A0
				0.00±0.25	X'±3°	DRAWN	Zijun_Huang	21.01.13	TACT SWITCH PARKAGE DRAWING		SHEET: 2/2
				0.000±0.10	X°X'±2°						

