

The product using material and processing must conform to the "WI-PZ-001"HSF technical standard control requirements

RoHS

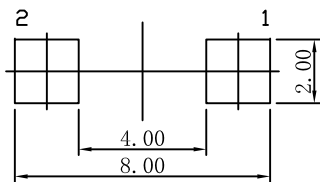

印刷板安装孔图
P.C.B Mounting pattern dimension

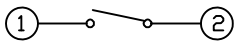

电路图
Circuit diagram

NOTE:

- 1.MECHANICAL PERFORMANCE:
 - 1-1.PRESS FORCE: 260±50g
 - 1-2.DURABILITY: 100000 CYCLES.
- 2.ELECTRICAL PERFORMANCE:
 - 2-1.CURRENT RATING:5mA
 - 2-2.VOLTAGE RATING:12V
 - 2-3.CONTACT RESISTANCE: 100mΩ MAX.
 - 2-4.INSULATION RESISTANCE: 100MΩ MIN
 - 2-5.DIELECTRIC WITHSTANDING VOLTAGE: 250V AC MIN.
- 3.ENVIRONMENTAL PERFORMANCE:
 - OPERATING TEMPERATURE: -20°C~+70°C.
- 4.P/N ORDER:

WLSW10-0228 X 0030

COLOUR:
A:BLACK

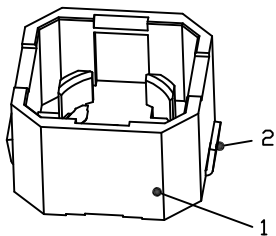
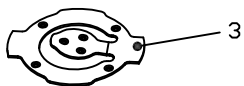
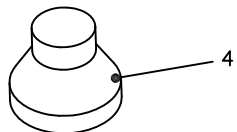
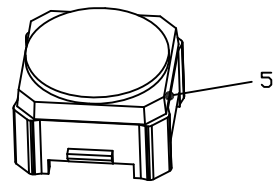

分解视图
Exploded Views

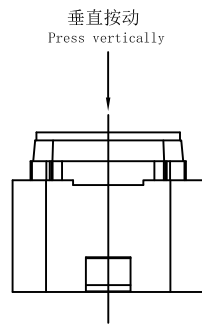
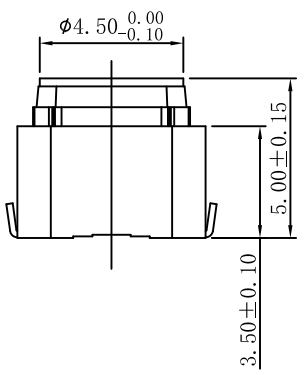
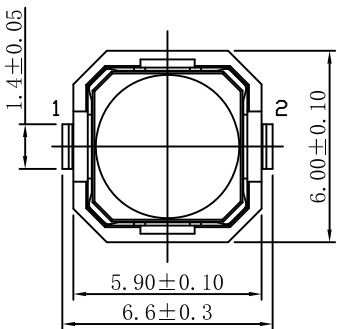
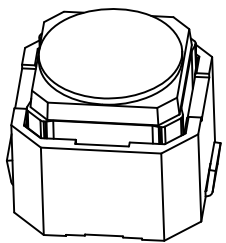

5	盖子	LCP	黑色	1
4	弹力胶	硅胶	蓝色	1
3	接触片	磷铜	镀银	1
2	端子	黄铜	镀银	1
1	底座	LCP	黑色	1
NO.	名称 PART NAME	材料 MATERIAL	表面状态 FINISHING	数量 QTY.

REV.	REVISION RECORD	DATE		GENERAL TOLERANCES		SCALE: 1:1	NAME	DATE	PART.NO: WLSW10-0228X0030	DWG.NO: ENDE05		
AO	NEW RELEASE	21.01.13		LINEAR	ANGLES	APPROVED	Wang_jr	21.01.13				
			UNIT:mm	0.00±0.25	X°±3°	DESIGNER	Han_Gao	21.01.13	TITLE: LIGHT TOUCH SWITCH 6*6*5 PATCH	REV: A0		SHEET: 1/1
			SIZE: A4	0.000±0.10	X°X' ±2°	DRAWN	Zijun_Huang	21.01.13				