

The product using material and processing must conform to the "WI-PZ-001"HSF technical standard control requirements

RoHS+HF

NOTE:

- MATERIAL SPECIFICATION:
 - HOUSING:LCP, UL94V-0 COLOUR: WHITE
 - CONTACTS:PHOSPHOR BRONZE
 - SHELL:BARSS
- PLATING SPECIFICATION:
 - CONTACTS: SN PLATED OR AU PLATED ON CONTACT AREA.
 - SHELL:SN PLATED.
- MECHANICAL PERFORMANCE:
 - INSERTION FORCE: 0.12kgf MAX
 - REMOVAL FORCE: 0.08kgf MIN
 - DURABILITY: 30 CYCLES.
- ELECTRICAL PERFORMANCE:
 - RATED CURRENT : 0.5A
RATED VOLTAGE : 150V AC
 - INSULATION RESISTANCE: 500MΩ MIN
CONTACT RESISTANCE : 50mΩ MAX.
 - WITHSTANDING VOLTAGE: 250V AC
- ENVIRONMENTAL PERFORMANCE:
 - OPERATING TEMPERATURE: -45°C~+125°C.
- PACKAGE SPEC:REEL

7.P/N:

B1001 33 M 0-2 XX 2 X X 101

SERIES NO:

HEIGHT:
33: 3.3mm

MALE FEMALE:
M-MALE

ANGLE:
0-180°

ROW NO:
2-DOUBLE ROW

COLOR:
A-BLACK
K-WHITE
S-NATURE

PLATING:
A-ALL AU G/F
C-BRIGHE TIN
1-G/F

TERMIPOINT:
2-SMT
PIN Q'PY:
09~51

Ordering Information & Dimensions

Circuit	Dimensions(mm)					
	A	B	C	D	E	F
09	8.3	3	4	7.1	10.1	0
11	9.3	4	5	8.1	11.1	0
13	10.3	5	6	9.1	12.1	0
15	11.3	6	7	10.1	13.1	0
17	12.3	7	8	11.1	14.1	0
19	13.3	8	9	12.1	15.1	0
21	14.3	9	10	13.1	16.1	5
23	15.3	10	11	14.1	17.1	6
25	16.3	11	12	15.1	18.1	7
31	19.3	14	15	18.1	21.1	10
41	24.3	19	20	23.1	26.1	15
51	29.3	24	25	28.1	31.1	20

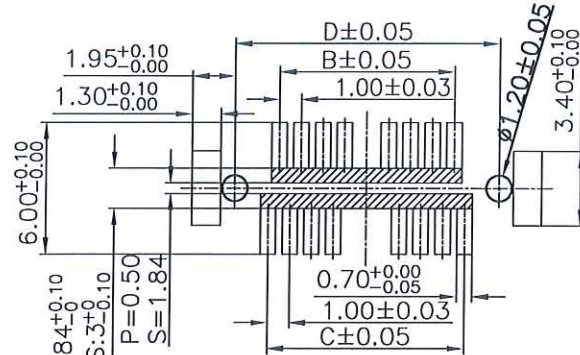
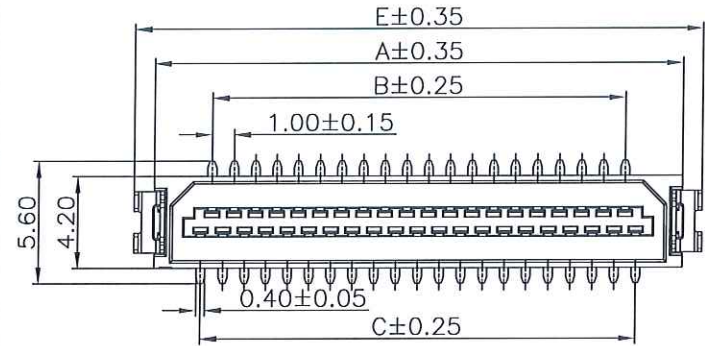

RECOMMENDED PCB LAYOUT(TOP VIEW)

9~25POS:1.84±0.10
31.41.51POS:3±0.10
P=0.50
S=1.84

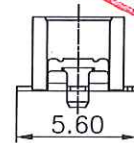
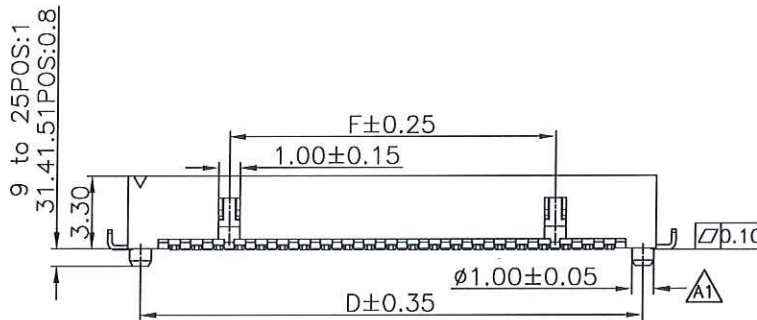

REV.	REVISION RECORD	DATE	GENERAL TOLERANCES		SCALE:	NAME	DATE	PART.NO:	DWG.NO:	
A0	NEW RELEASE	21.01.13	LINEAR	ANGLES	1:1	李永平	25.1.6	B100133M0-2XX2XX101	ENDE05	
A1	RESIZE COLUMN	25.01.03	0.0±0.35	X'REF±6'	APPROVED	李永平	25.01.06	TITLE: Board to Board Pitch1.0 H3.3mm 单槽双排 带定位柱带焊片 SMT型公座	REV: A1	SHEET: 1/2
			0.00±0.25	X'±3'	DESIGNER	李永平	25.01.06			
			0.000±0.10	X'X' ±2'	DRAWN	黄永平	25.01.06			

"WI-PZ-001"HSF technical and processing must conform to the
 The product using material and processing standard requirements

Tape width 16 and 24 mm

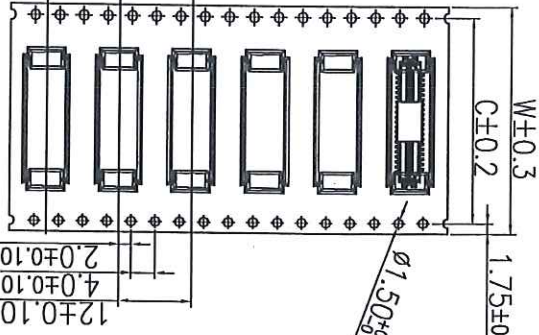
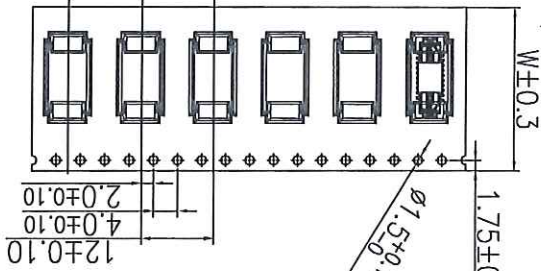

Tape width 32 and 44 mm

NOTE:

- 1.10 Sprocket hole pitch cumulative tolerance±0.20.
- 2.Carrier camber is within 1mm in 100mm.
- 3.Material: black conductive polystyrene alloy.
- 4.Material Thickness: 0.3±0.05mm.
- 5.For tape width(dim W)16 and 24mm
 plot holes are provided on one sides.
 For tape width(dim W)32, 44 and 56mm
 plot holes are provided on both sides.



RoHS+HF

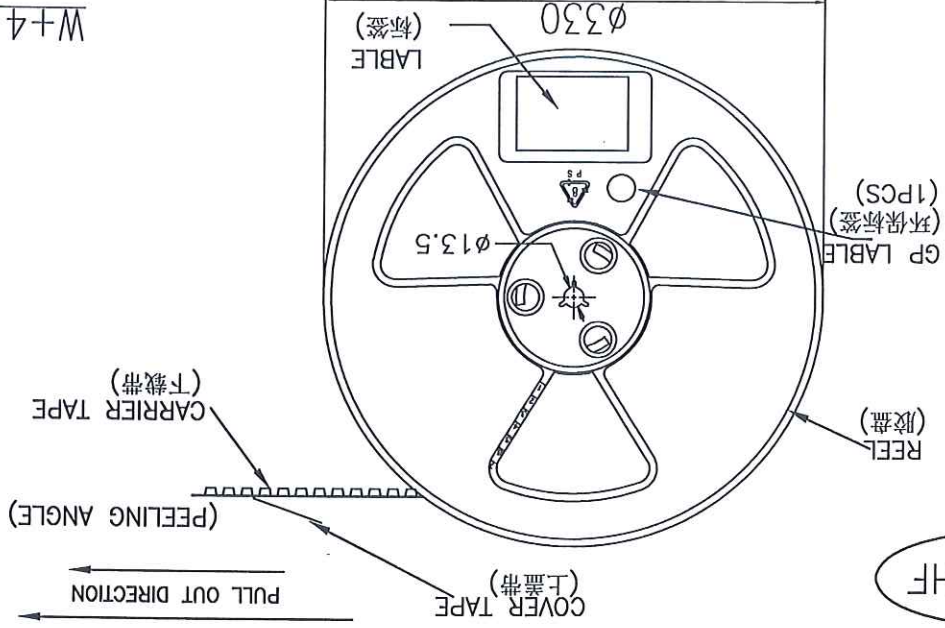

REEL	PCS / REEL	REEL / CARTON	SUM(PCS)
6000	6	8	8000
11000	11	11	11000

Circuit	W	C	PCS / REEL	REEL / CARTON	SUM(PCS)
44PIN	44	40.4	1000	1000	6000
19~31PIN	32	28.4	1000	1000	8000
11~17PIN	24	-	1000	1000	11000

REV.	REVISION RECORD	DATE	SCALE:	NAME	DATE	PART.NO:	DWG.NO:
A0	NEW RELEASE	21.01.13	1:1	8/2/16	25.1.6	PACKING DRAW	ENDE05
A1	RESIZE COLUMN	25.01.03	GENERAL TOLERANCES	APPROVED	DESIGNER	TITLE:	
			LINEAR ANGLES			BOARD TO BOARD PITCH1.0 H3.3MM SMT	
			X.REF±6			MALE REEL PACKING DRAW	
			X.REF±2				
			UNIT:mm				
			0.00±0.25				
			0.00±0.10				
			SIZE: A4				

Wanlian Technology Co., Ltd

REV: A0 SHEET: 2/2

东万连科技有限公司
 2025.01.06
 产品中心
 技术文件发行章