

The product using material and processing must conform to the "WL-PZ-001"HSF technical standard control requirements

RoHS

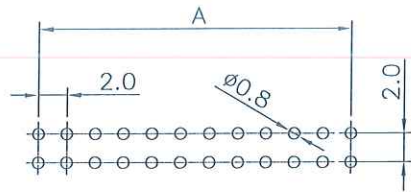

Recommend PCB Layout
General tolerance±0.05



类型	尺寸“L”	尺寸“L1”
高耳	20.85	8.95
低耳	17.00	5.00

- NOTE:
- MATERIAL SPECIFICATION:
1-1.HOUSING: PA6T,UL94V-0
1-2.CONTACTS: BRASS
 - PLATING SPECIFICATION:
2-1.CONTACTS:
TIN/GOLD FLASH PLATED OVER ALL.
 - MECHANICAL PERFORMANCE:
3-1.RETENTIVITY FORCE: 0.4KGF/pin min
3-2.DURABILITY: 100 CYCLES.
 - ELECTRICAL PERFORMANCE:
4-1.CURRENT RATING: 2A
RATED VOLTAGE : 250V AC/DC
4-2.CONTACT RESISTANCE: 30 mΩ MAX
4-3.INSULATION RESISTANCE: 1000MΩ Min
4-4.DIELECTRIC WITHSTANDING : 500V
 - ENVIRONMENTAL PERFORMANCE:
5-1.OPERATING TEMPERATURE: -40°C~+105°C.
 - PACKAGE SPEC: TRAY
 - P/N:

EJ20750 F 9-2 XX 1 X X X

SERIES NO: []

MALE FEMALE:
F-FEMALE

ANGLE:
9-90~
0-180~

ROW NO:
2-DOUBLE ROW

PIN Q'PY:
10~60

TYPE:
1-高耳
2-低耳

COLOR:
A-BLACK
K-WHITE
S-NATURE

PLATING:
A-ALL AU G/F
C-BRIGHT TIN
D-MATTE Tin

TERMIPOINT:
1-DIP

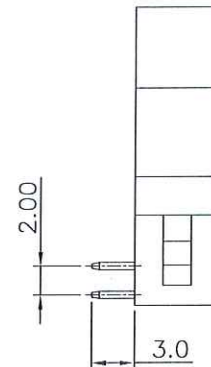
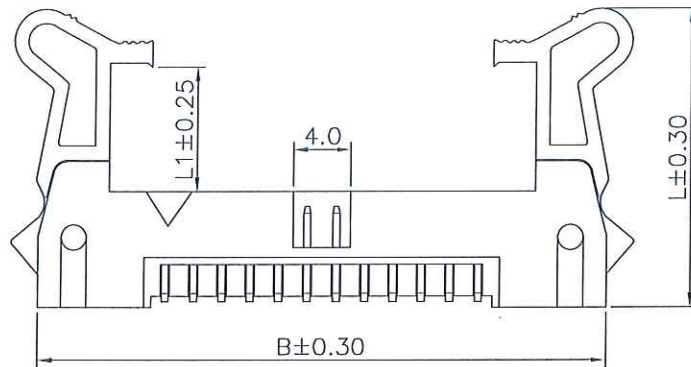
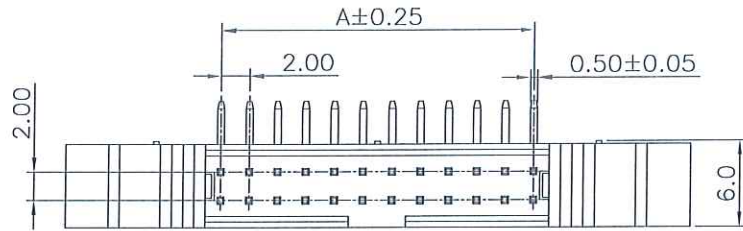

Circuit	Dimensions(mm)			Circuit	Dimensions(mm)		
	A	B	C		A	B	C
06	4.00	21.92	12.60	30	28.00	45.92	36.60
08	6.00	23.92	14.60	34	32.00	49.92	40.60
10	8.00	25.92	16.60	36	34.00	51.92	42.60
12	10.00	27.92	18.60	40	38.00	55.92	46.60
14	12.00	29.92	20.60	44	42.00	59.92	50.60
16	14.00	31.92	22.60	50	48.00	65.92	56.60
20	18.00	35.92	26.60	60	58.00	75.92	66.60
24	22.00	39.92	30.60	64	60.00	77.92	70.60
26	24.00	41.92	32.60				

REV.	REVISION RECORD	DATE	GENERAL TOLERANCES	SCALE:	NAME	DATE	PART.NO:	DWG.NO:
A1	NEW RELEASE	23.11.03	LINEAR 0.0±0.35	1:1	8/8/2023	23.11.03	EJ20750F9-2XX1XXX	ENDE05
			ANGLES X°REF±6°	APPROVED	黄朝明	23.11.03		
			UNIT: mm 0.00±0.25	DESIGNER	黄朝明	23.11.03	TITLE: Pitch 2.00mm 90° 双排 DIP 牛角	
			SIZE: A4 0.000±0.10	DRAWN	黄朝明	23.11.03		



REV: A1 SHEET: 1/2

The product using material and processing must conform to the "WL-PZ-001"HSF technical standard control requirements

RoHS

PIN 数	PACKING METHOD S CODE 包装方式	INNER PACKING SIZE (mm) 包材规格			INNER PACKING QTY(PC S) 数量	CARTON NO. (mm) 外箱规格			KPCS / CARTON 数量
		L / (D)	W	H / (L)		L	W	H	
10	C	450	265	23	264	475	285	335	3.96
12	C	450	265	23	240	475	285	335	3.6
14	C	450	265	23	240	475	285	335	3.6
16	C	450	265	23	216	475	285	335	3.24
18	C	450	265	23	192	475	285	335	2.88
20	C	450	265	23	192	475	285	335	2.88
24	C	450	265	23	192	475	285	335	2.88
26	C	450	265	23	168	475	285	335	2.52
30	C	450	265	23	168	475	285	335	2.52
34	C	450	265	23	144	475	285	335	2.16
36	C	450	265	23	144	475	285	335	2.16
44	C	450	265	23	120	475	285	335	1.8
50	C	450	265	23	120	475	285	335	1.8
60	C	450	265	23	96	475	285	335	1.44



包装物料示意图



◆包装方式

- ◇ A=1→9
- ◇ B=3→9
- ◇ C=4→9
- ◇ D=5→2→9
- ◇ E=6→7→9
- ◇ F=1→8→9
- ◇ G=3→1→9

备注：每箱装15层

REV.	REVISION RECORD	DATE		GENERAL TOLERANCES		SCALE: 1:1	NAME	DATE	PART.NO:	DWG.NO:	 WanLian Technology Co., Ltd
A0	NEW RELEASE	23.11.03		LINEAR	ANGLES	APPROVED	<i>[Signature]</i>	23.11.03	EJ20750F9-2XX1XXX	ENDE05	
				0.0±0.35	X'REF±6'	DESIGNER	<i>[Signature]</i>	23.11.03	TITLE:		
				UNIT: mm	0.00±0.25	X'±3'	DRAWN	<i>[Signature]</i>	23.11.03	包装规范	
			SIZE: A4	0.000±0.10	X'X' ±2'						