

The product using material and processing must conform to the "WI-PZ-001"HSF technical standard control requirements

RoHS+HF

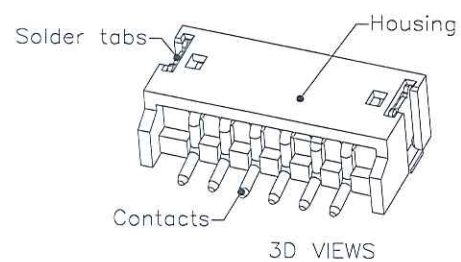

- NOTE:
- MATERIAL SPECIFICATION:
    - HOUSING: LCP,UL94V-0
    - CONTACTS:BRASS
    - SOLDER TABS:PHOSPHOR BRONZE
  - PLATING SPECIFICATION:
    - CONTACTS:SN PLATED OVER ALL.
    - SOLDER TABS:SN PLATED OVER ALL.
  - ELECTRICAL PERFORMANCE:
    - CURRENT RATING: 1.0A
    - CONTACT RESISTANCE: 20mΩ Max.
    - DIELECTRIC WITHSTANDING VOLTAGE: 500V AC Min
  - ENVIRONMENTAL PERFORMANCE:
    - OPERATING TEMPERATURE: -25°C~+85°C.
  - PACKAGE SPEC:REEL
  - P/N ORDER:

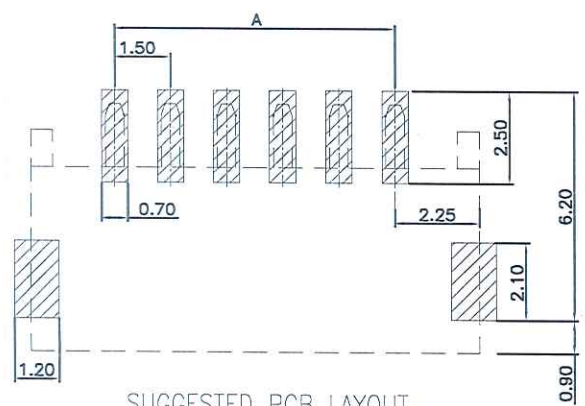
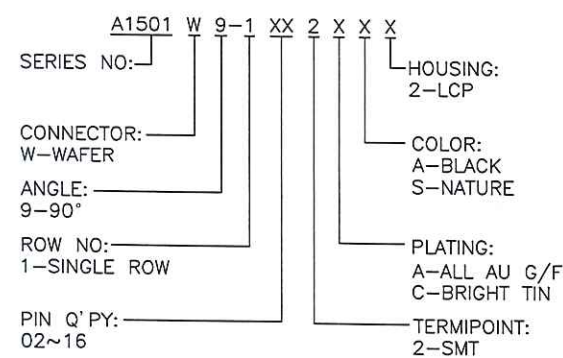
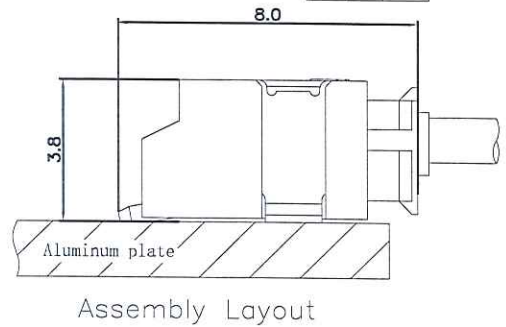
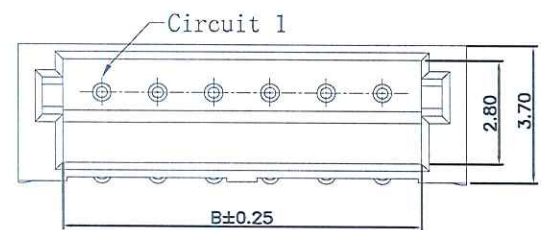
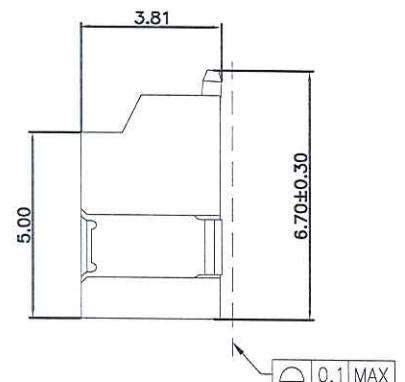
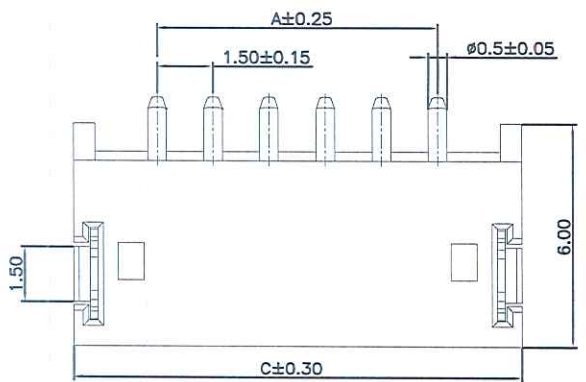

Ordering Information & Dimensions

| Circuit | Dimensions(mm) |       |       | Circuit | Dimensions(mm) |       |       |
|---------|----------------|-------|-------|---------|----------------|-------|-------|
|         | A              | B     | C     |         | A              | B     | C     |
| 02      | ---            | 3.60  | 6.00  | 10      | 13.50          | 15.60 | 18.00 |
| 03      | 3.00           | 5.10  | 7.50  | 11      | 15.00          | 17.10 | 19.50 |
| 04      | 4.50           | 6.60  | 9.00  | 12      | 16.50          | 18.60 | 21.00 |
| 05      | 6.00           | 8.10  | 10.50 | 13      | 18.00          | 20.10 | 22.50 |
| 06      | 7.50           | 9.60  | 12.00 | 14      | 19.50          | 21.60 | 24.00 |
| 07      | 9.00           | 11.10 | 13.50 | 15      | 21.00          | 23.10 | 25.50 |
| 08      | 10.50          | 12.60 | 15.00 | 16      | 22.50          | 24.60 | 27.00 |
| 09      | 12.00          | 14.10 | 16.50 |         |                |       |       |

| REV. | REVISION RECORD      | DATE     | UNIT:mm<br>SIZE: A4 | GENERAL TOLERANCES |          | SCALE:<br>1:1 | NAME    | DATE | PART.NO:                     | DWG.NO: | <br>WanLian Technology Co., Ltd |            |
|------|----------------------|----------|---------------------|--------------------|----------|---------------|---------|------|------------------------------|---------|---------------------------------|------------|
| A0   | NEW RELEASE          | 21.01.13 |                     | LINEAR             | ANGLES   | APPROVED      |         |      | A1501W9-1XX2XXX              | ENDE05  |                                 |            |
| A1   | PART NUMBER RENEWAL  | 23.09.19 | 0.00±0.25           | X°±3°              | DESIGNER | 李忠荣           | 25.8.26 |      |                              |         |                                 |            |
| A1   | REPLACE THE NEW MOLD | 25.08.26 | 0.000±0.10          | X'X'±2°            | DRAWN    | 黄晓龙           | 25.8.26 |      |                              |         |                                 |            |
|      |                      |          |                     |                    |          |               |         |      | TITLE:                       |         | REV: A2                         | SHEET: 1/2 |
|      |                      |          |                     |                    |          |               |         |      | Pitch1.50mm 90°ZII单排卧贴 Wafer |         |                                 |            |

The product using material and processing must conform to the "WI-PZ-001"HSF technical standard control requirements

RoHS+HF

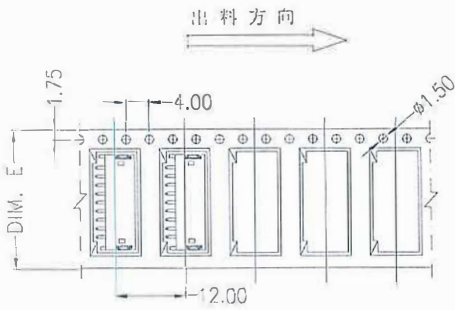

02~09 CONTACTS

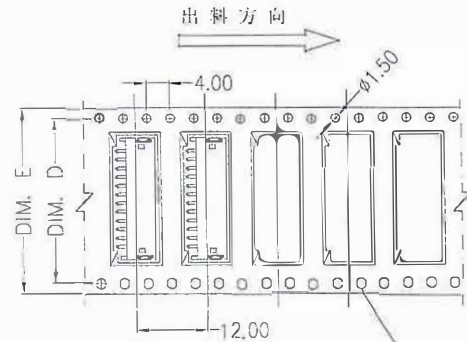

10~14 CONTACTS

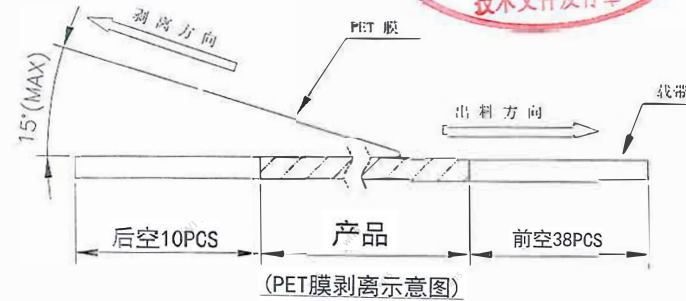

(PET膜剥离示意图)

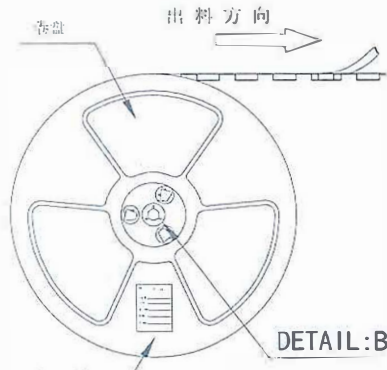

DETAIL:B

标签

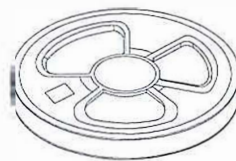
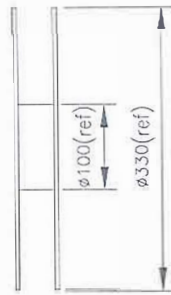

装\*盘 (参考列表-)

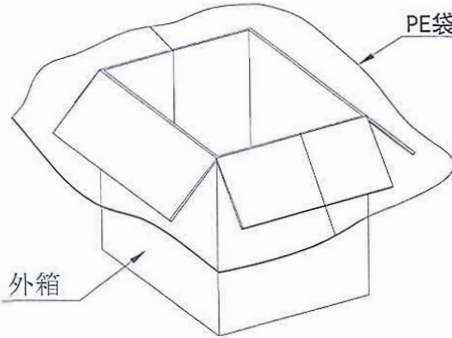

PE袋

外箱

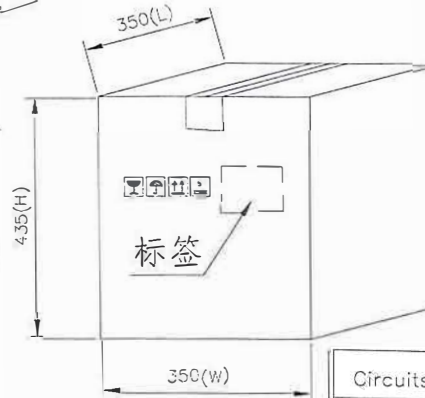

标签

包装说明:

1. 把成品包入卷盘中, 每盘装1000PCS. 卷盘上贴上标签, 将装好产品的卷盘放进外箱中, 外箱内先套一个大PE袋, 外箱上贴贴上合标签
2. 所有材料有害物控制需符合ROHS标准:

| Circuits | DIM. D | DIM. E | Q'ty/Reel | Packing (Reel/Caton) |
|----------|--------|--------|-----------|----------------------|
| 02-03PIN | -      | 16     | 1000PCS   | 20/Reel              |
| 04-09PIN | -      | 24     | 1000PCS   | 15/Reel              |
| 10-12PIN | 28.4   | 32     | 1000PCS   | 11/Reel              |
| 13-14PIN | 40.4   | 44     | 1000PCS   | 8/Reel               |

| REV. | REVISION RECORD      | DATE     | GENERAL TOLERANCES | SCALE: 1:1 | NAME | DATE     | PART.NO:              | DWG.NO: |
|------|----------------------|----------|--------------------|------------|------|----------|-----------------------|---------|
| A0   | NEW RELEASE          |          | LINEAR             | APPROVED   | 张永涛  | 25.8.26  | A1501W9-1XX2XXX       | ENDE05  |
| A1   | PART NUMBER RENEWAL  | 23.09.19 | 0.0±0.35           | DESIGNER   | 张永涛  | 25.8.26  |                       |         |
| A2   | REPLACE THE NEW MOLD | 25.08.26 | 0.00±0.25          | DRAWN      | 黄碧茵  | 25.08.26 |                       |         |
|      |                      |          | 0.000±0.10         |            |      |          | TITLE: pckage drawing |         |



REV: A2 SHEET: 2/2