

The product using material and processing must conform to the "WI-PZ-001"HSF technical standard control requirements

RoHS+HF

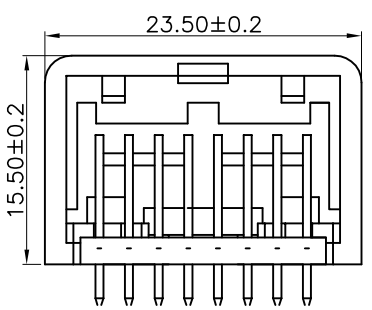
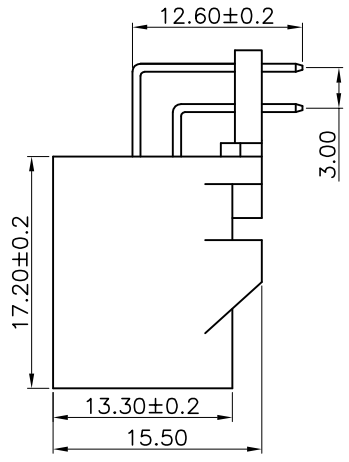
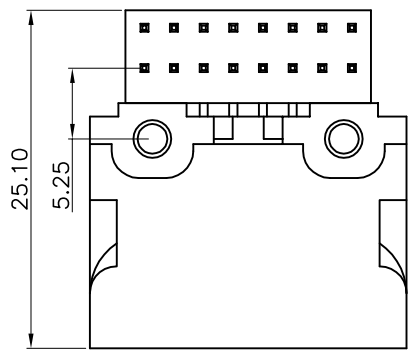
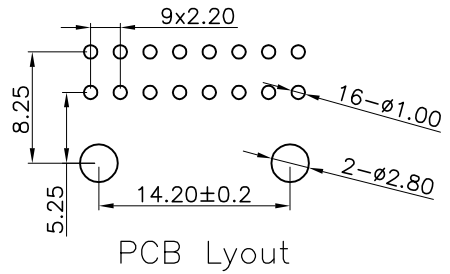
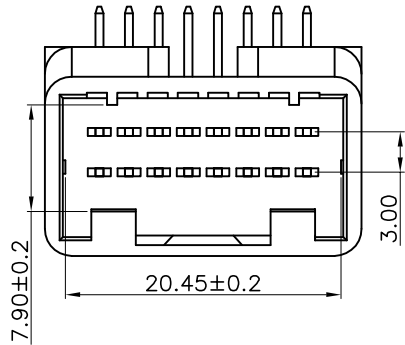

NOTE:  
 1.MATERIAL SPECIFICATION:  
 1-1.HOUSING:PA66,UL94V-0  
 1-2.CONTACTS:BRASS H62  
 2.PLATING SPECIFICATION:  
 2-1.CONTACTS:TIN PLATED ON CONTACT AREA.  
 3.MECHANICAL PERFORMANCE:  
 3-1.INSERTION FORCE: 1KGF/PIN MAX  
 3-2.REMOVAL FORCE: 3KGF/PIN MIN  
 3-3.DURABILITY: 50 CYCLES.  
 4.ELECTRICAL PERFORMANCE:  
 4-1. RATED CURRENT : 10A  
 RATED VOLTAGE : 250V  
 4-2.INSULATION RESISTANCE: 1000MΩ MIN  
 CONTACT RESISTANCE : 30mΩ MAX  
 4-3.WITHSTANDING VOLTAGE:1500V AC  
 5.ENVIRONMENTAL PERFORMANCE:  
 OPERATING TEMPERATURE: -40°C~+90°C.  
 6.PACKAGE SPEC:TRAY  
 7.P/N:

A2201 W 9-2 16 1 X X 0  
 SERIES NO: \_\_\_\_\_ COLOR: K-WHITE  
 CONNECTOR: \_\_\_\_\_ W-WAFER PLATING: C-BRIGHE TIN  
 ANGLE: \_\_\_\_\_ 9-90°  
 ROW NO: \_\_\_\_\_ 2-DOUBLE ROW  
 PIN Q'PY: \_\_\_\_\_ 02~40 TERMPOINT: 1-DIP

REV.	REVISION RECORD	DATE		GENERAL TOLERANCES		SCALE: 1:1	NAME	DATE	PART.NO:	DWG.NO:	
A0	NEW RELEASE	21.01.13		LINEAR	ANGLES	APPROVED	Wang_jr	23.10.08	A2201W9-2161XX0	ENDE05	
A1	PART NUMBER RENEWAL	23.10.08	UNIT:mm	X'±3'	DESIGNER	Han_Gao	23.10.08	TITLE: PITCH 2.20mm 90° 卧插带扣 汽车连接器		REV: A1	SHEET: 1/1
			SIZE: A4	X'X' ±2'	DRAWN	Zijun_Huang	23.10.08				